

NY.6-7

Health and Safety Research Division

RESULTS FROM A RADIOLOGICAL SURVEY ON YARDBORO AVENUE,
ALBANY, AND CENTRAL AVENUE, COLONIE, NEW YORK
PROPERTIES AL013 - AL028

July 1984

Work performed as part of the
RADIOLOGICAL SURVEY ACTIVITIES PROGRAM

OAK RIDGE NATIONAL LABORATORY
Oak Ridge, Tennessee 37831
operated by
MARTIN MARIETTA ENERGY SYSTEMS, INC.
for the
U.S. DEPARTMENT OF ENERGY
under Contract No. DE-AC05-84OR21400

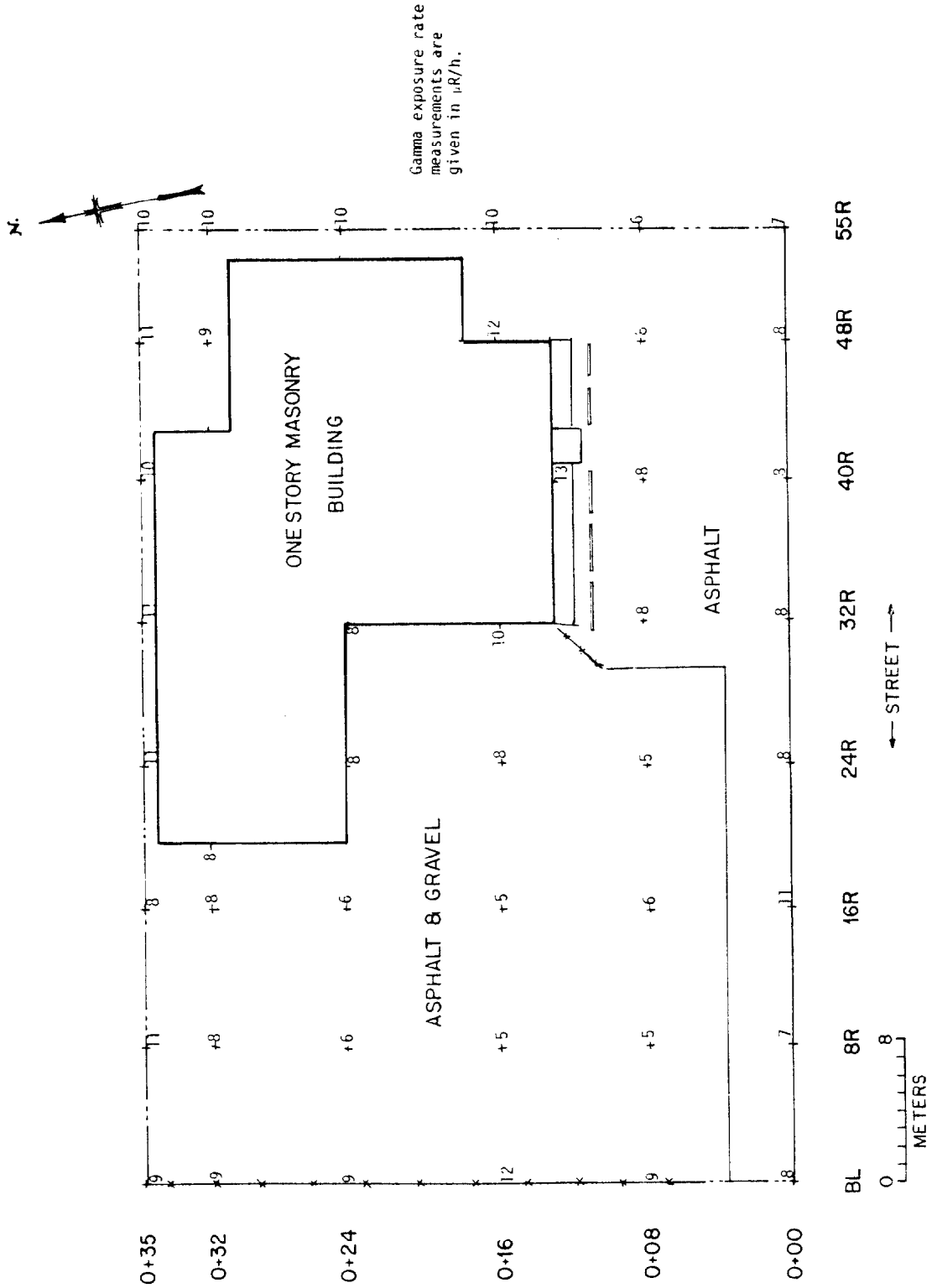

Fig. 1. Gamma exposure rates measured at the surface at grid points at 50 Yardboro Avenue, Albany, New York (AL013).

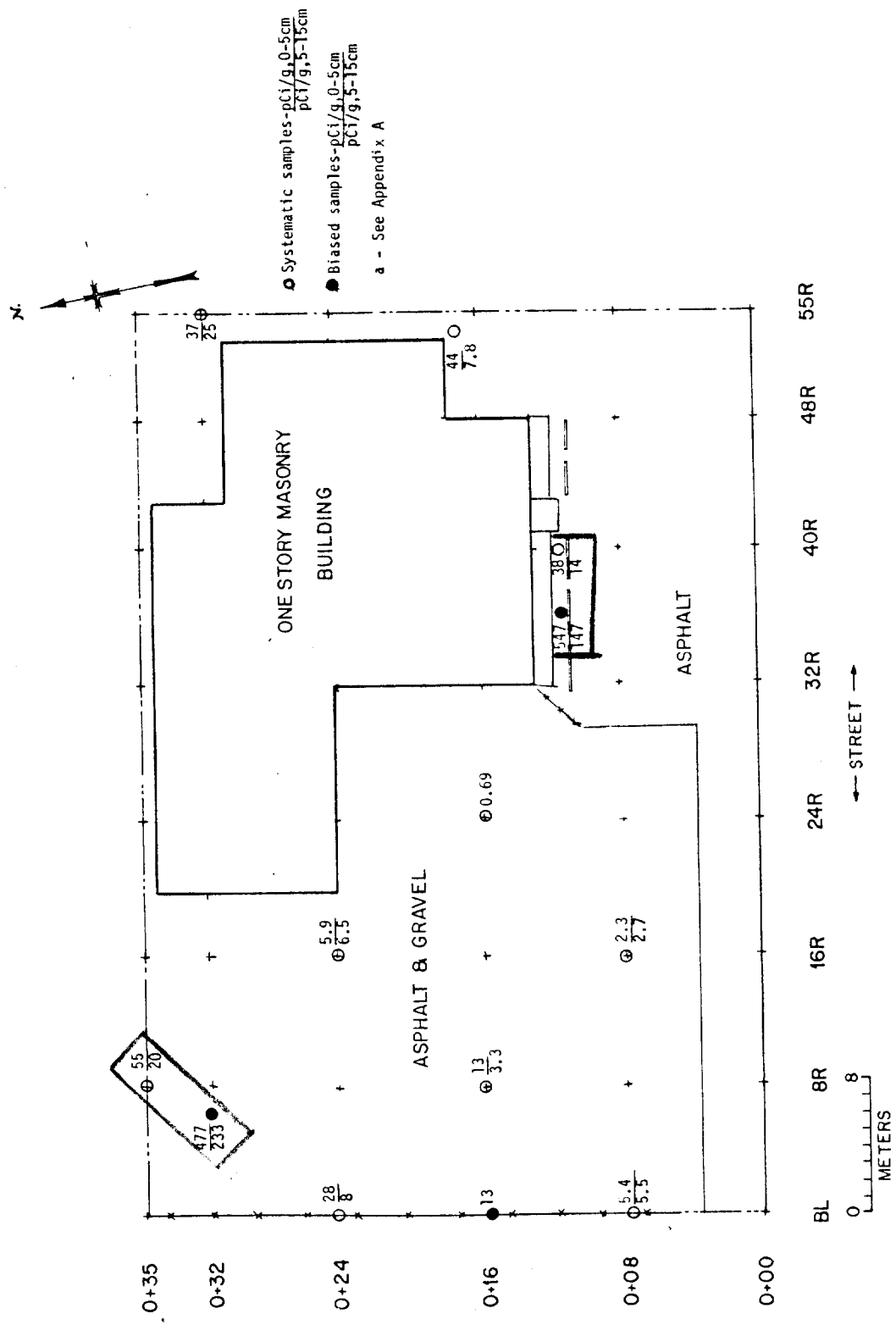

Fig. 2. Concentrations of uranium-238 in soil samples at 50 Yardboro Avenue, Albany, New York (AL013).

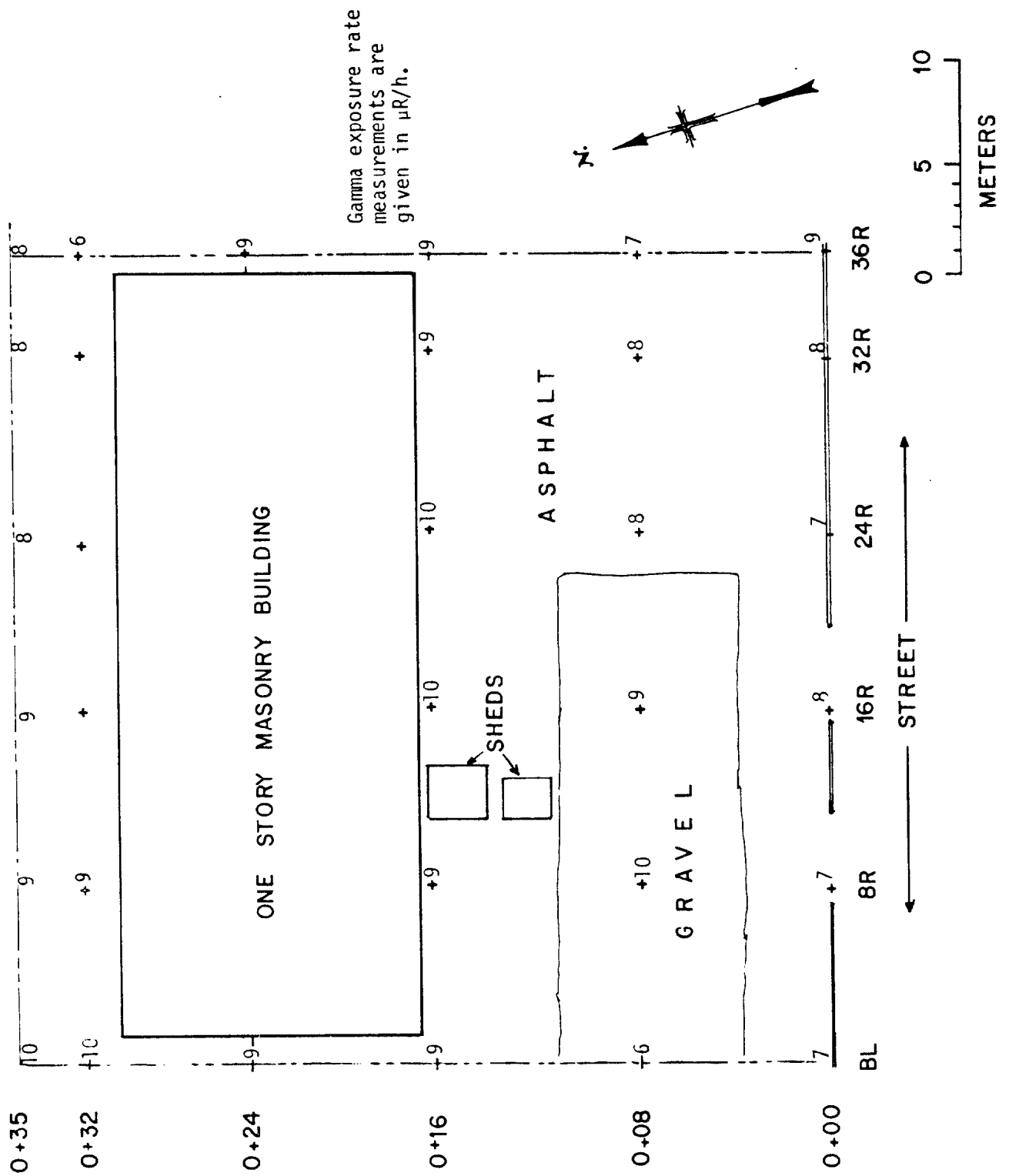

Fig. 3. Gamma exposure rates measured at the surface at grid points at 38 Yardboro Avenue, Albany, New York (AL014).

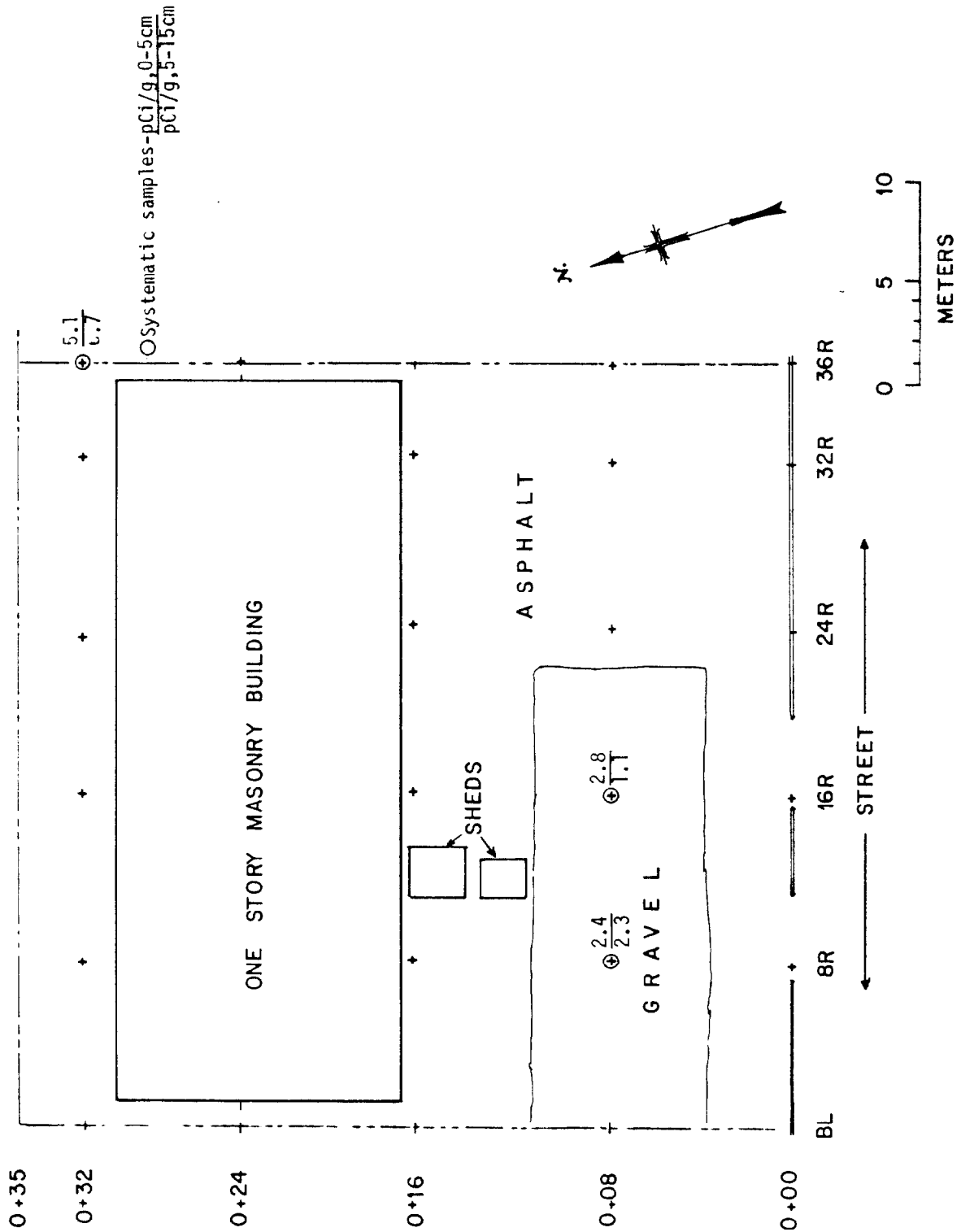

Fig. 4. Concentrations of uranium-238 in soil samples at 38 Yardboro Avenue, Albany, New York (AL014).

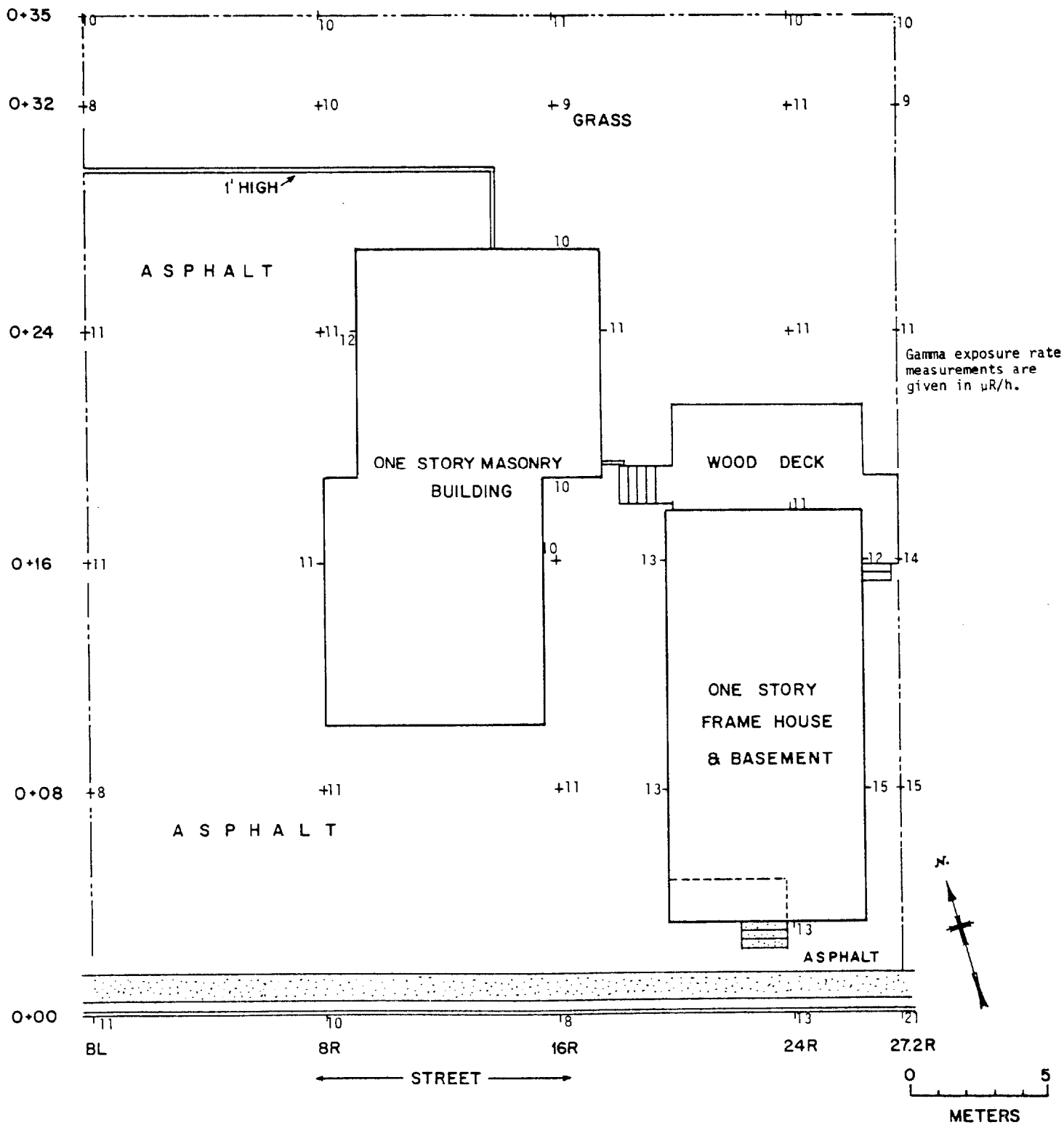

Fig. 5. Gamma exposure rates measured at the surface at grid points at 26 Yardboro Avenue, Albany, New York (AL015).

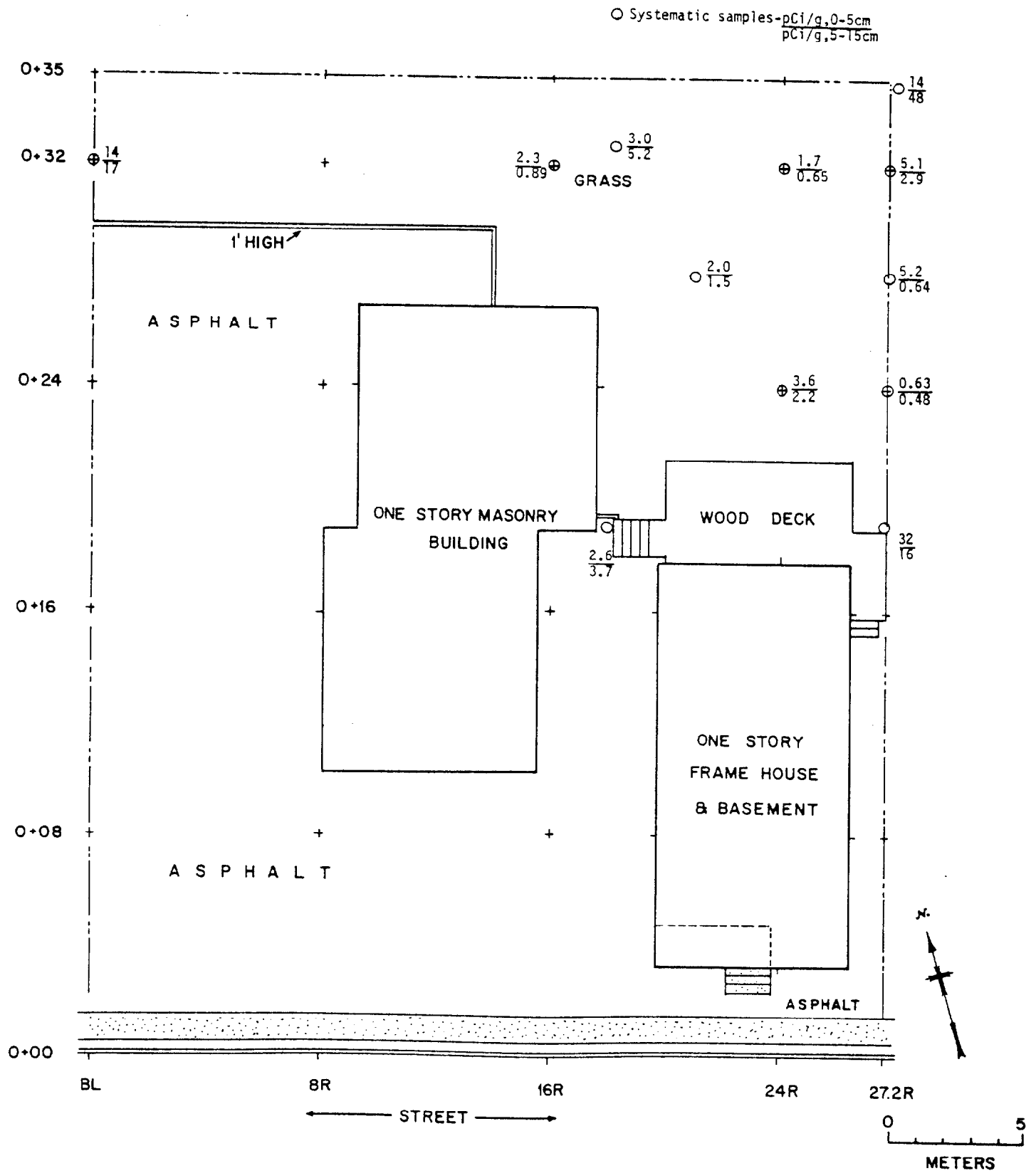

Fig. 6. Concentrations of uranium-238 in soil samples at 26 Yardboro Avenue, Albany, New York (AL015).

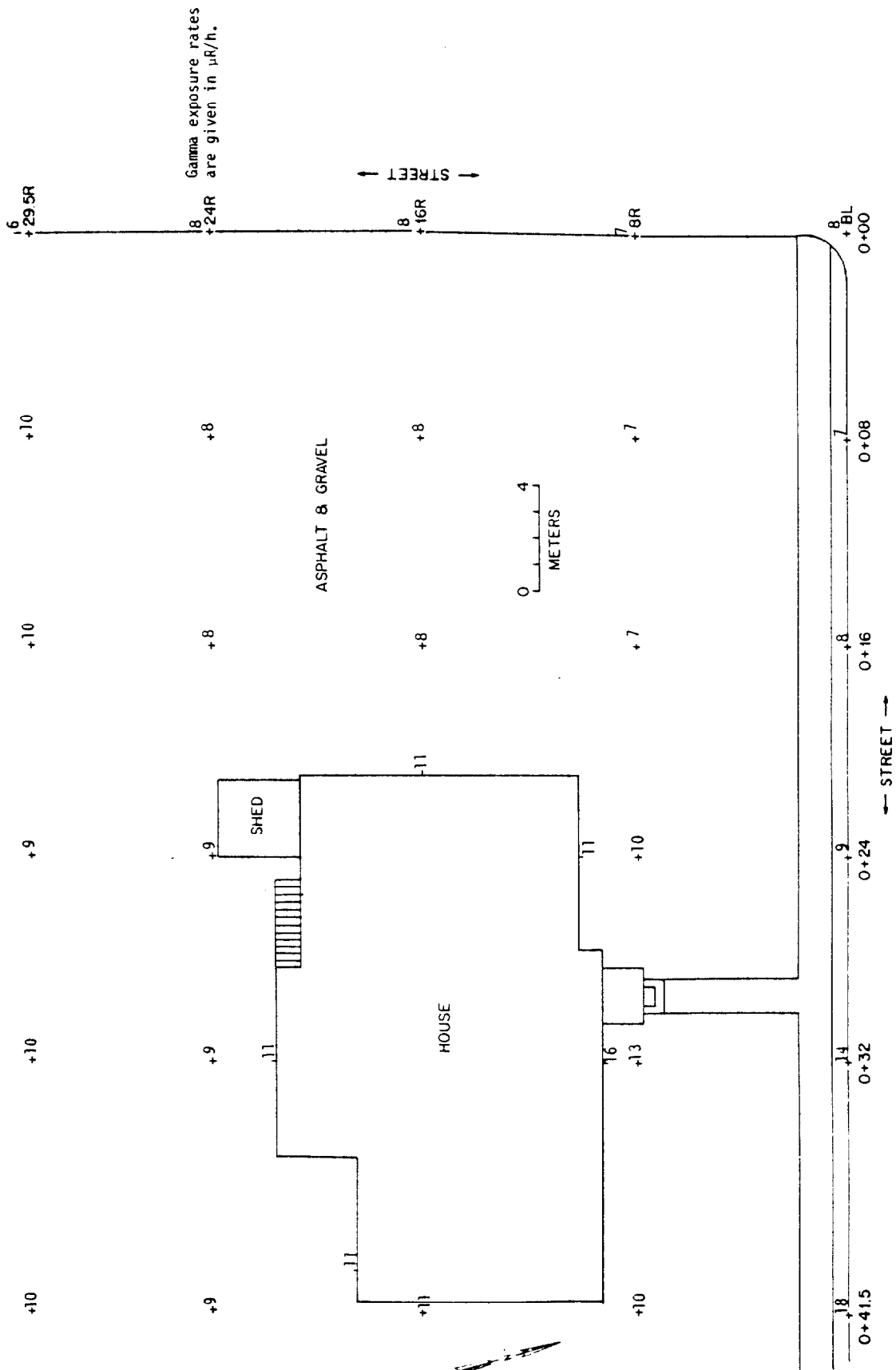

Fig. 7. Gamma exposure rates measured at the surface at grid points at 25/27 Yardboro Avenue, Albany, New York (AL016).

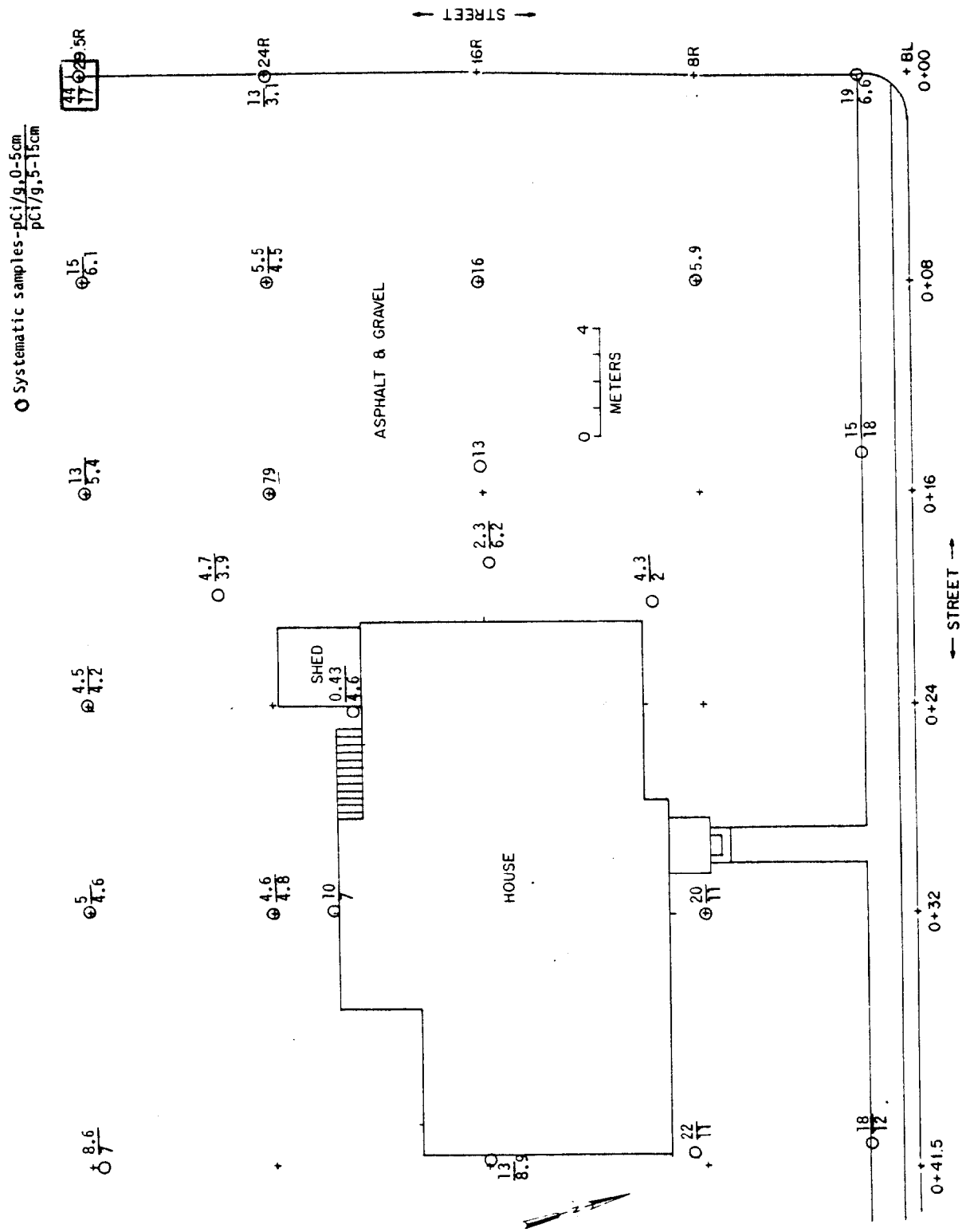

Fig. 8. Concentrations of uranium-238 in soil samples at 25/27 Yardboro Avenue, Albany, New York (AL016).

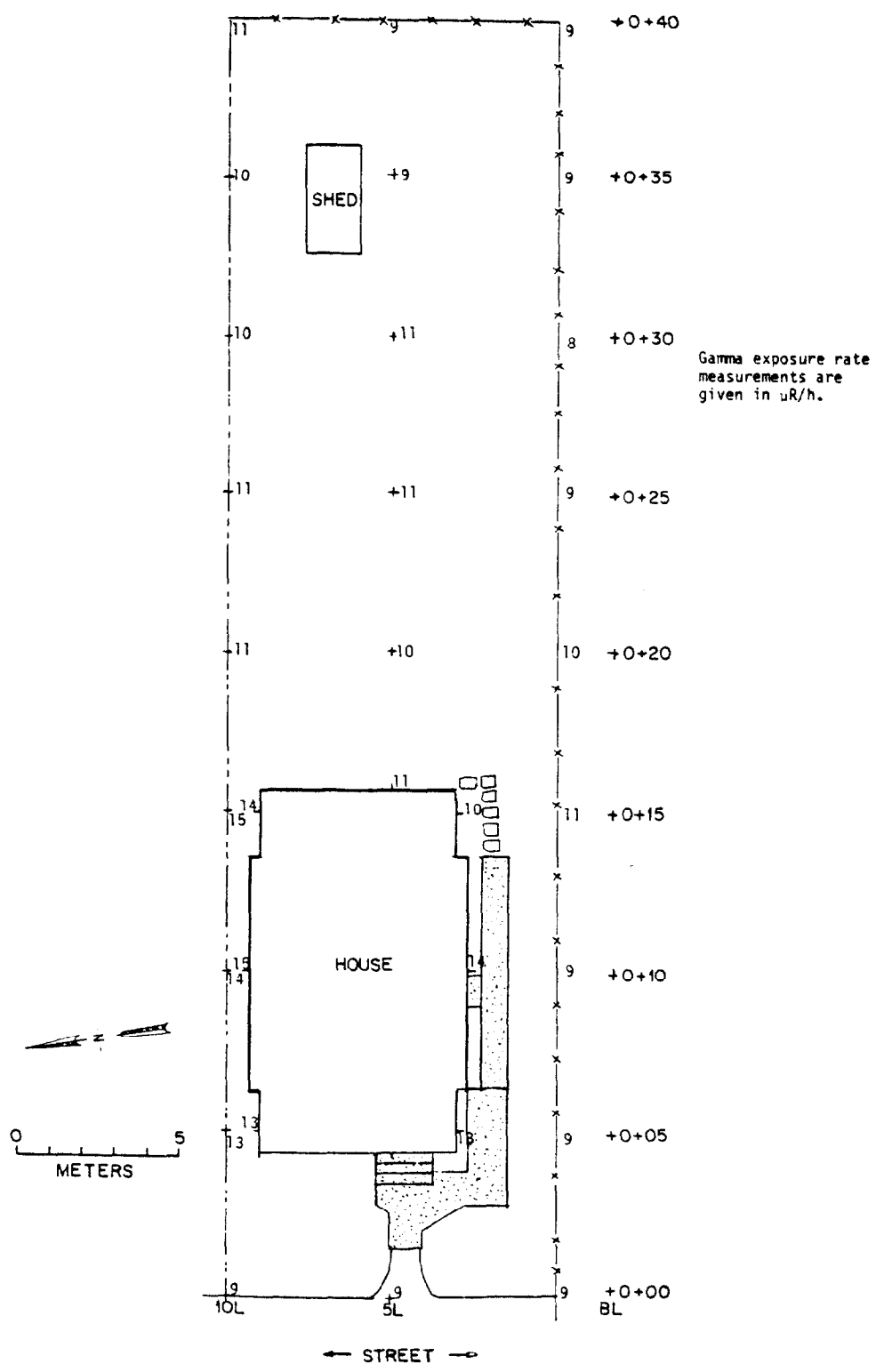

Fig. 9. Gamma exposure rates measured at the surface at grid points at 7 Palmer Avenue, Albany, New York (AL017).

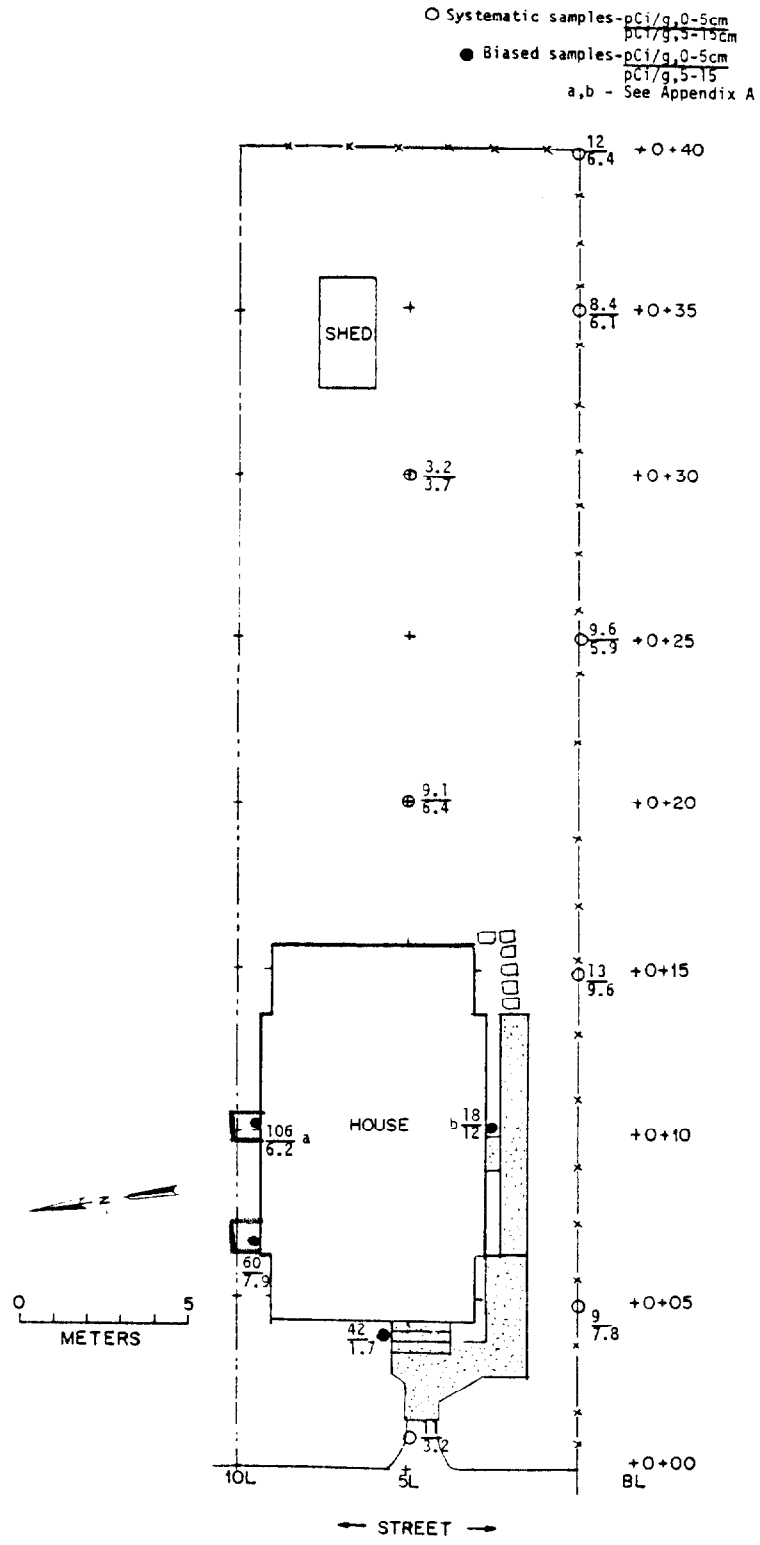

Fig. 10. Concentrations of uranium-238 in soil samples at 7 Palmer Avenue, Albany, New York (AL017).

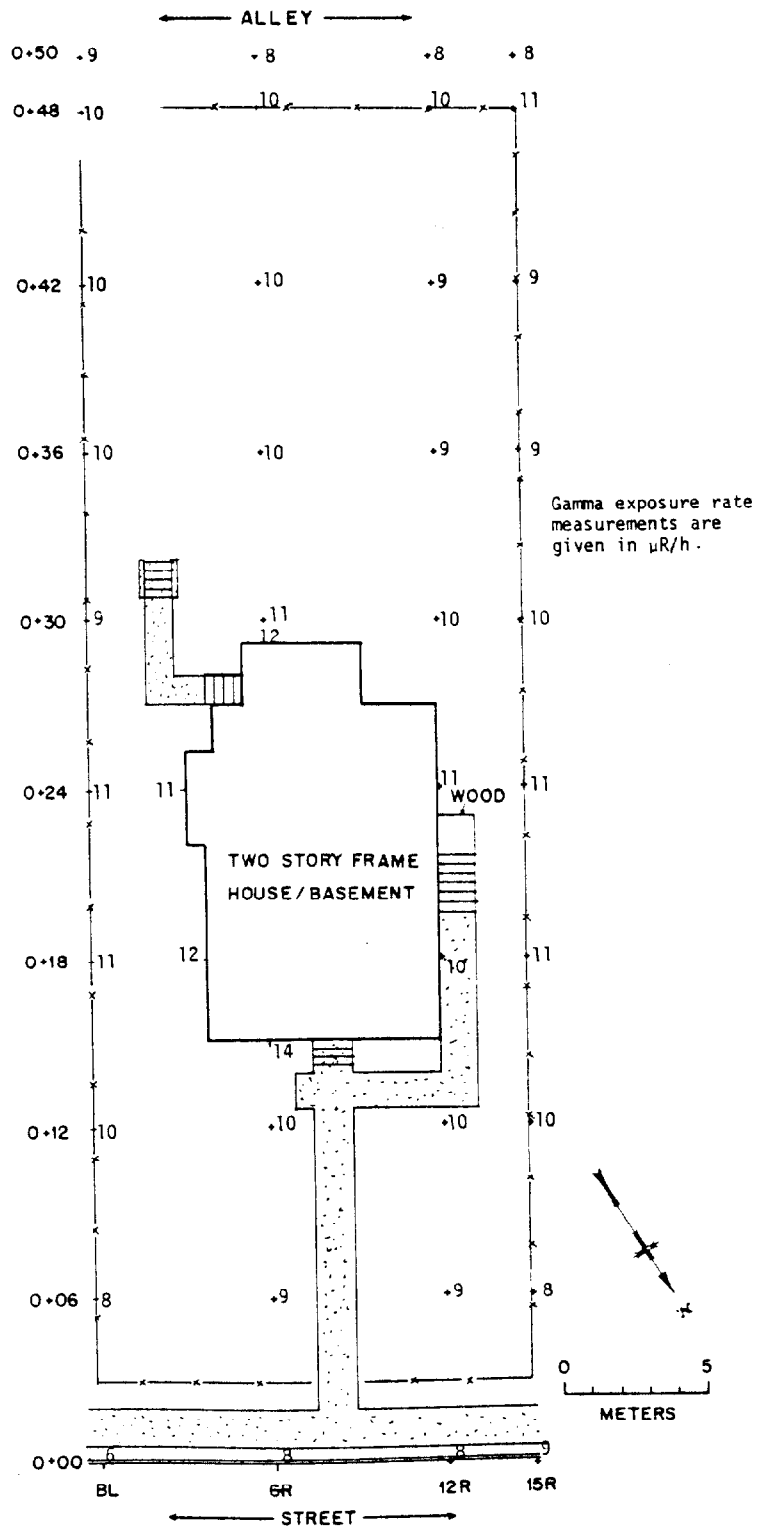

Fig. 11. Gamma exposure rates measured at the surface at grid points at 19 Yardboro Avenue, Albany, New York (AL018).

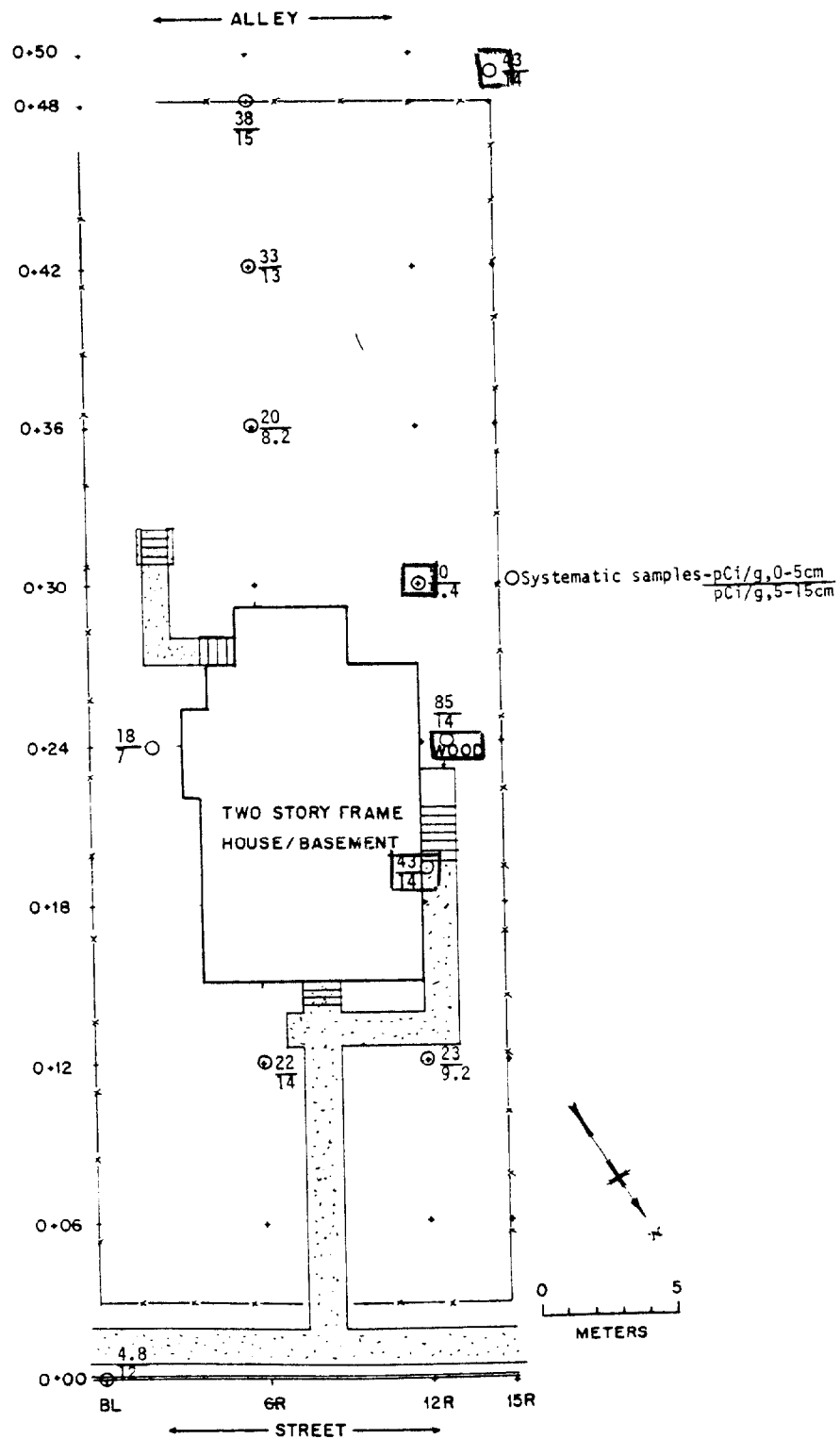

Fig. 12. Concentrations of uranium-238 in soil samples at 19 Yardboro Avenue, Albany, New York (AL018).

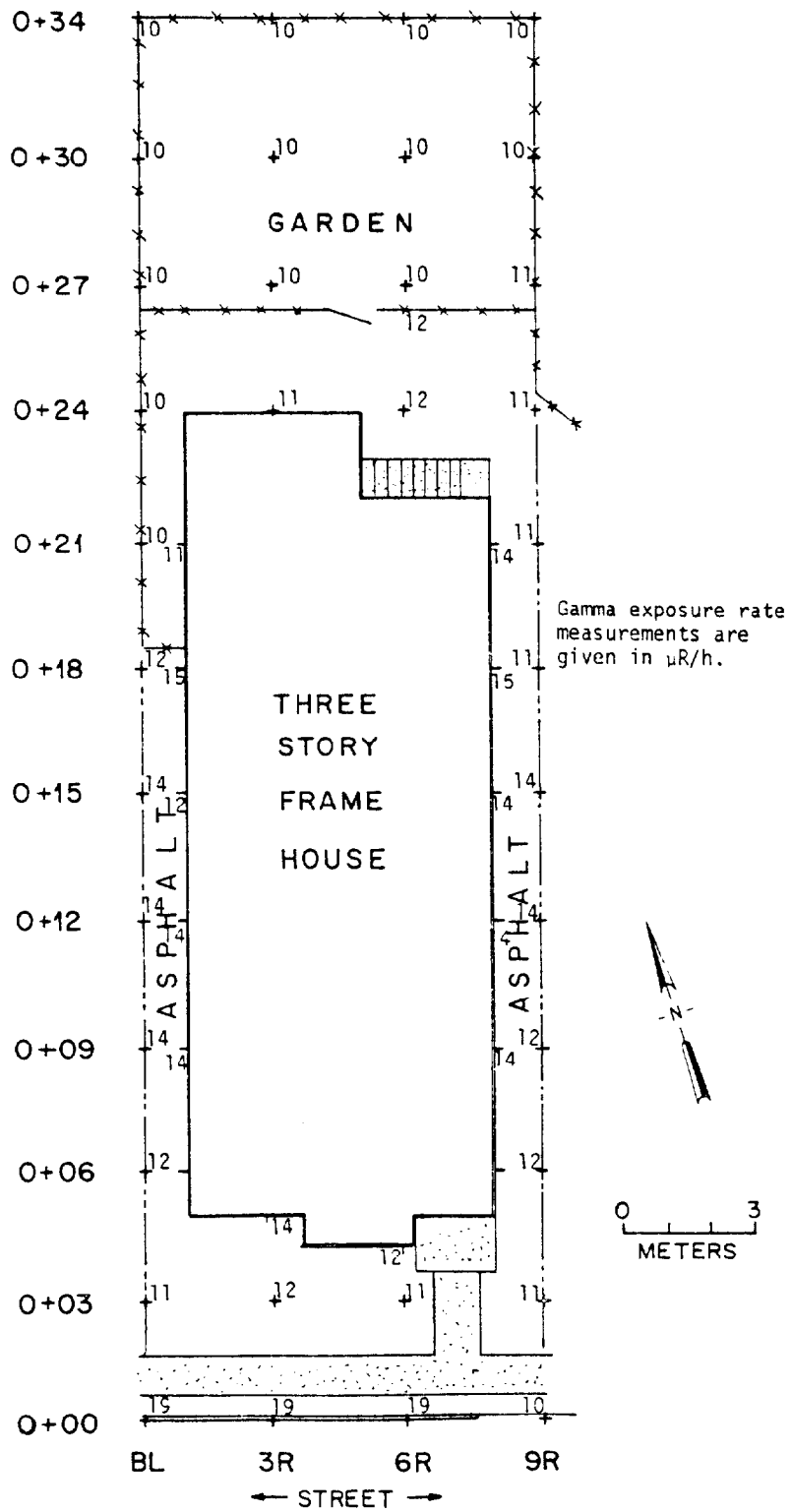

Fig. 13. Gamma exposure rates measured at the surface at grid points at 24 Yarbboro Avenue, Albany, New York (AL019).

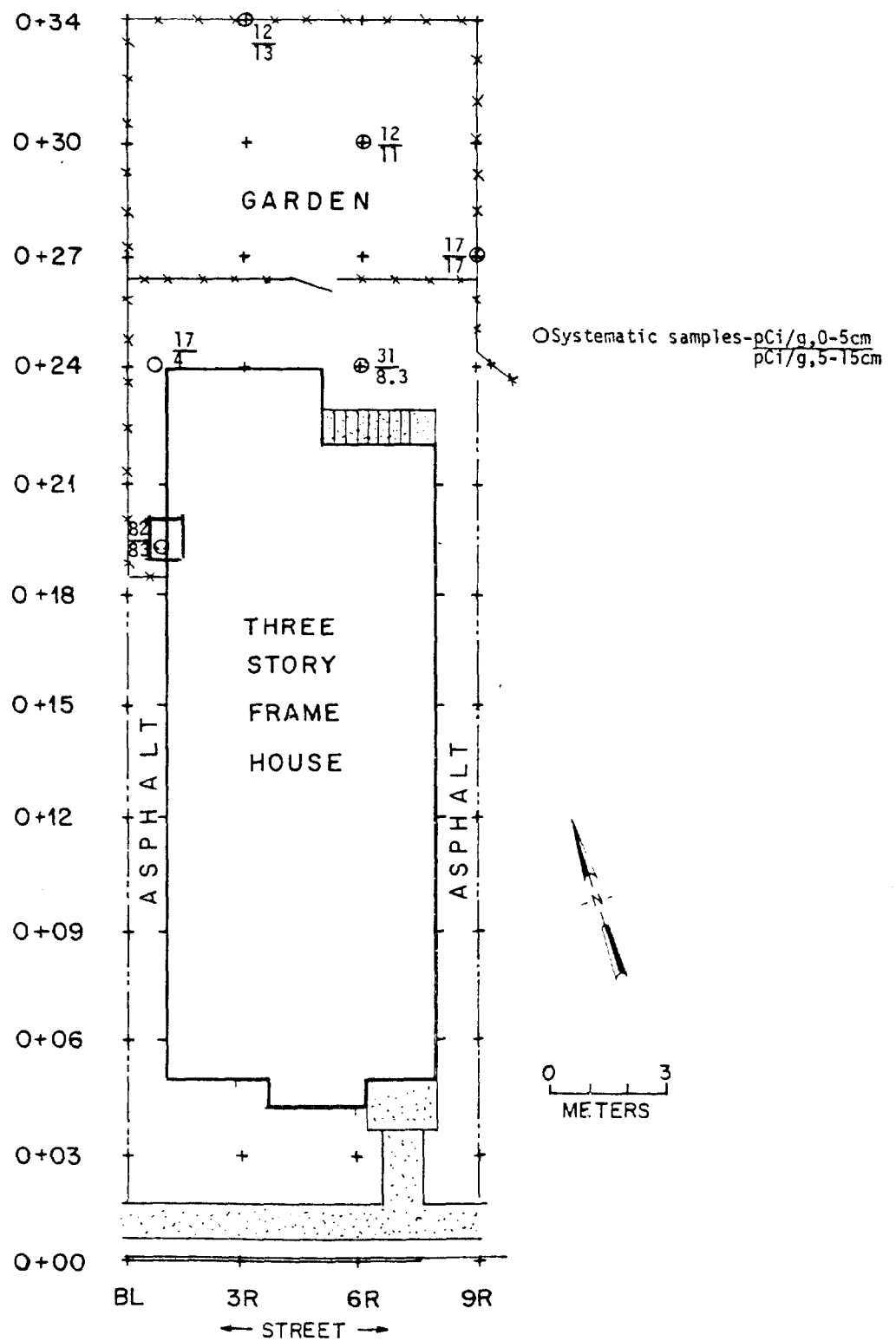

Fig. 14. Concentrations of uranium-238 in soil samples at 24 Yardboro Avenue, Albany, New York (AL019).

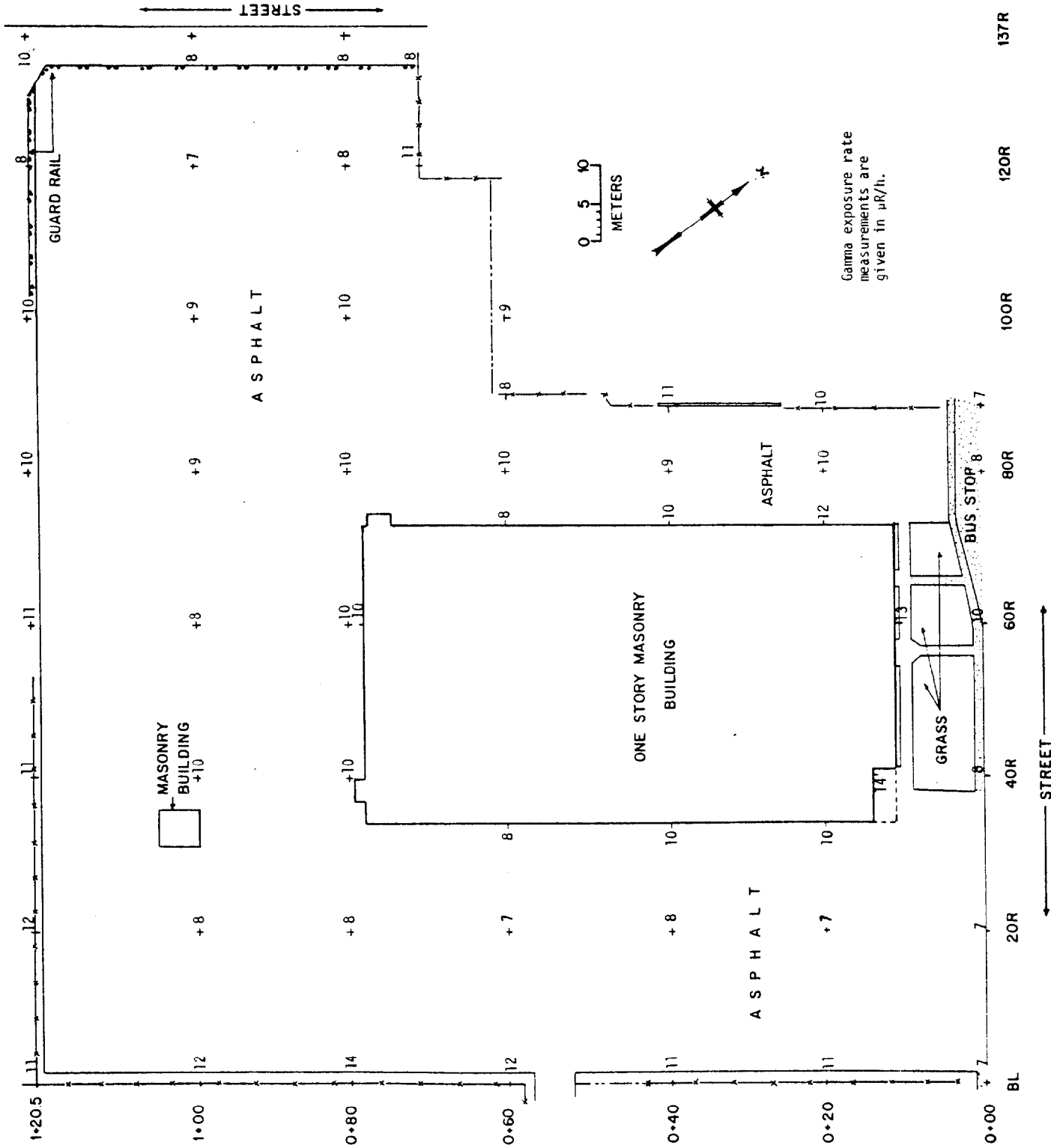

Fig. 15. Gamma exposure rates measured at the surface at grid points at 1160/1162 Central Avenue, Colonie, New York (AL020).

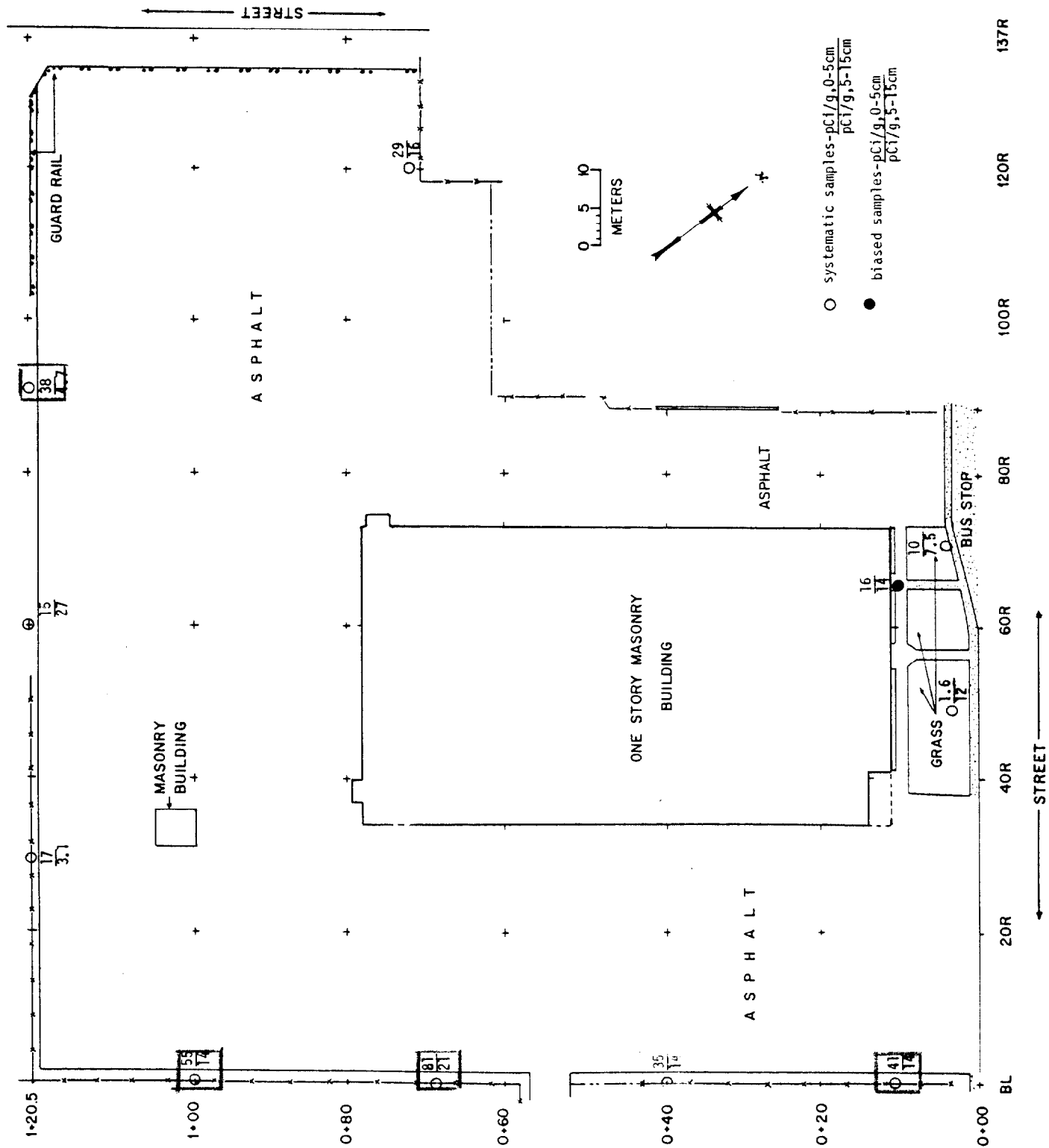

Fig. 16. Concentrations of uranium-238 in soil samples at 1160/1162 Central Avenue, Colonie, New York (AL020).

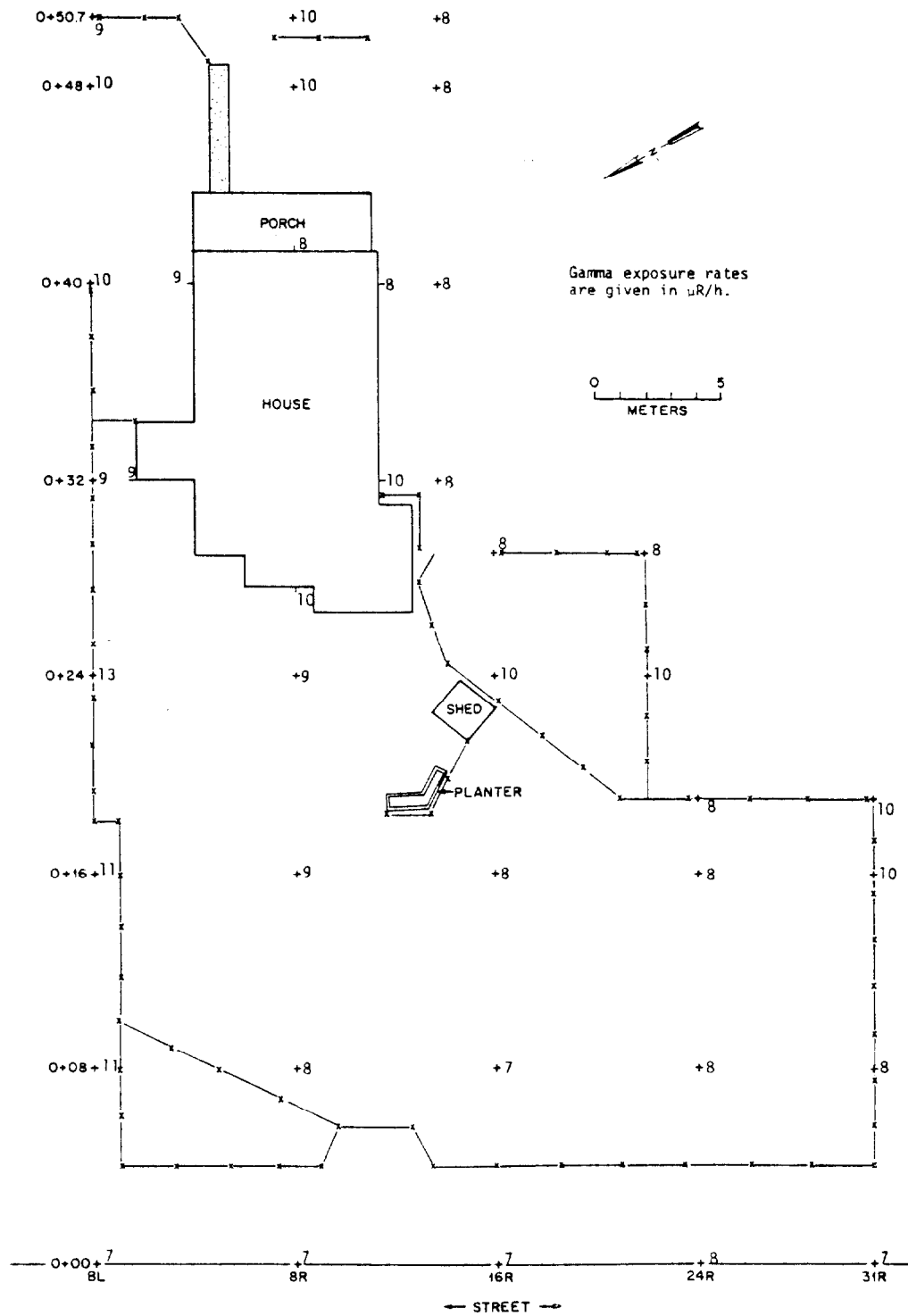

Fig. 17. Gamma exposure rates measured at the surface at grid points at 1160 Central Avenue, Colonie, New York (AL021).

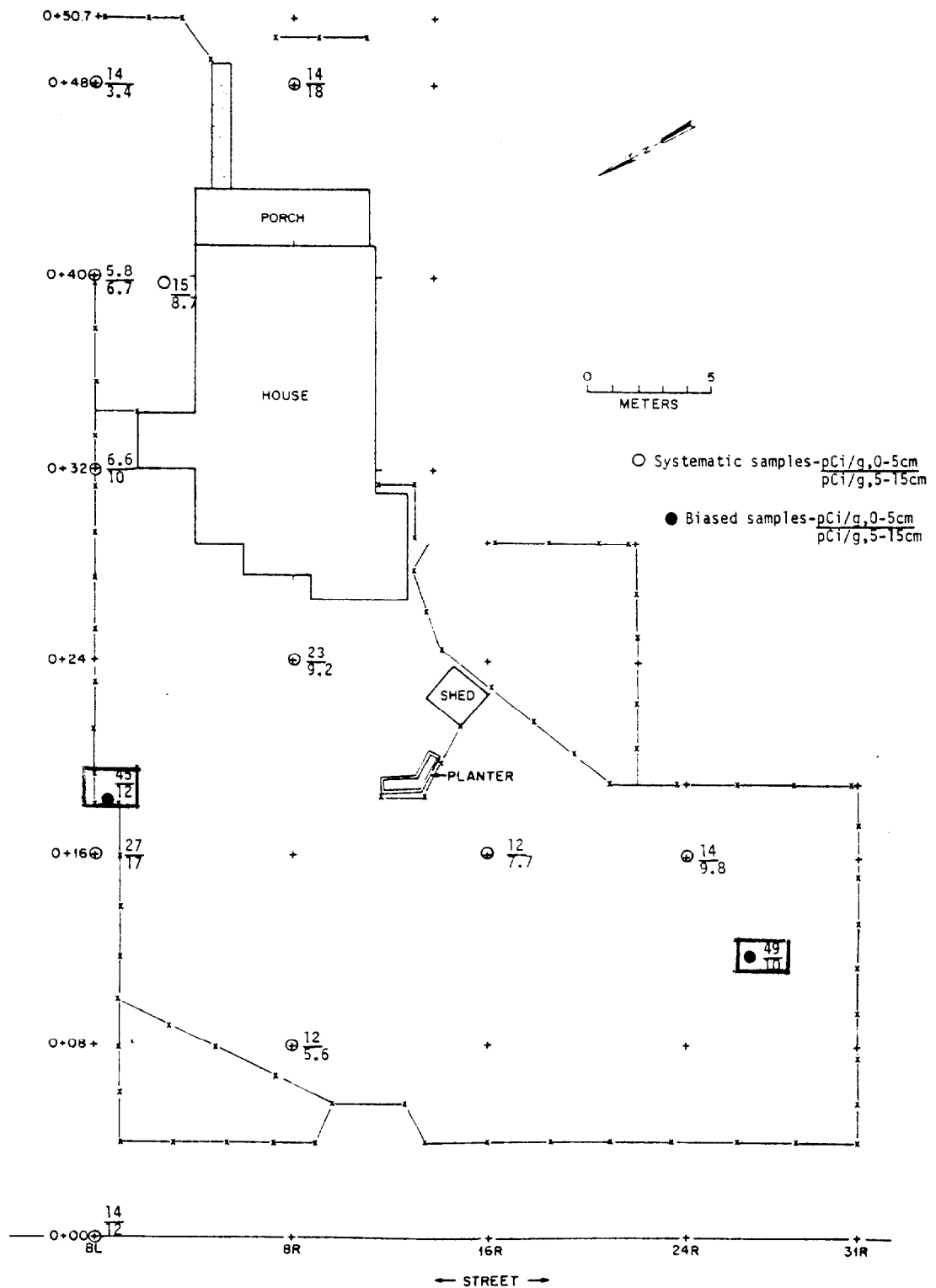

Fig. 18. Concentrations of uranium-238 in soil samples at 1160 Central Avenue, Colonie, New York (AL021).

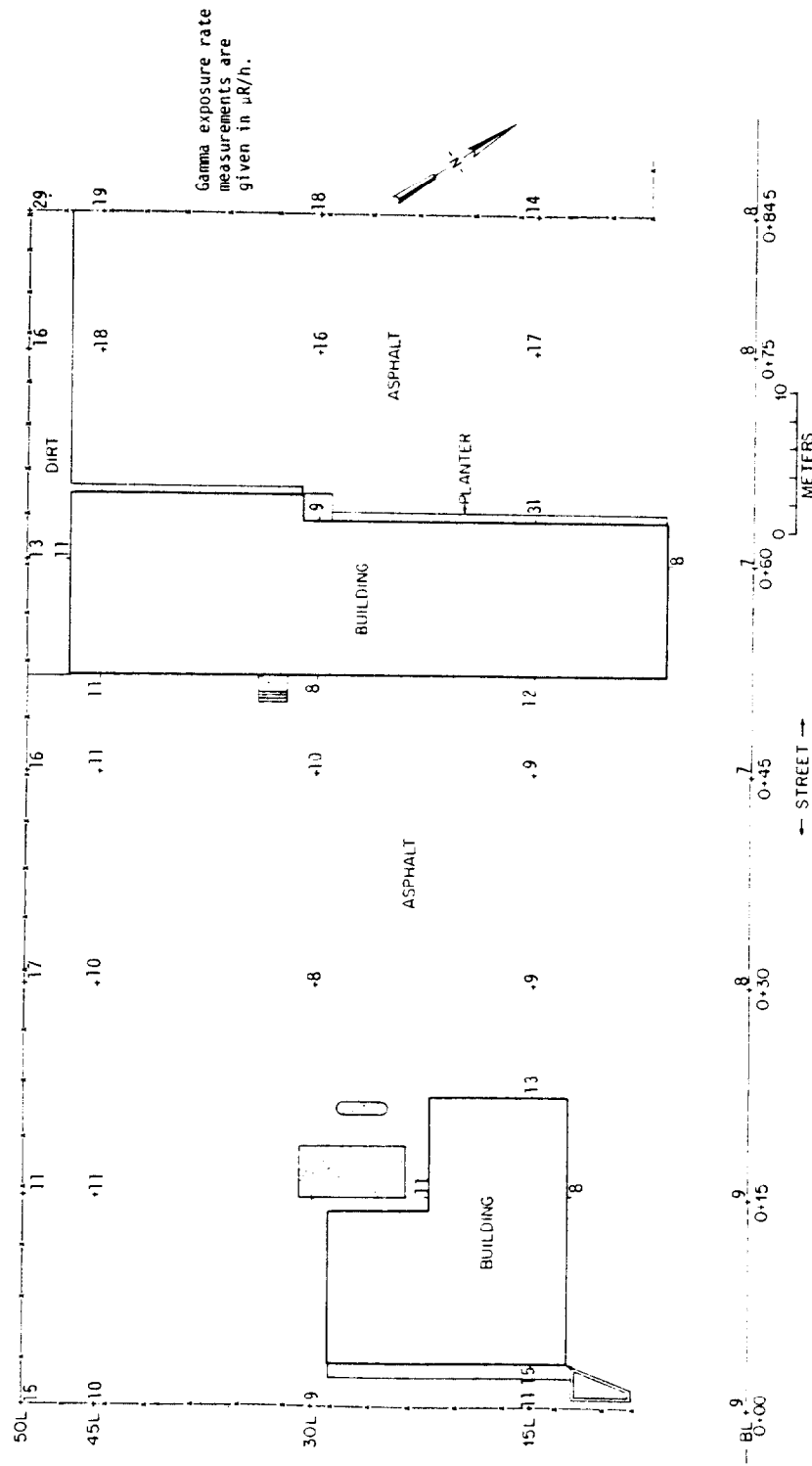

Fig. 19. Gamma exposure rates measured at the surface at grid points at 1118 Central Avenue, Colonie, New York (AL022).

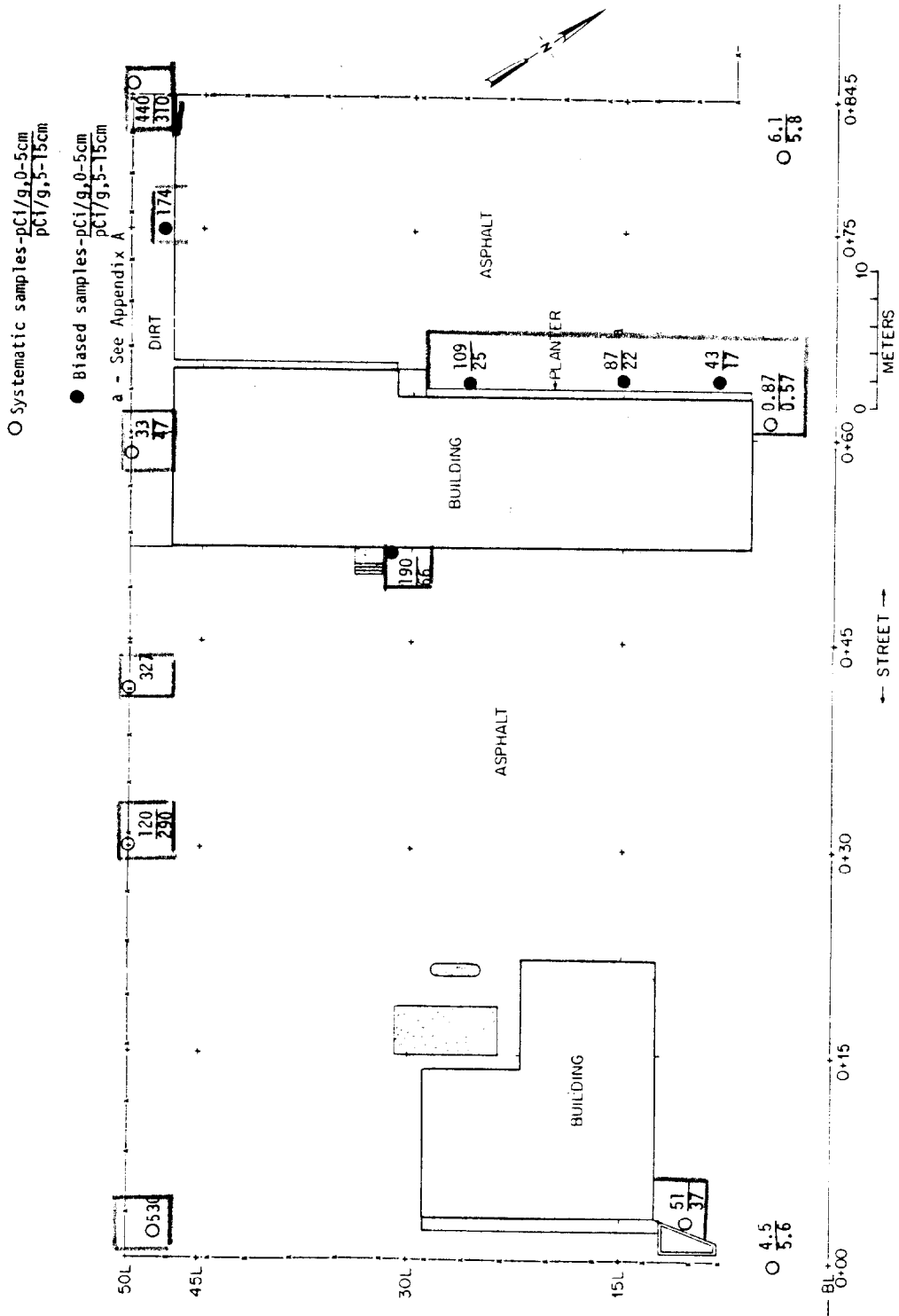

Fig. 20. Concentrations of uranium-238 in soil samples at 1118 Central Avenue, Colonie, New York (AL022).

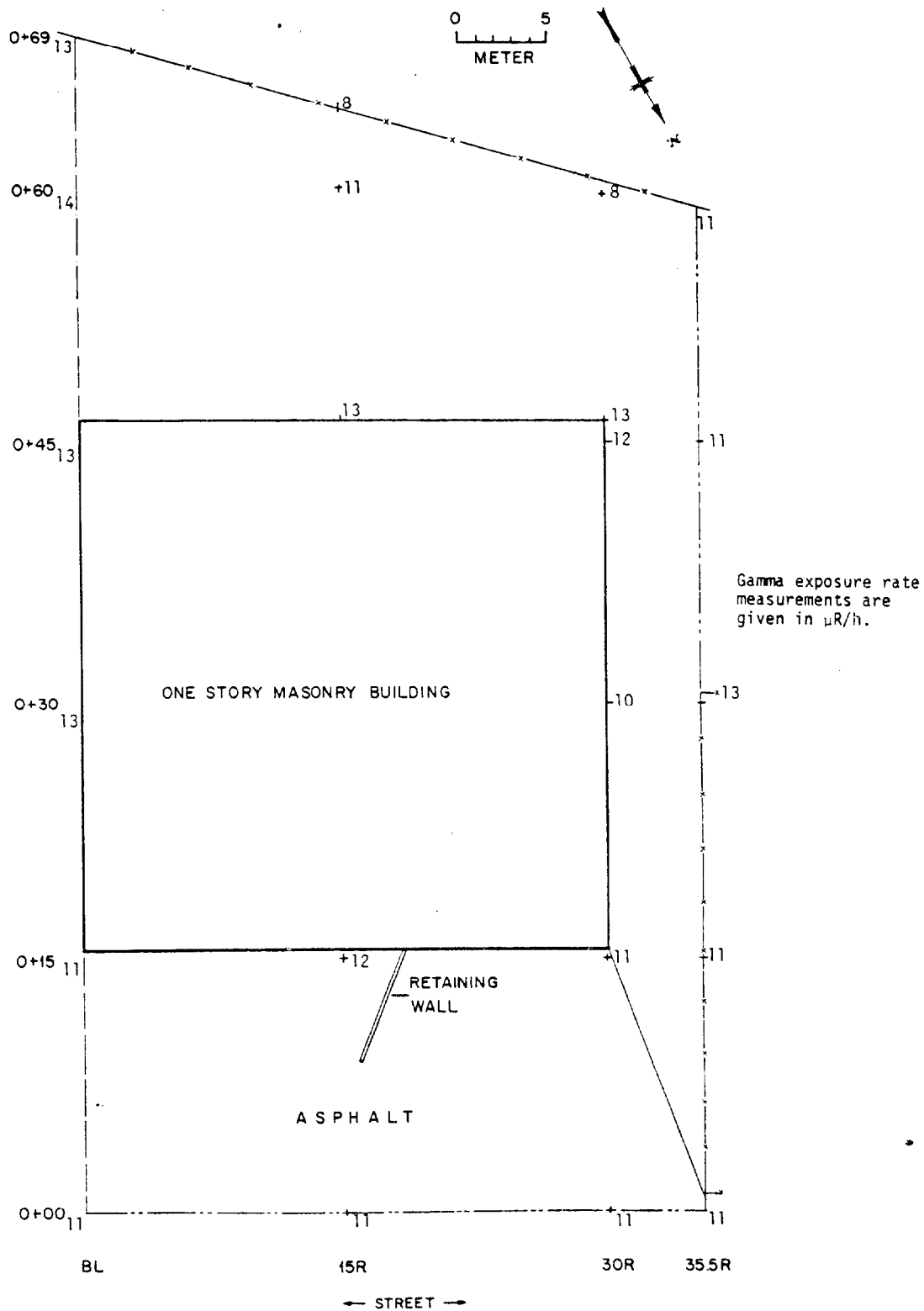

Fig. 21. Gamma exposure rates measured at the surface at grid points at 1148 Central Avenue, Colonie, New York (AL023).

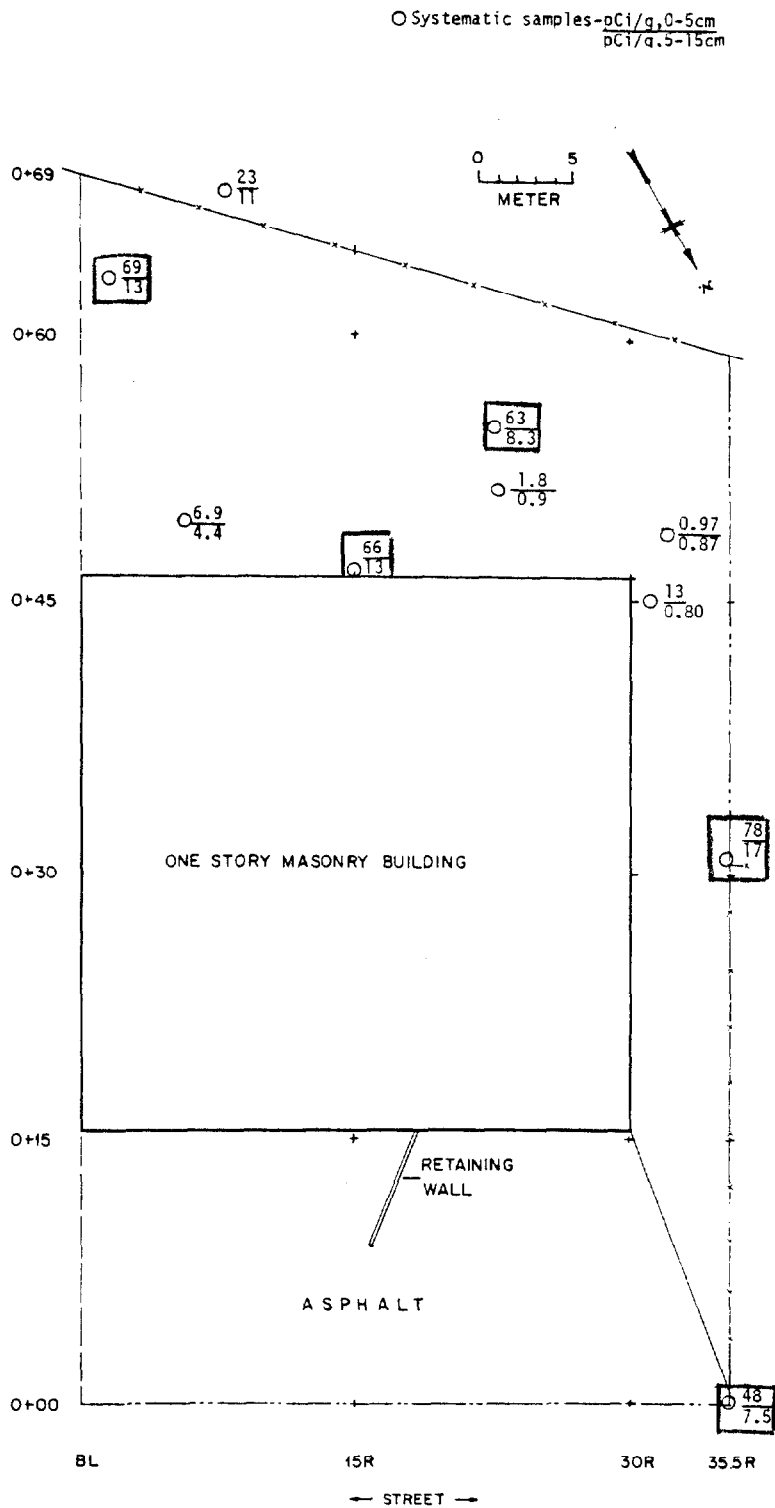

Fig. 22. Concentrations of uranium-238 in soil samples at 1148 Central Avenue, Colonie, New York (AL023).

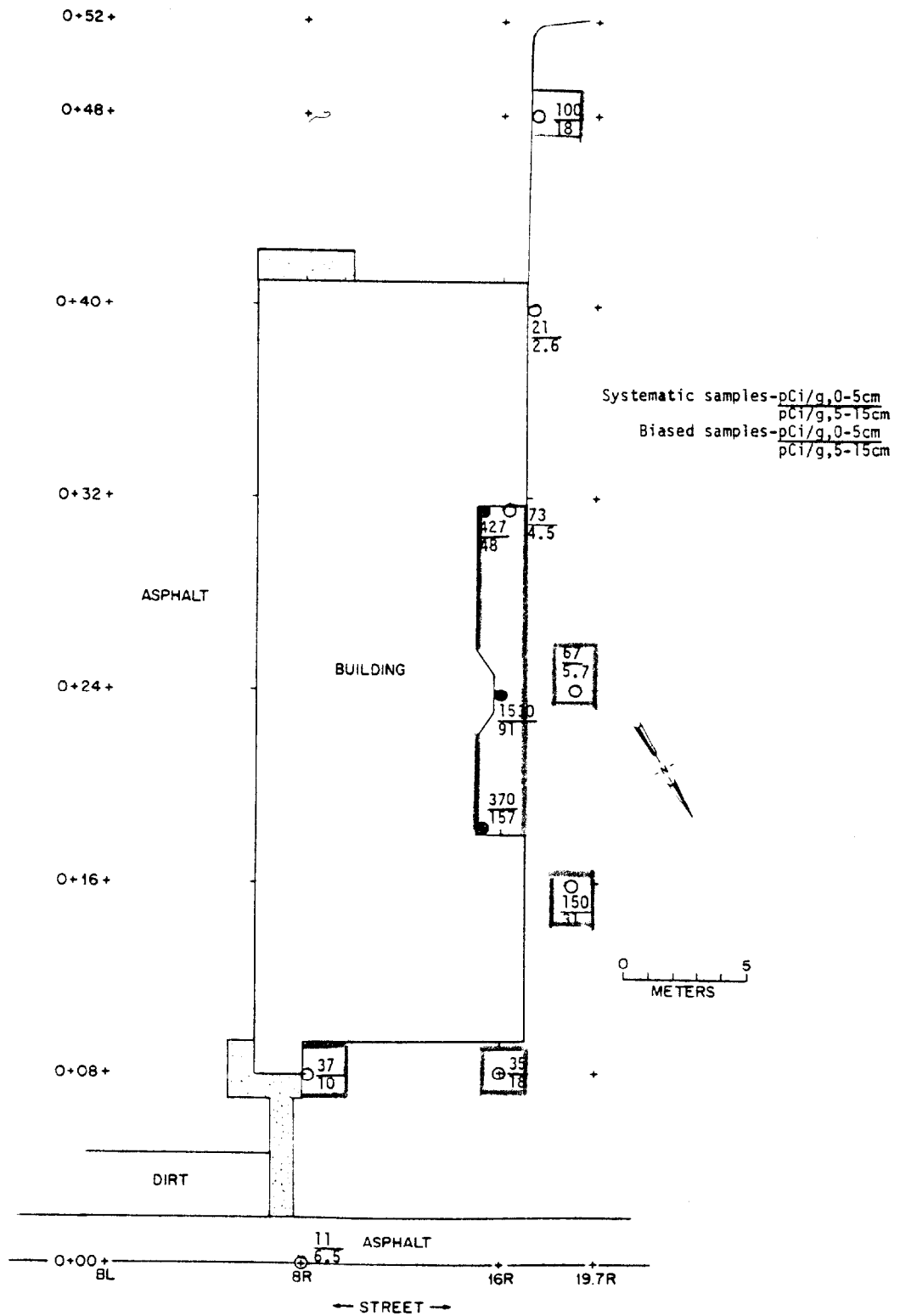

Fig. 24. Concentrations of uranium-238 in soil samples at 1146 Central Avenue, Colonie, New York (AL024).

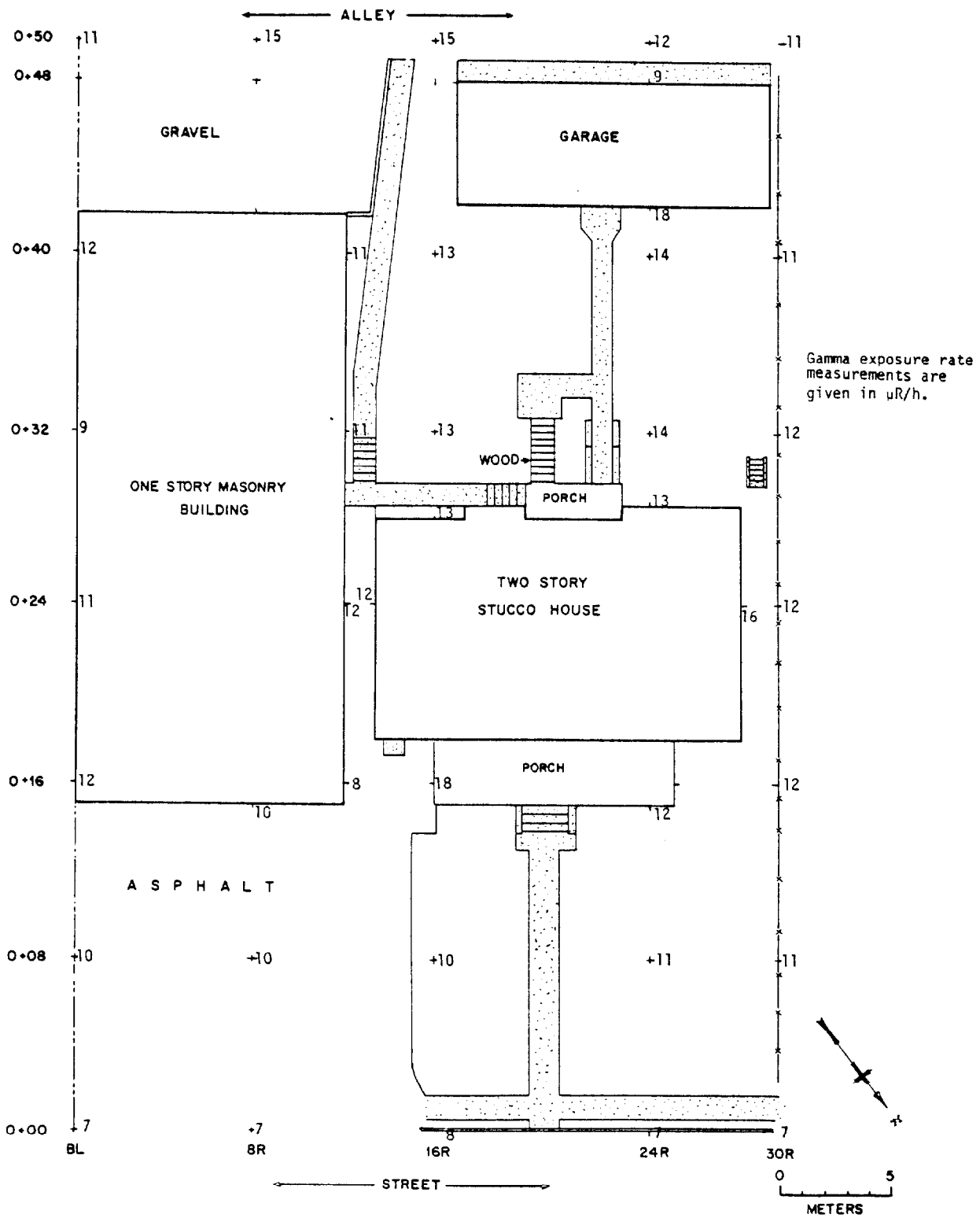

Fig. 25. Gamma exposure rates measured at the surface at grid points at 1148 Central Avenue, Colonie, New York (AL025).

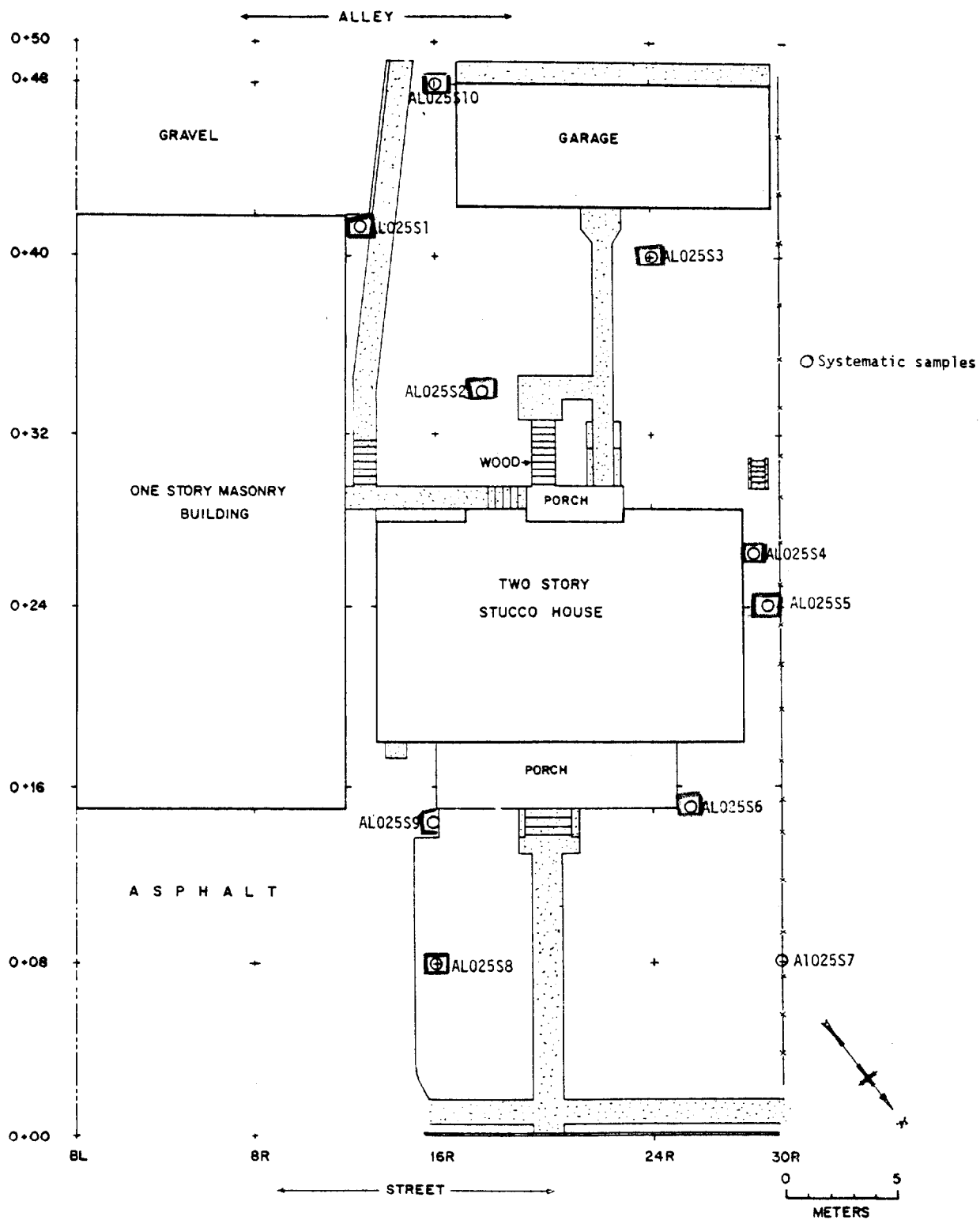

Fig. 26. Concentrations of uranium-238 in soil samples at 1148 Central Avenue, Colonie, New York (AL025).

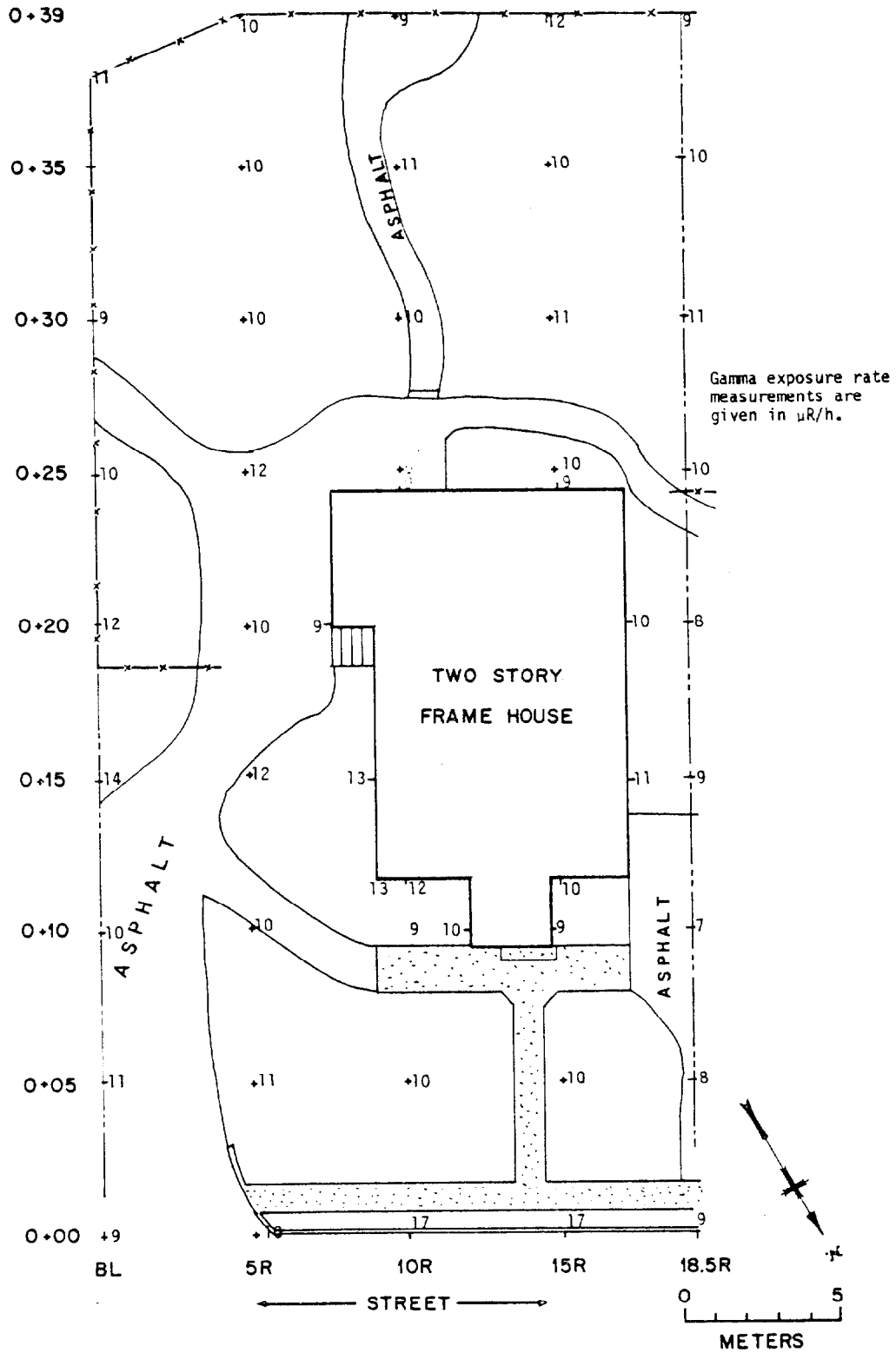

Fig. 27. Gamma exposure rates measured at the surface at grid points at 1150 Central Avenue, Colonie, New York (AL026).

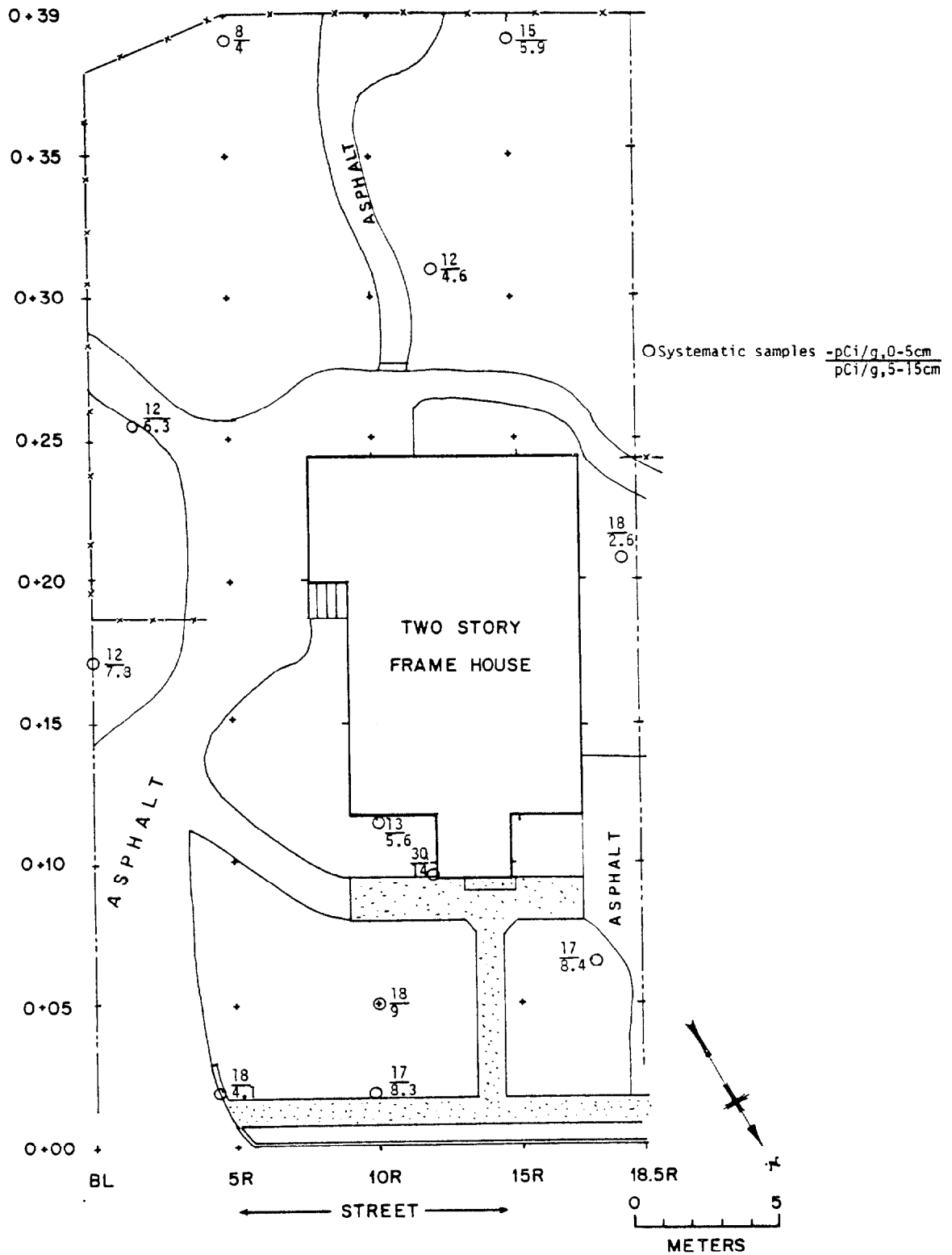

Fig. 28. Concentrations of uranium-238 in soil samples at 1150 Central Avenue, Colonie, New York (AL026).

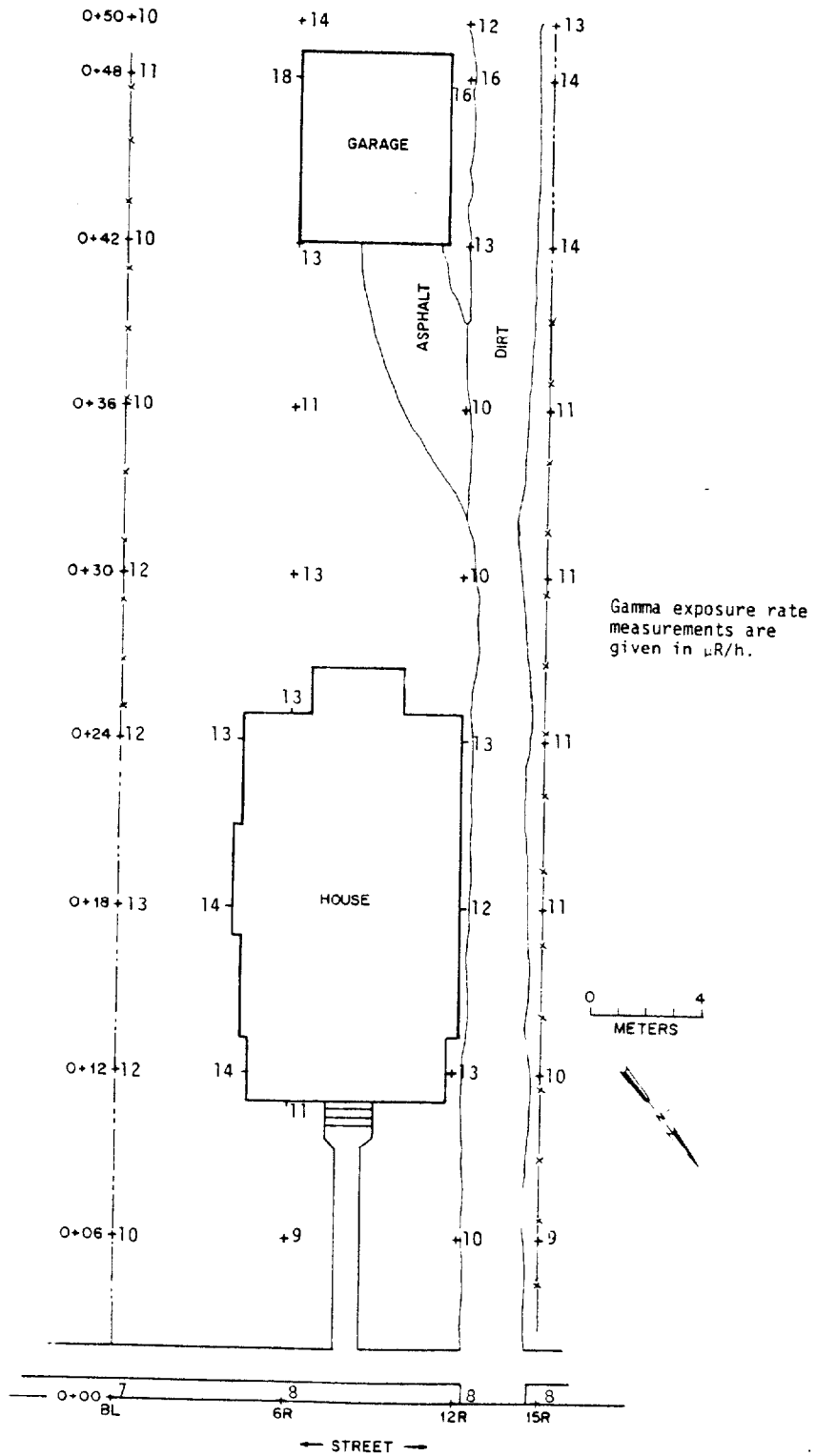

Fig. 29. Gamma exposure rates measured at the surface at grid points at 1152 Central Avenue, Colonie, New York (AL027).

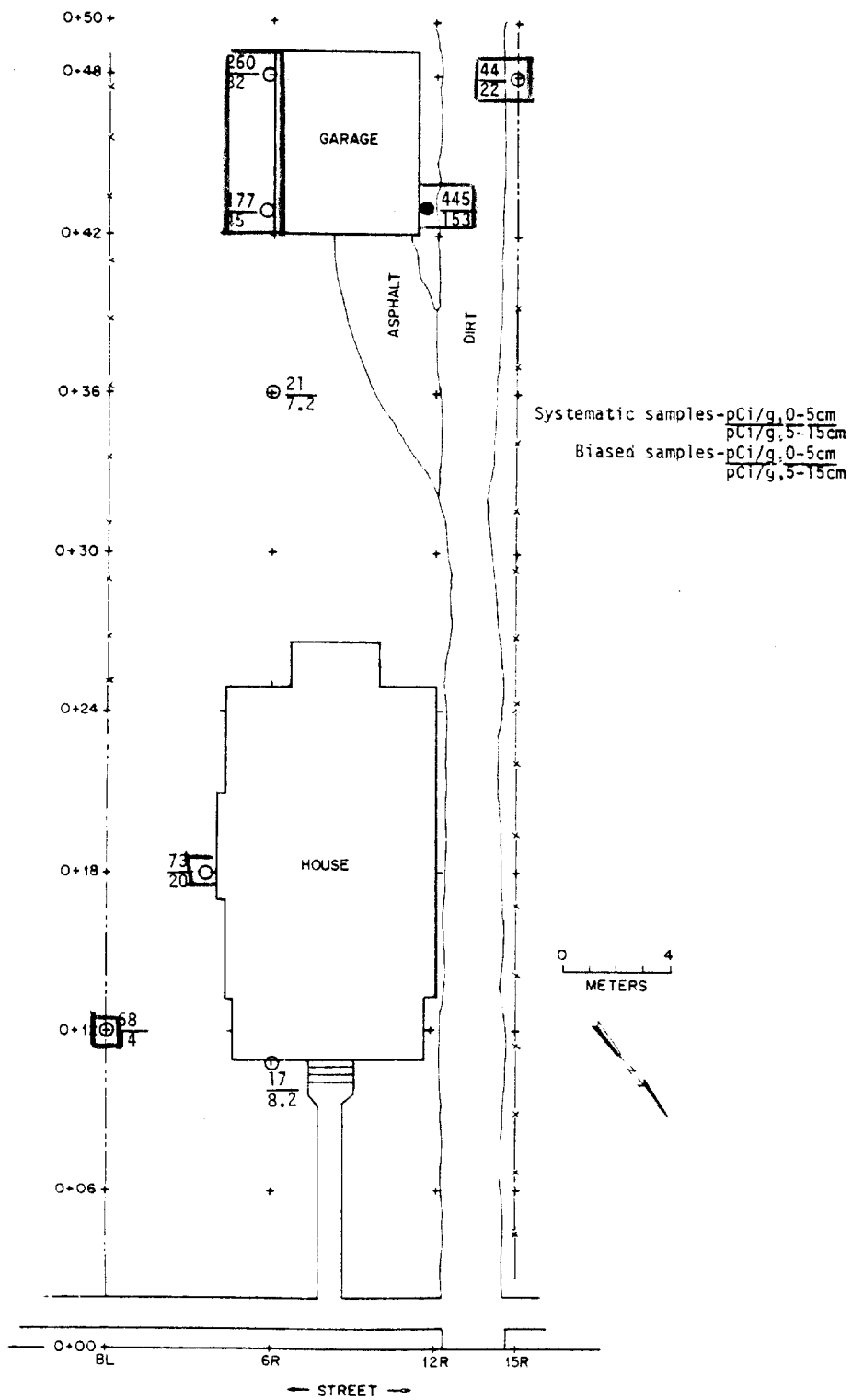

Fig. 30. Concentrations of uranium-238 in soil samples at 1152 Central Avenue, Colonie, New York (AL027).

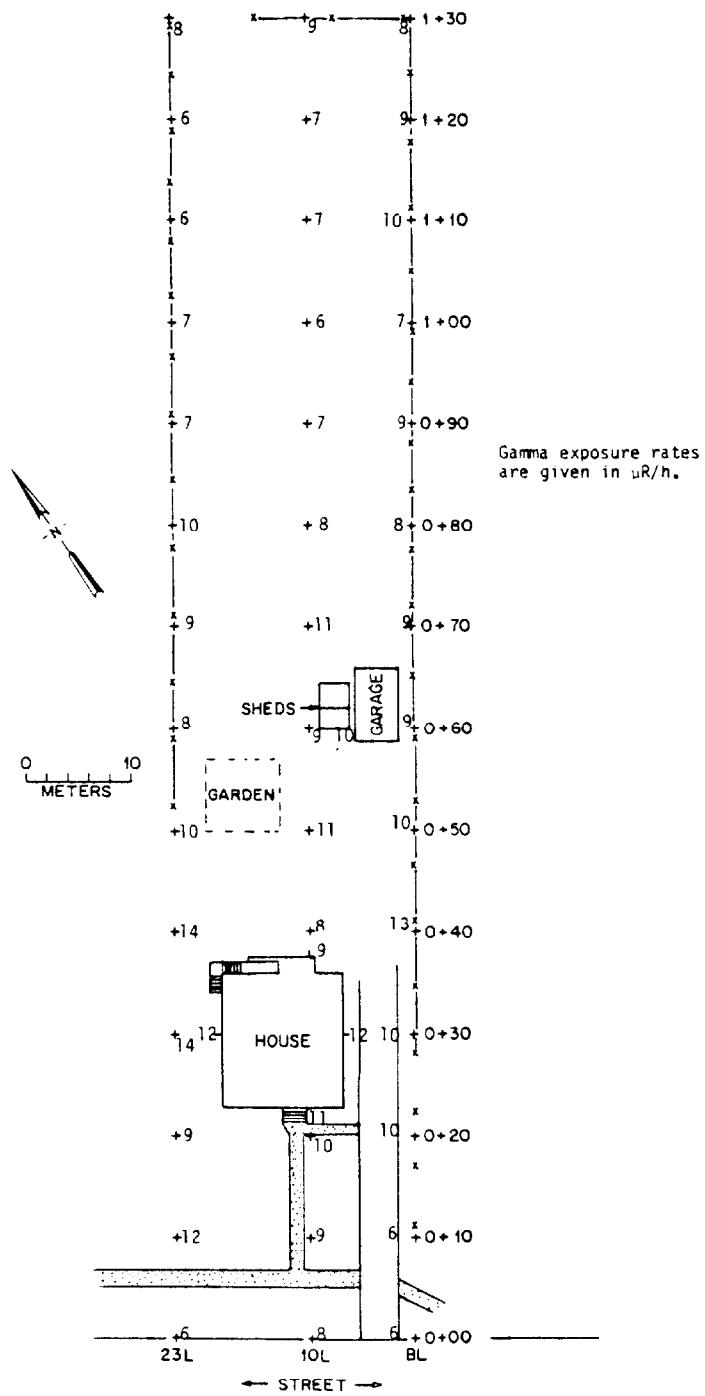

Fig. 31. Gamma exposure rates measured at the surface at grid points at 1159 Central Avenue, Colonie, New York (AL028).

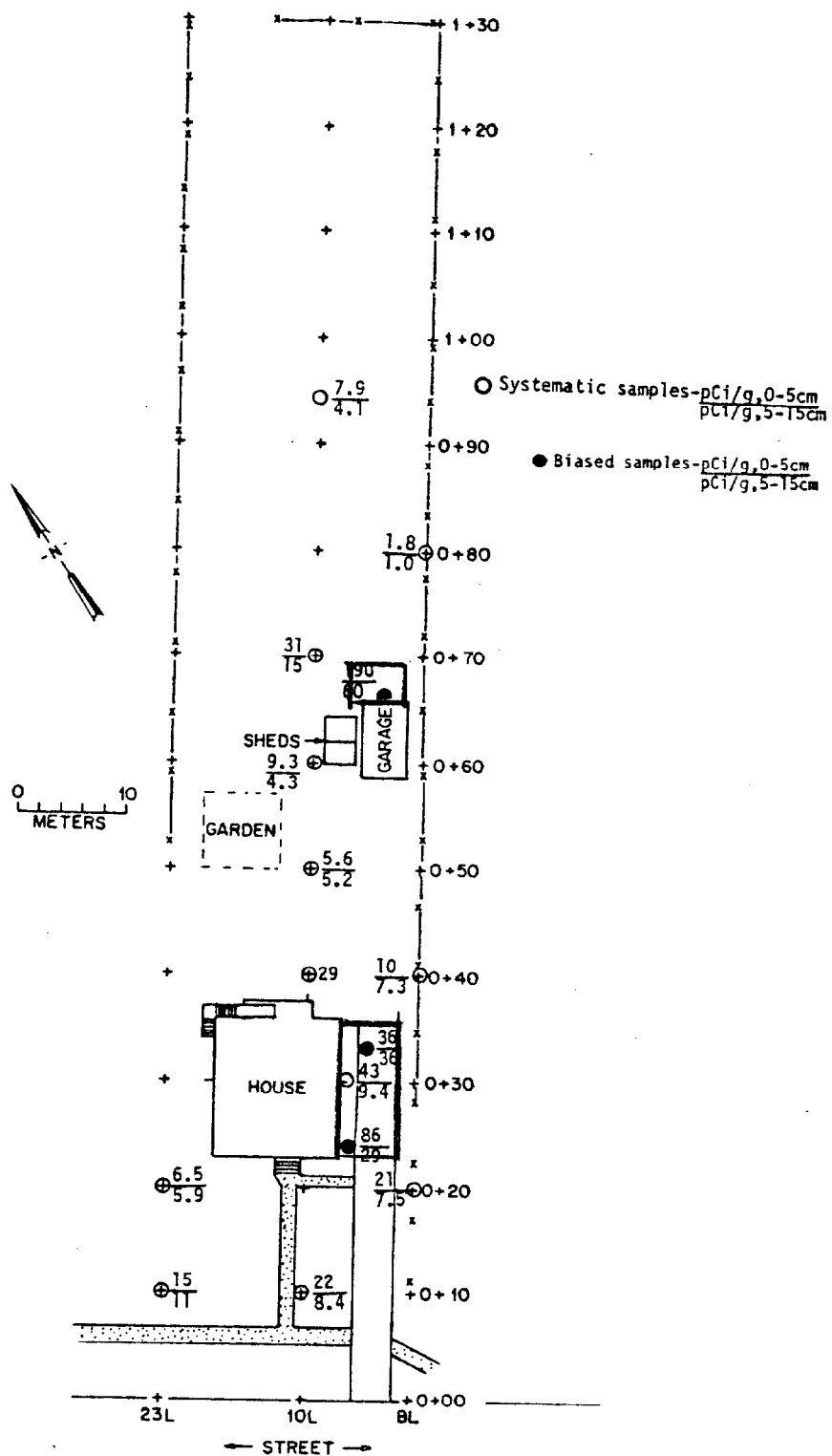

Fig. 32. Concentrations of uranium-238 in soil samples at 1159 Central Avenue, Colonie, New York (AL028).

APPENDIX A

Appendix A. Uranium concentrations in samples from surface and subsurface soil.

Property	Sample location	Depth (cm)	Uranium-238 (pCi/g)
AL013 B2	a (0+32, 6R)	0-5	480
		5-15	230
		15-30	230
AL017 B2	a (0+11, 9.5L)	0-5	106
		5-15	6.2
		15-30	7.3
	b (0+10.2, 2.8L)	0-5	18.
		5-15	12.
		15-30	7.1
AL022 B3	a (0+63.5, 15L)	0-5	87.
		5-15	22.
		15-30	21.
		30-45	5.9
		45-60	2.1
AL025 S1	0+41, 13R	0-1.3	40
		1.3-2.5	37
		2.5-5	28
		5-15	21
AL025 S2	0+34, 18R	0-1.3	22
		1.3-2.5	62
		2.5-5	50
		5-15	14
AL025 S3	0+40, 24R	0-2.5	68
		2.5-5	92
		5-15	35
AL025 S4	0+26, 28.5R	0-1.3	52
		1.3-2.5	30
		2.5-5	9.9
		5-15	3.4
AL025 S5	0+24, 29R	0-1.3	31
		1.3-2.5	32
		2.5-5	17
		5-15	5.9
AL025 S6	0+15.5, 26R	0-1.3	58
		1.3-2.5	14
		2.5-5	4.1
		5-15	1.4
AL025 S7	0+08, 30R	0-1.3	19
		1.3-2.5	19
		2.5-5	22
		5-15	12

Appendix A. (Continued)

Property	Sample location	Depth (cm)	Uranium-238 (pCi/g)
AL025 S8	0+08, 16R	0-1.3	36
		1.3-2.5	67
		2.5-5	29
		5-15	13
AL025 S9	0+15, 16R	0-1.3	150
		1.3-2.5	190
		2.5-5	160
		5-15	43
AL025 S10	0+48, 16R	0-1.3	41
		1.3-2.5	93
		2.5-5	35
		5-15	14

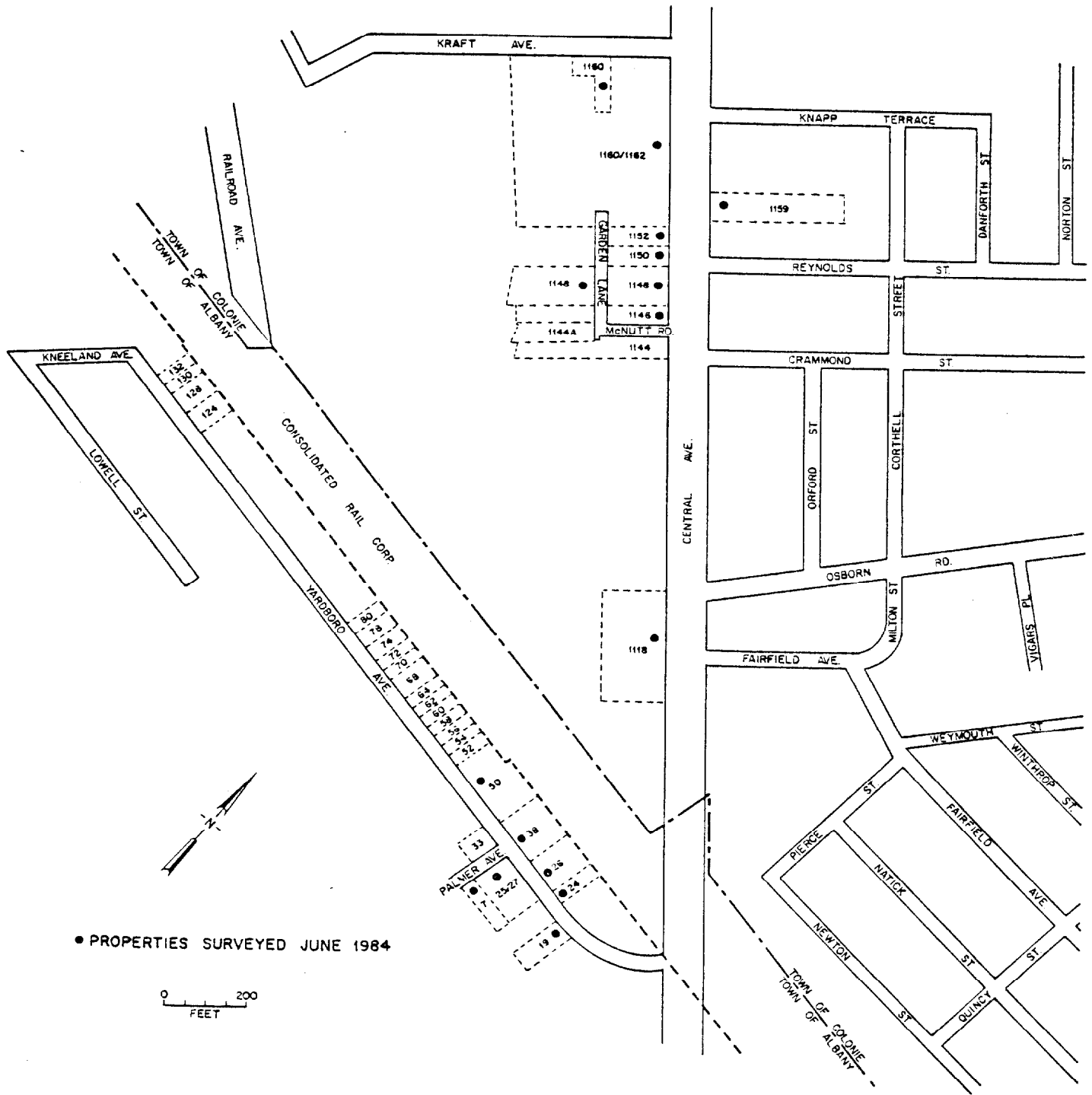

Fig. 33. Locations of completed vicinity property surveys at Albany/Colonie, New York.