

Quarterly Site Inspection Report for the Fernald Preserve, Ohio, Site, June 2020

June 2020



U.S. DEPARTMENT OF
ENERGY

Legacy
Management

This page intentionally left blank

Contents

Abbreviations	ii
1.0 Introduction	1
2.0 Field-Walkdown Site Inspections	1
3.0 PSIC Site Inspection.....	2
4.0 OSDF Inspection	2
5.0 Quarterly Debris Summary	2
6.0 Maintenance and Repair Action Items Summary.....	3
7.0 Planned Activities	3

Tables

Table 1. Second Quarter 2020 Individual Inspections Conducted at the Fernald Preserve.....	1
Table 2. Future Scheduled Inspections at the Fernald Preserve	3

Attachments

Attachment 1.	Field-Walkdown Site Inspection Summary, East Quadrant, June 2020
Attachment 2.	Field-Walkdown Site Inspection Findings Map, East Quadrant, June 2020
Attachment 3.	PSIC Inspection Summary, June 2020
Attachment 4.	OSDF Inspection Summary, June 2020
Attachment 5.	OSDF Inspection Findings Map, June 2020
Attachment 6.	OSDF Inspection Photos, June 2020
Attachment 7.	Maintenance and Repair Action Items Summary, June 2020

Abbreviations

DOE	U.S. Department of Energy
LMICP	Legacy Management and Institutional Controls Plan
ODH	Ohio Department of Health
OSDF	On-Site Disposal Facility
PSIC	point-specific institutional control

1.0 Introduction

The U.S. Department of Energy (DOE) Office of Legacy Management manages the Fernald Preserve, Ohio, Site. This responsibility includes performing quarterly inspections of the site as directed by the *Comprehensive Legacy Management and Institutional Controls Plan* (LMS/FER/S03496), hereafter referred to as the Legacy Management and Institutional Controls Plan (LMICP). This document summarizes the results of the inspections for the second quarter of calendar year 2020. The report also fulfills the reporting requirements specified in the Environmental Covenant, which is Appendix D of the *Consent Decree Resolving Ohio's Natural Resource Damage Claim Against DOE*. The inspections confirm that the activity and use limitations for the Fernald Preserve remain in place and are being complied with.

Inspections conducted at the site include On-Site Disposal Facility (OSDF) inspections, point-specific institutional control (PSIC) site inspections, and field-walkdown site inspections. Field-walkdown site inspections are conducted annually and scheduled during the dormant vegetation months of November through April, while OSDF and PSIC inspections are typically conducted every 3 months. Additional field walkdowns take place following prescribed burns.

Inspections included in this report are listed in Table 1. They were conducted by Navarro Research and Engineering, Inc. (Navarro), the Legacy Management Support contractor, with additional participation from the Ohio Department of Health (ODH). The east quadrant field-walkdown inspection, typically conducted in March, was postponed due to the work restrictions ordered by DOE during the COVID-19 pandemic. DOE notified the Ohio Environmental Protection Agency, ODH, and other regulatory agencies about altering the LMICP-driven inspection schedule in a letter dated March 30, 2020, titled "Impact to the Fernald Preserve, Ohio, Site Due to Ohio's Stay at Home Order as a Result of the COVID-19 Pandemic." Upon DOE beginning a phased approach to return to full operations, the east quadrant field-walkdown was scheduled and conducted on June 3 in conjunction with the regularly scheduled OSDF and PSIC inspections.

Table 1. Second Quarter 2020 Individual Inspections Conducted at the Fernald Preserve

Inspection Type	Inspection Date	Participants
Field-Walkdown Site Inspection (East Quadrant)	June 3, 2020	ODH, Navarro
OSDF Inspection (Toe, Drainages, Fence Line)	June 3, 2020	ODH, Navarro
PSIC Site Inspection	June 4–9, 2020	Navarro

2.0 Field-Walkdown Site Inspections

A field walkdown of the east quadrant, which includes the Lodge Pond basin, east field, east perimeter, Wetland Mitigation Phase 1 Wetlands, and North Pine Plantation, was conducted on June 3 with participation by ODH and Navarro. A summary of the findings from the walkdown is included in Attachment 1, and a map of the finding locations is included as Attachment 2. All but one finding concerned invasive species, which is a common inspection finding for this area of the site. Noxious weeds are addressed by mowing, prescribed burn, herbicide application, or a

combination of these methods. There were no signs of unauthorized access or misuse of the property. A bird box that had fallen down from its post was also identified.

3.0 PSIC Site Inspection

A PSIC site inspection was conducted June 4–9, 2020. Findings are documented on the *Fernald Preserve Institutional Control Inspection* (LMS 3047 FER) form (Attachment 3). Four perimeter signs were identified as needing encroaching vegetation cut away. The grating at both ends of the 60-inch culvert was still sufficient to prevent access and to allow water to flow through the culvert. Field personnel will continue to monitor the culvert and will clear out the culvert as needed to maintain flow as part of site maintenance activities.

The site outfall line to the Great Miami River was also inspected in accordance with the LMICP. No new issues were observed along the length of the outfall line on the slope and in the floodplain. The drainage trench established to allow for runoff from a portion of the upper farmed terrace continued to function as intended. There was again some standing water above the repair area, but no additional erosion. Inspections will continue to monitor this to ensure that erosion does not again become a concern. Manhole 180B, at the bottom of the terrace, was partially covered with sand, but it was still visible. Field personnel will remove sand as needed. Visual inspection of the outfall line will continue to be part of quarterly PSIC inspections.

The build-up of logs and vegetative debris previously identified in Paddys Run at the former train trestle was still present. It was not impeding water flow. Site personnel will continue to monitor this location.

4.0 OSDF Inspection

A quarterly OSDF inspection was conducted on June 3, 2020, with participation by ODH and Navarro personnel. The inspection included a walkdown of the toe, drainages, and fence line. All findings were of woody or noxious vegetation (Attachment 4), which will be addressed by prescribed burning, physical removal, and herbicide application, as appropriate. A map of the findings is presented in Attachment 5.

Photographs of the OSDF and the surrounding area from the June 2020 OSDF inspection are shown in Attachment 6. Photographs of individual findings are typically taken with GPS-enabled cameras. This allows for easier location of the findings for correction or maintenance. When GPS-enabled cameras are used, individual photograph IDs are included in the walkdown inspection summaries. Copies of the photographs are available upon request.

5.0 Quarterly Debris Summary

DOE is committed to providing quarterly summary numbers regarding debris findings. Since the last inspection report (March 2020) no debris was surveyed. The DOE imposed work restrictions at the site during the COVID-19 pandemic, which prevented debris surveys from

being conducted. Surveyed debris is a combination of debris from site and OSDF inspections, inspection follow-ups, discoveries during construction activities, and casual observations while in the field.

6.0 Maintenance and Repair Action Items Summary

Resolution of all findings is tracked through the Fernald Preserve maintenance database. All the findings described in this Quarterly Site Inspection Report have been added to the Fernald Preserve maintenance database and are included in the June 2020 version of the Fernald Preserve Maintenance and Repair Action Items Summary report (Attachment 7). This action items summary report is typically updated once per quarter. With each updated version, items on the database list that have been newly resolved (i.e., resolved since the previous Quarterly Site Inspection Report) are included in the action items summary report with the date and description of the resolution. After an item has been reported as resolved in one version of the action items summary report, that item is removed from the list for the next version of the action items summary report. The resolution of older findings can be found in previous Quarterly Site Inspection Reports.

7.0 Planned Activities

The 2020 inspection schedule of future events is shown in Table 2.

Table 2. Future Scheduled Inspections at the Fernald Preserve

Inspection Type	Inspection Date	Report Date
<ul style="list-style-type: none"> • PSIC Site Inspection • OSDF Inspection (Toe, Drainages, and Fence Line) 	September 1, 2020	September 25, 2020
<ul style="list-style-type: none"> • Post-Burn Inspections 	Inspection dates determined by prescribed burn dates	Report dates determined by inspection dates
<ul style="list-style-type: none"> • Field-Walkdown Site Inspection (West Quadrant) • PSIC Site Inspection • OSDF Inspection (Cap, Drainages, and Fence Line) 	December 2, 2020	January 2021

Notification of upcoming inspections will be provided prior to the inspection date. As always, the timing of inspections is subject to weather conditions.

This page intentionally left blank

Attachment 1

**Field-Walkdown Site Inspection Summary,
East Quadrant, June 2020**

This page intentionally left blank

U.S. Department of Energy Office of Legacy Management

Fernald Preserve Field Walkdown Inspection Summary

Beginning: 06/03/2020

Ending: 06/03/2020

Area(s): East quadrant

Inspector(s): ODH and Navarro

Map No.	Location	GPS?	Type of Finding	Description	Photo
1	West of slope bottom	No	Vegetation	Teasel monoculture	
2	East of W5	No	Vegetation	Pear trees	
3	East and southeast of W4	No	Vegetation	Pear trees	
4	West of slope bottom	No	Vegetation	Teasel	
5	East side of area, between wet areas	No	Vegetation	Teasel (patchy in low spots)	
6	East edge of pines	No	Vegetation	Multiflora rose	
7	South of Lodge Pond, bottom of west slope, west of W2	No	Vegetation	Multiflora rose (possibly)	
8	Bottom of south slope, south of W9	No	Vegetation	Pear trees and thistle	
9	West of slope bottom	No	Vegetation	Pear trees and thistle	
10	West of north entrance gate, north of pines	No	Vegetation	Canada thistle	
11	North of north pines, along St. rt. 126	No	Vegetation	Area becoming inundated with honeysuckle	
12	North end inside trail loop	No	Vegetation	Canada thistle	
13	North of DO Building, south of pond	No	Vegetation	Honeysuckle and pear trees	

Map No.	Location	GPS?	Type of Finding	Description	Photo
14	East perimeter, south of well access road entrance	No	Bird Box	Bird box sild down post	
15	South of WM1, east of road	No	Vegetation	Honeysuckle and pear trees	
16	East edge of road	No	Vegetation	Teasel, honeysuckle, pear tree, autumn olive	
17	East edge of road	No	Vegetation	Honeysuckle and pear trees	
18	East of road in drainage	No	Vegetation	Teasel	
19	W7	No	Vegetation	Phragmites	
20	Berm of W1 and W6	No	Vegetation	Honeysuckle	
21	East edge of W1	No	Vegetation	Honeysuckle, pear trees, autumn olive shrubs and teasel	
22	West side of basins and berms between W2 and W3, and W3 and W4	No	Vegetation	Honeysuckle, pear trees, autumn olive shrubs and teasel	
23	West side of W1	No	Vegetation	Phragmites	
24	West side of W6	No	Vegetation	Phragmites, teasel, canada thistle	
25	Northwest corner of W7	No	Vegetation	Pear trees and honeysuckle	

Additional Notes

East quadrant field walkdown was postponed until June 2020 due to the U.S. DOE's "minsafes" work posture under the COVID-19 pandemic.

Attachment 2

**Field-Walkdown Site Inspection Findings Map,
East Quadrant, June 2020**

This page intentionally left blank

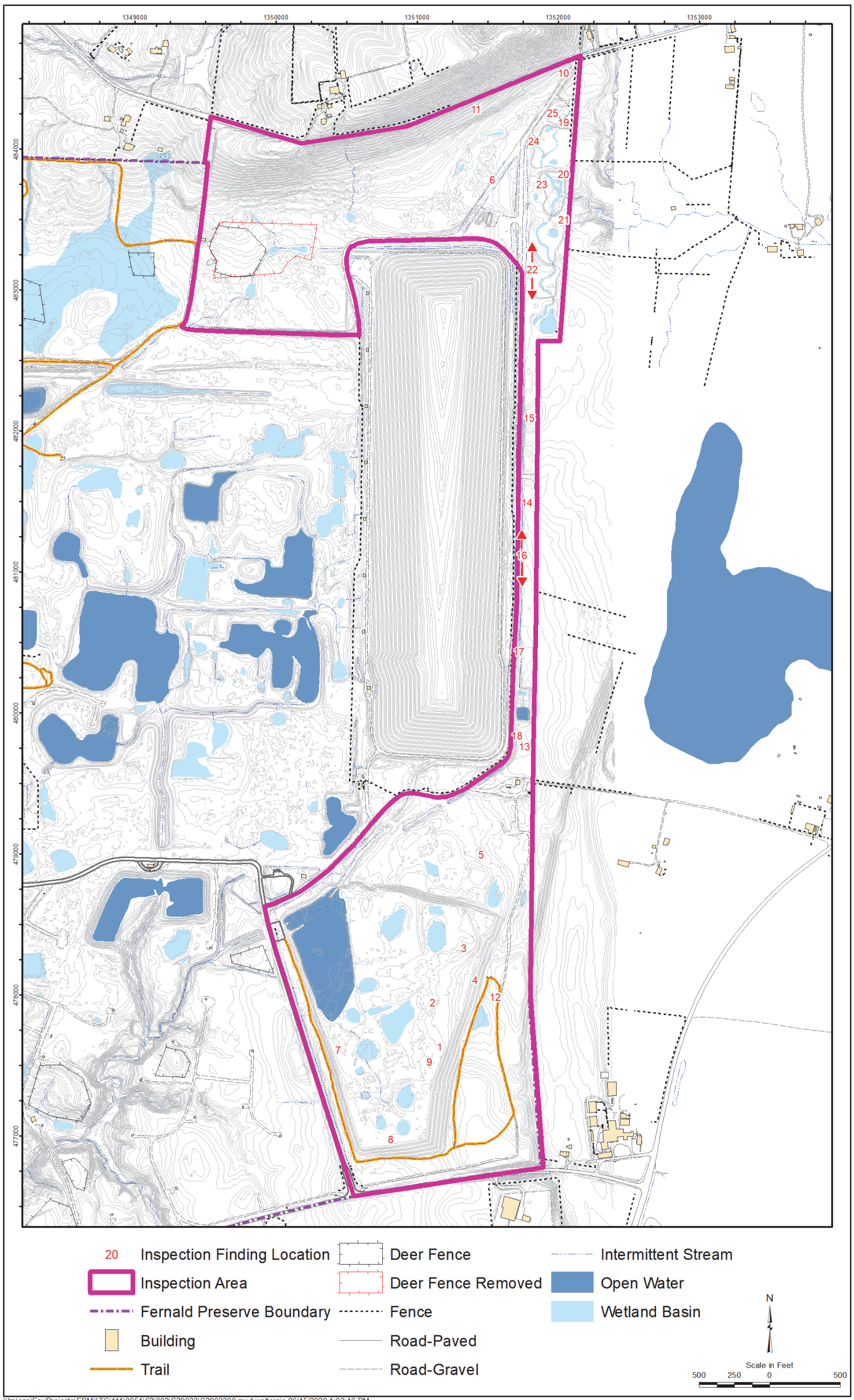

\\mless\EnvProjects\EBMLT\S1111005162\002\S29033\S2903300.mxd waltersjo 06/15/2020 1:03:46 PM

East Quadrant Inspection Findings, June 3, 2020

This page intentionally left blank

Attachment 3

**PSIC Inspection Summary,
June 2020**

This page intentionally left blank



Fernald Preserve Institutional Control Inspection

Date: Jun 4-9, 2020 Inspector: Navarro Camera: NA

Institutional Control	Type of Finding				Description	Photo No.	Follow-up		
	Sign	Barrier	Grounds keeping	Other			Corrected	Maintenance Required	Continue Observation
Perimeter Gates with Locks									
					NO FINDINGS				
					NO FINDINGS				
					NO FINDINGS				
					NO FINDINGS				
Perimeter Access Barriers									
					NO FINDINGS				
					NO FINDINGS				
					NO FINDINGS				
					NO FINDINGS				
Perimeter Signs									
S51, S59, S60, S61	X				Encroaching vegetation blocking sign			X	
					NO FINDINGS				
					NO FINDINGS				
					NO FINDINGS				
Fenced Areas and Gates with Locks									
CAWWT					NO FINDINGS				
OSDF					NO FINDINGS				
Electric Substation					NO FINDINGS				
Water Meter House					NO FINDINGS				
Trestle					NO FINDINGS				
Interior Access Barrier									
					NO FINDINGS				
					NO FINDINGS				
					NO FINDINGS				
					NO FINDINGS				
Non-remedy Buildings and Structures									
Former Communications Building					NO FINDINGS				
Former Dissolved Oxygen Building					NO FINDINGS				



Fernald Preserve Institutional Control Inspection

Type of Finding					Follow-up				
Institutional Control	Sign	Barrier	Grounds keeping	Other	Description	Photo No.	Corrected	Maintenance Required	Continue Observation
Restoration Storage Shed					NO FINDINGS				
Uncertified Areas									
60-inch Culvert					NO FINDINGS				
18-inch Culvert					NO FINDINGS				
CAWWT					NO FINDINGS				
South Field Extraction System Valve House					NO FINDINGS				
Outfall Line					NO FINDINGS				
Other									
Roads and Parking Areas					NO FINDINGS				
Cultural Resource Areas					NO FINDINGS				
Additional Notes									

Attachment 4

**OSDF Inspection Summary,
June 2020**

This page intentionally left blank

U.S. Department of Energy Office of Legacy Management

Fernald Preserve OSDF Walkdown Inspection Summary

Beginning: 06/03/2020

Ending: 06/03/2020

Area(s): OSDF toe, drainages and fence line

Inspector(s): ODH and Navarro

Map No.	Location	GPS?	Type of Finding	Description	Photo
1	Cell 1, north drainage, northwest corner	No	Vegetation	Teasel, pear tree, honeysuckle, cedar tree	
2	Cell 1, north drainage bottom at former gate location	No	Vegetation	Honeysuckle	
3	Cell 1, northeast corner drainage	No	Vegetation	Cedar, honeysuckle, pear	
4	Cell 3, east drainage at fence	No	Vegetation	Honeysuckle	
5	Cell 3/4 boundary, east drainage at fence	No	Vegetation	Pear tree	
6	Cell 4, east drainage at fence	No	Vegetation	Thistle and woody vegetation	
7	Cell 4, east drainage at fence	No	Vegetation	Canada thistle	
8	Cell 5, east drainage at fence	No	Vegetation	Pear trees	
9	Cell 6, west edge of road	No	Vegetation	Pear trees and honeysuckle	
10	Cell 1, east and west slopes	No	Vegetation	Scattered woody vegetation	
11	Cell 2, east and west slopes	No	Vegetation	Scattered woody vegetation	
12	Cell 3, east and west slopes	No	Vegetation	Scattered woody vegetation	
13	Cell 4, east and west slopes	No	Vegetation	Scattered woody vegetation	

Map No.	Location	GPS?	Type of Finding	Description	Photo
14	Cell 5, west side of road	No	Vegetation	Woody vegetation	
15	Cell 5, west side of road	No	Vegetation	Woody vegetation	
16	Cell 6, toe of slope	No	Vegetation	Woody vegetation	
17	Cell 6, west drainage	No	Vegetation	Woody vegetation, thistle, teasel	
18	Cell 8, east toe and drainage	No	Vegetation	Teasel	

Additional Notes

Attachment 5

**OSDF Inspection Findings Map,
June 2020**

This page intentionally left blank

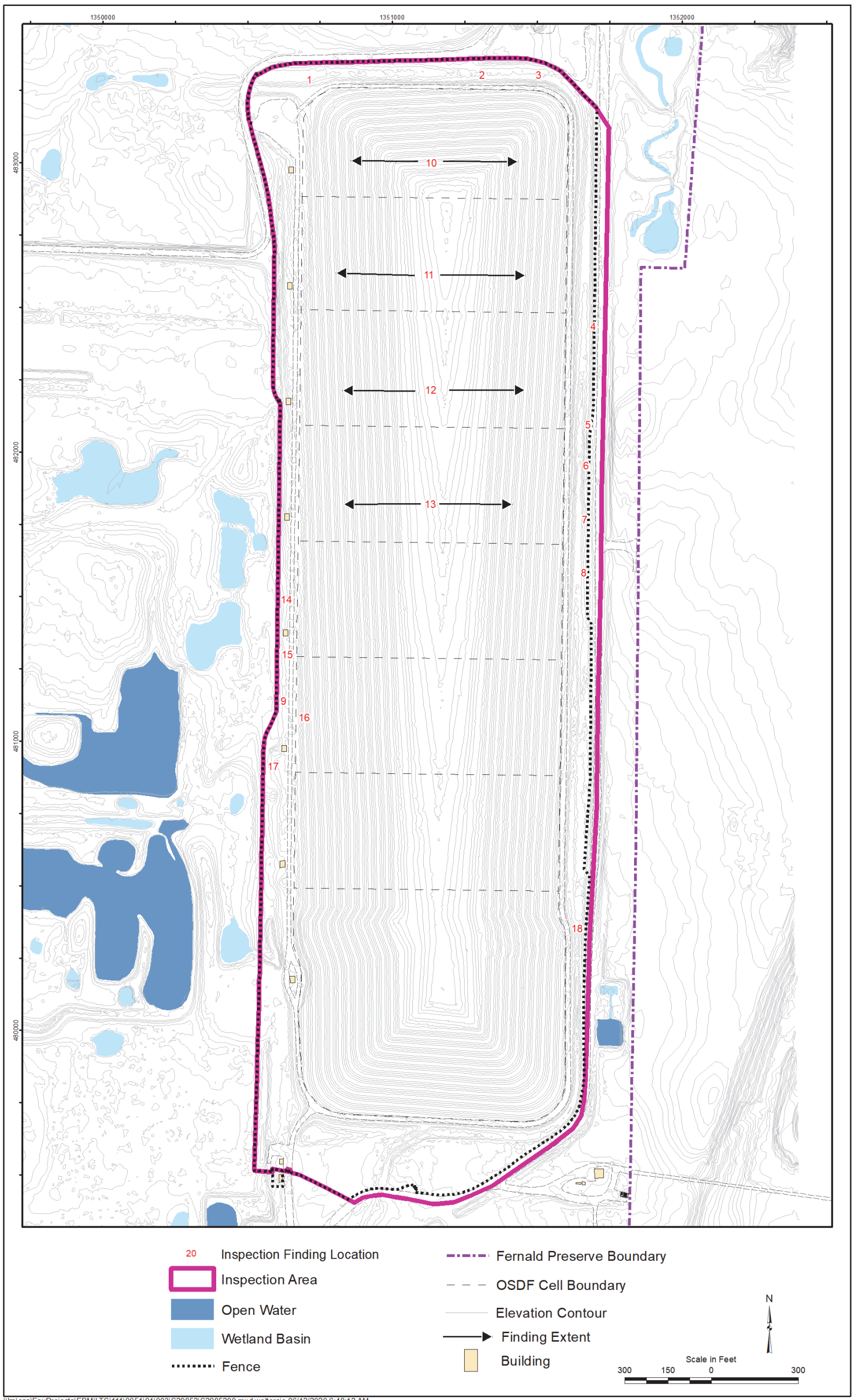

\\mess\EnvProjects\EBMLTS\11110051\01003\S29852\S2985200.mxd waltersjo 06/12/2020 6:48:12 AM

OSDF Inspection Findings, June 3, 2020

This page intentionally left blank

Attachment 6

**OSDF Inspection Photos,
June 2020**

This page intentionally left blank

FERNALD PRESERVE

On-Site Disposal Facility Inspection Photographs

June 2020





P6030020

East Face Cell 1



P6030002

West Face Cell 1

6/20.2



P6030018

North Face Cell 1



P6030019

North Drainage (looking west)

6/20.3



P6030022

East Face Cell 2



P6030003

West Face Cell 2

6/20.4



P6030023

East Face Cell 3



P6030004

West Face Cell 3

6/20.5



P6030024

East Face Cell 4



P6030005

West Face Cell 4

6/20.6



P6030026

East Face Cell 5



P6030007

West Face Cell 5

6/20.7



P6030027

East Face Cell 6



P6030008

West Face Cell 6

6/20.8



P6030028

East Face Cell 7



P6030009

West Face Cell 7

6/20.9



P6030015

East Face Cell 8



P6030012

West Face Cell 8

6/20.10



P6030013

South Face Cell 8



P6030014

South Drainage (looking west)

6/20.11



P6030029

East Drainage Cell 7 (looking south)



P6030025

East Drainage Cell 4 (looking south)

6/20.12



P6030021

East Drainage Cell 1 (looking south)



IMGP7622

West Inner Drainage Cell 7 (looking south)

6/20.13



P6030006

West Inner Drainage Cell 4 (looking south)



P6030017

West Inner Drainage Cell 1 (looking south)

6/20.14



P6030001 **West Outer Drainage Cell 1 (looking south)**



P6030011 **West Outer Drainage Cell 8 (looking south)**

6/20.15



P6030010

West Outer Drainage Cell 8 (looking north)

Attachment 7

**Maintenance and Repair Action Items Summary,
June 2020**

This page intentionally left blank

FERNALD PRESERVE MAINTENANCE AND REPAIR ACTION ITEMS SUMMARY
JUNE 2020 UPDATE

No.	Location	GPS?	Maintenance Item Identified	Date Identified	Origin of Finding	Inspection Finding No.	Resolution	Date of Resolution	Comments
1013	South side of south pines deer fence	No	Honeysuckle	6/2/2010	June 2010 quarterly field walkdown	45			Large-scale woody invasives are addressed on a prioritized schedule
1291	North pines	No	Honeysuckle along woodline	9/7/2011	September 2011 quarterly field walkdown	10			Large-scale woody invasives are addressed on a prioritized schedule
1468	Drainage area	No	Garlic mustard	6/5/2012	June 2012 quarterly field walkdown	26			
1739	East bank Paddys Run	No	Multiflora rose	6/6/2013	June 2013 quarterly field walkdown	52			
1781	Hill along State Route 126	No	Honeysuckle	9/4/2013	September 2013 quarterly field walkdown	10			Large-scale woody invasives are addressed on a prioritized schedule
1788	WM1 W4 between pond and swale	No	Honeysuckle	9/4/2013	September 2013 quarterly field walkdown	17			
2232	East and north of service road, northwest of WM2	No	Pear tree	12/4/2014	December 2014 quarterly field walkdown	2			
2235	West of north/south section of Hickory Trail	No	Autumn olive	12/4/2014	December 2014 quarterly field walkdown	5			
2346	W4 swale	No	Honeysuckle	3/12/2015	March 2015 quarterly field walkdown	2			Large-scale woody invasives are addressed on a prioritized schedule
2358	Monitoring Wells 2431 and 3431	No	Water collecting around well pads; terrain needs altered to drain surface water away from wells	3/12/2015	March 2015 quarterly field walkdown	14			
2615	Cell 3, east slope	No	Erosion/burrow	12/2/2015	December 2015 OSDF Inspection	106			

No.	Location	GPS?	Maintenance Item Identified	Date Identified	Origin of Finding	Inspection Finding No.	Resolution	Date of Resolution	Comments
2659	At base of hill on west side	No	Old cages	12/8/2015	December 2015 quarterly field walkdown	6			
2712	Slope east of drainage that flows north from off site	No	Old deer cages need removed	2/23/2016	February 2016 quarterly field walkdown	12			
2818	Cell 3, west toe	No	Sandy dirt pile	9/6/2016	September 2016 OSDF Inspection	17			
2871	Cell 4, west face	Yes	Rock	12/1/2016	December 2016 OSDF Inspection	1			Camera L14641
2893	Rip rap repair	No	Side blow out	1/11/2017	January 2017 quarterly field walkdown	1			
2907	30 yards north of Swan Pond	No	Old cages need removed	1/11/2017	January 2017 quarterly field walkdown	15			
2912	East bank of drainage/side drainage off top of hill	No	Cut through core matting	1/11/2017	January 2017 quarterly field walkdown	20			
2922	Area not identified on map	No	Large bare area	1/11/2017	January 2017 quarterly field walkdown	30			
2923	East of small basin to the east of Swan Pond	No	Erosion	1/11/2017	January 2017 quarterly field walkdown	31			
2943	North of east/west drain	No	T-posts	1/11/2017	January 2017 quarterly field walkdown	51			
2956	West of concrete wall	Yes	Exposed concrete and erosion	2/8/2017	February 2017 quarterly field walkdown	12			The concrete is from a beneficial reuse of concrete in this area; erosion repair is needed
2958	South of 'dance hall'	No	Broken survey marker	2/8/2017	February 2017 quarterly field walkdown	14			

No.	Location	GPS?	Maintenance Item Identified	Date Identified	Origin of Finding	Inspection Finding No.	Resolution	Date of Resolution	Comments
2962	Along trail, both sides	No	Deer cages	2/8/2017	February 2017 quarterly field walkdown	18			
2963	Among the trees at the south edge of the field	No	Deer cages	2/8/2017	February 2017 quarterly field walkdown	19			
2964	Pines west of CAWWT	No	Deer cages	2/8/2017	February 2017 quarterly field walkdown	20			
2965	South of trail	No	Cages	2/8/2017	February 2017 quarterly field walkdown	21			
2966	South of south end of trail	No	Deer cages	2/8/2017	February 2017 quarterly field walkdown	22			
2967	West of 'dance hall'	No	Deer cages	2/8/2017	February 2017 quarterly field walkdown	23			
2974	Edge of pond	Yes	Deer cages need to be pulled	3/2/2017	March 2017 quarterly field walkdown	6			
2977	South berm of NPPW5	Yes	Water level 1 foot lower in basin	3/2/2017	March 2017 quarterly field walkdown	9			
3000	Cell 8, gravel roadway along south face	No	The gravel road is developing an erosion rill, washing gravel into south drainage	6/7/2017	June 2017 OSDF Inspection	2			
3058	Top of the hill	Yes	Survey marker is at this location; unknown why it is here	12/7/2017	December 2017 quarterly field walkdown	1			
3063	South end of flood plain along Paddys Run	Yes	Metal posts and cages at trees	12/7/2017	December 2017 quarterly field walkdown	6			
3066	West end of railroad trestle	Yes	Concrete	12/7/2017	December 2017 quarterly field walkdown	9			

No.	Location	GPS?	Maintenance Item Identified	Date Identified	Origin of Finding	Inspection Finding No.	Resolution	Date of Resolution	Comments
3067	Bank of creek	Yes	Post on ground; signs on ground	12/7/2017	December 2017 quarterly field walkdown	10			
3068	East of deer fence	Yes	Old cages need removed	12/7/2017	December 2017 quarterly field walkdown	11			
3069	North side of west end of W2	Yes	Deer cages need removed	12/7/2017	December 2017 quarterly field walkdown	12			
3071	North end of flood plain	Yes	Metal posts at several trees need removed	12/7/2017	December 2017 quarterly field walkdown	14			
3072	Along Paddys Run Rd	Yes	Deer cages need removed	12/7/2017	December 2017 quarterly field walkdown	15			
3074	Cell 5, west top	Yes	Honeysuckle	12/14/2017	December 2017 OSDF Inspection	2			
3082	North end of 60" culvert	No	Vegetation buildup; appears metal grate is detaching from concrete	12/8/2017	December 2017 point-specific institutional controls inspection	NA			Water is flowing freely
3085	Northeast of Swan pond	Yes	Wash out between ponds	1/10/2018	January 2018 quarterly field walkdown	1			
3103	East edge of basin just south of CAWWT	No	Water coming into an area, causing a 4-foot bare area and erosion	1/10/2018	January 2018 quarterly field walkdown	19			
3111	Bank over creek	No	Tree cages (need removed)	2/13/2018	February 2018 quarterly field walkdown	4			
3112	Behind "bone yard"	No	Tree cages (need removed)	2/13/2018	February 2018 quarterly field walkdown	5			
3113	East side of deer fence	Yes	Break in deer fence	2/13/2018	February 2018 quarterly field walkdown	6			

No.	Location	GPS?	Maintenance Item Identified	Date Identified	Origin of Finding	Inspection Finding No.	Resolution	Date of Resolution	Comments
3114	East of well house	Yes	Styrofoam pieces	2/13/2018	February 2018 quarterly field walkdown	7			
3115	Road down into SSOD	No	Tree across access	2/13/2018	February 2018 quarterly field walkdown	8			
3123	North side of fence	Yes	Deer fence ripped and sagging	2/13/2018	February 2018 quarterly field walkdown	16			
3124	Southeast side of deer fence	Yes	Deer fence sagging	2/13/2018	February 2018 quarterly field walkdown	17			
3128	North of pond	No	Tree cages and metal posts (need removed)	3/6/2018	March 2018 quarterly field walkdown	2			
3129	Property line	No	Metal posts from old power lines	3/6/2018	March 2018 quarterly field walkdown	3			
3134	Basin 6	No	Hole	3/6/2018	March 2018 quarterly field walkdown	8			
3179	Cell 2, east toe	Yes	Holes, possible soil settling	4/10/2018	April 2018 OSDF Inspection	31			
3188	Cell 3, west toe across from valve house	No	Erosion in several places at and along rip rap, 6" deep	4/10/2018	April 2018 OSDF Inspection	40			
3204	North fence line	Yes	Couplers broken from fence	6/6/2018	June 2018 OSDF Inspection	15			
3260	Cell 4, west drainage, at midpoint of fence (outside)	No	Concrete	12/5/2018	December 2018 OSDF Inspection	21			
3261	Cell 3, west drainage, at fence (outside)	No	Minor erosion	12/5/2018	December 2018 OSDF Inspection	22			

No.	Location	GPS?	Maintenance Item Identified	Date Identified	Origin of Finding	Inspection Finding No.	Resolution	Date of Resolution	Comments
3265	East side of deer fence	No	Japanese honeysuckle pulling fence down pole	12/12/2018	December 2018 quarterly field walkdown	2			
3267	South end of floodplain	Yes	Old deer cages and metal posts on ground	12/12/2018	December 2018 quarterly field walkdown	4			
3271	South end of floodplain	Yes	Deer cages and metal posts on ground	12/12/2018	December 2018 quarterly field walkdown	8			
3272	East end of former chainlink fence	Yes	6" diameter pipe from former chain link fence left in the ground; open hole	12/12/2018	December 2018 quarterly field walkdown	9			
3275	In wooded area	Yes	Tree tubes need removed	12/12/2018	December 2018 quarterly field walkdown	12			
3293	West of former waste pits	Yes	Rail road tie	1/10/2019	January 2019 quarterly field walkdown	5			Need equipment to access
3306	East fenceline	Yes	Hole in fence	2/14/2019	February 2019 quarterly field walkdown	1			
3307	West of road in grass	Yes	Coiled hose	2/14/2019	February 2019 quarterly field walkdown	2			
3311	North and west side of deer fence south of "dance hall"	Yes	Hole in fence and fence sliding down poles	2/14/2019	February 2019 quarterly field walkdown	6			
3312	East side of deer fence	Yes	Fence sliding down poles	2/14/2019	February 2019 quarterly field walkdown	7			
3313	Southwest corner of south field deer fence at well house	Yes	Fence sliding down poles	2/14/2019	February 2019 quarterly field walkdown	8			
3315	Deer fence across from Lodge Pond	Yes	Northwest corner of fence needs pulled back into place	2/14/2019	February 2019 quarterly field walkdown	10			

No.	Location	GPS?	Maintenance Item Identified	Date Identified	Origin of Finding	Inspection Finding No.	Resolution	Date of Resolution	Comments
3316	Southeast corner of deer fence just west of gravel road	No	Fence falling down poles	2/14/2019	February 2019 quarterly field walkdown	11			
3317	Unforested portion of hill west of SSOD	No	Erosion of hillside	2/14/2019	February 2019 quarterly field walkdown	12			
3319	Along Paddys Run	Yes	Steel post	2/14/2019	February 2019 quarterly field walkdown	14			
3340	Cell 8, gravel road along south face	Yes	Erosion in gravel road	3/13/2019	March 2019 OSDF Inspection	16			Finding previously identified
3342	East edge of borrow area basin at toe of slope	Yes	Pear tree	3/13/2019	March 2019 quarterly field walkdown	2			
3344	East slope of borrow area basin, southeast corner	Yes	Pear trees	3/13/2019	March 2019 quarterly field walkdown	4			
3345	South of Lodge Pond	Yes	Metal tree protection cages and metal posts need removed	3/13/2019	March 2019 quarterly field walkdown	5			
3349	Between east pond and slope	Yes	Pear trees	3/13/2019	March 2019 quarterly field walkdown	9			
3351	Southeast corner of borrow area basin, on slope	Yes	Pear trees	3/13/2019	March 2019 quarterly field walkdown	11			
3352	South slope of borrow area basin	Yes	Pear trees	3/13/2019	March 2019 quarterly field walkdown	12			
3359	Along levy/ridge	Yes	Erosion at end of culvert	3/13/2019	March 2019 quarterly field walkdown	18			
3360	Along levy/ridge	Yes	Erosion, hole	3/13/2019	March 2019 quarterly field walkdown	19			

No.	Location	GPS?	Maintenance Item Identified	Date Identified	Origin of Finding	Inspection Finding No.	Resolution	Date of Resolution	Comments
3372	Pines along north access road, most northern group of trees	Yes	Trash (bottle, metal)	3/13/2019	March 2019 quarterly field walkdown	27			
3392	Cell 8, north of VH 8, across from utility pole	No	Tile	3/20/2019	March 2019 OSDF Inspection	18			Post-burn walkover
3393	Cell 8, west 6:1 on ridge	No	Brick	3/20/2019	March 2019 OSDF Inspection	19			Post-burn walkover
3395	Cell 8, west 6:1	No	Fabric	3/20/2019	March 2019 OSDF Inspection	21			Post-burn walkover
3396	Cell 8, south face	No	Fabric	3/20/2019	March 2019 OSDF Inspection	22			Post-burn walkover
3397	Cell 8, southeast corner	No	Bag/trash	3/20/2019	March 2019 OSDF Inspection	23			Post-burn walkover
3398	Cell 7/8 boundary, top	No	Animal burrow	3/20/2019	March 2019 OSDF Inspection	24			Post-burn walkover
3434	East bank of MDC	Yes	Rill going down slope	4/29/2019	April 2019 quarterly field walkdown	36			Post-burn walkdown
3521	60-inch culvert	No	Vegetative debris blocking most of upper opening	6/11/2019	June 2019 point-specific institutional controls inspection	NA			
3522	Outfall line, east of Fernald property	No	Property owner installed drainage trench.	6/10/2019	June 2019 point-specific institutional controls inspection	NA			Area will be monitored to ensure erosion does not become an issue
3533	Cell 8, south drain along east side of north/south drain	No	Honeysuckle	9/4/2019	September 2019 OSDF Inspection	11			No flag
3537	60-inch culvert, north end	No	North end mostly blocked with mud, vegetative debris and new vegetation growth.	9/5/2019	September 2019 point-specific institutional controls inspection	NA			Water levels are down and there is currently no water flow through the culvert, even though water levels are above the bottom of the culvert. Standing water in the culvert.

No.	Location	GPS?	Maintenance Item Identified	Date Identified	Origin of Finding	Inspection Finding No.	Resolution	Date of Resolution	Comments
3540	Southeast side of deer fence	No	Tree on deer fence	12/4/2019	December 2019 quarterly field walkdown	2			
3541	West side of deer fence	No	Hole in deer fence	12/4/2019	December 2019 quarterly field walkdown	3			
3542	Southeast corner of deer fence	No	Japanese honeysuckle pulling deer fence down	12/4/2019	December 2019 quarterly field walkdown	4			
3543	East side of deer fence	No	Japanese honeysuckle on fence	12/4/2019	December 2019 quarterly field walkdown	5			
3544	Adjacent to Paddys Run	No	Tree tubes laying on ground need to be removed	12/4/2019	December 2019 quarterly field walkdown	6			
3545	East of access path and PRT RF2	No	Tree protection cages need removed	12/4/2019	December 2019 quarterly field walkdown	7			
3546	Cell 4, west 6:1/10:1 change	Yes	Pear trees	12/5/2019	December 2019 OSDF Inspection	1			
3547	Cell 8, east 10:1/20:1 change	Yes	Groundhog hole	12/5/2019	December 2019 OSDF Inspection	2			
3548	Cell 3, east 10:1 slope	Yes	Pear trees	12/5/2019	December 2019 OSDF Inspection	3			
3549	Cell 2, east toe	Yes	Honeysuckle	12/5/2019	December 2019 OSDF Inspection	4			
3550	Cell 3, east toe	Yes	Pear tree	12/5/2019	December 2019 OSDF Inspection	5			
3551	Cell 3, east toe	Yes	Groundhog hole	12/5/2019	December 2019 OSDF Inspection	6			

No.	Location	GPS?	Maintenance Item Identified	Date Identified	Origin of Finding	Inspection Finding No.	Resolution	Date of Resolution	Comments
3552	Cell 4, west 6:1 top	Yes	Cluster of 3 pear trees	12/5/2019	December 2019 OSDF Inspection	7			
3553	Cell 5, west top 6:1, near fire break	Yes	Pear tree	12/5/2019	December 2019 OSDF Inspection	8			
3554	Cell 3, east 20:1	Yes	Pear seedlings, several in area	12/5/2019	December 2019 OSDF Inspection	9			
3555	Cell 2, east 6:1	Yes	Pear seedling	12/5/2019	December 2019 OSDF Inspection	10			
3556	Cell 3, east 6:1	Yes	Pear trees, several in area	12/5/2019	December 2019 OSDF Inspection	11			
3557	Cell 4, east 6:1	Yes	Pear trees, several in area	12/5/2019	December 2019 OSDF Inspection	12			
3558	Cell 5, west 6:1	Yes	Woody plant (pear)	12/5/2019	December 2019 OSDF Inspection	13			
3559	Cell 6, east top	Yes	Woody plant (pear)	12/5/2019	December 2019 OSDF Inspection	14			
3560	Cell 5, east 6:1	Yes	Two woody plants (pears)	12/5/2019	December 2019 OSDF Inspection	15			
3561	Cell 4, east 6:1	Yes	Woody plant, several	12/5/2019	December 2019 OSDF Inspection	16			
3562	Cell 3, east 6:1	Yes	Woody plant (pear)	12/5/2019	December 2019 OSDF Inspection	17			
3563	Cell 2, east 6:1	Yes	Woody plant (pear)	12/5/2019	December 2019 OSDF Inspection	18			

No.	Location	GPS?	Maintenance Item Identified	Date Identified	Origin of Finding	Inspection Finding No.	Resolution	Date of Resolution	Comments
3564	Cell 2/3 boundary, east 6:1	Yes	Woody plant (pear)	12/5/2019	December 2019 OSDF Inspection	19			
3565	Cell 4, east 6:1, south end	Yes	Woody plant, several (pear)	12/5/2019	December 2019 OSDF Inspection	20			
3566	Cell 7, west 6:1	Yes	Woody vegetation (tree of heaven)	12/5/2019	December 2019 OSDF Inspection	21			
3567	Cell 3, east top	Yes	Callery pear, several	12/5/2019	December 2019 OSDF Inspection	22			
3568	Cell 2, east toe	Yes	Callery pear	12/5/2019	December 2019 OSDF Inspection	23			
3569	Cell 3, east toe	Yes	Callery pear	12/5/2019	December 2019 OSDF Inspection	24			
3570	Cell 4, east toe	Yes	Woody vegetation (callery pear)	12/5/2019	December 2019 OSDF Inspection	25			
3571	Cell 3, west 6:1, south end	Yes	Pear tree	12/5/2019	December 2019 OSDF Inspection	26			
3572	Cell 4, west 6:1	Yes	Pear trees, several south and west	12/5/2019	December 2019 OSDF Inspection	27			
3573	Cell 5, west 6:1	Yes	Pear tree	12/5/2019	December 2019 OSDF Inspection	28			
3574	Cell 8, southwest corner 6:1	Yes	Pear tree	12/5/2019	December 2019 OSDF Inspection	29			
3575	Cell 3, east 6:1	Yes	Pear tree	12/5/2019	December 2019 OSDF Inspection	30			

No.	Location	GPS?	Maintenance Item Identified	Date Identified	Origin of Finding	Inspection Finding No.	Resolution	Date of Resolution	Comments
3576	Cell 5, east 6:1, north end	No	Pear tree	12/5/2019	December 2019 OSDF Inspection	31			
3577	Cell 4, east 6:1	No	Pear trees (several)	12/5/2019	December 2019 OSDF Inspection	32			
3578	Cell 3/4 boundary, east 6:1	No	Honeysuckle, pear trees (many across cell face)	12/5/2019	December 2019 OSDF Inspection	33			
3579	Cell 8, south perimeter fence near south gate	Yes	Sign is crooked/falling	12/10/2019	December 2019 OSDF Inspection	34			
3580	Cell 6, west perimeter fence	Yes	Muskrat burrow	12/10/2019	December 2019 OSDF Inspection	35			
3581	Cell 1, north gate	Yes	Laminate peeling off of sign	12/10/2019	December 2019 OSDF Inspection	36			
3584	East property fence line access gate	No	Perimeter access gate V12 needs a "No trespassing" sign	12/3/2019	December 2019 point-specific institutional controls inspection	NA			
3585	Former railroad trestle	No	There is a "log jam" in Paddys Run below the trestle.	12/10/2019	December 2019 point-specific institutional controls inspection	NA			
3586	Outfall line	No	Sandbags around a manhole are deteriorating and need replaced	12/10/2019	December 2019 point-specific institutional controls inspection	NA			
3590	East of backwash basin	Yes	Large patch of teasel	1/15/2020	January 2020 quarterly field walkdown	4			
3600	Peninsula	Yes	Tree protection cages need removed	1/15/2020	January 2020 OSDF Inspection	14			
3602	Bank of drainage	Yes	Thistle	1/15/2020	January 2020 quarterly field walkdown	16			

No.	Location	GPS?	Maintenance Item Identified	Date Identified	Origin of Finding	Inspection Finding No.	Resolution	Date of Resolution	Comments
3603	West of well access road	No	Erosion rill outside the rip rap drainage	1/15/2020	January 2020 quarterly field walkdown	17			
3604	Ridge between ponds	No	Teasel	1/15/2020	January 2020 quarterly field walkdown	18			
3605	South of drainage	No	Teasel (large patch)	1/15/2020	January 2020 quarterly field walkdown	19			
3606	West of FPAW4	No	Phragmites	1/15/2020	January 2020 quarterly field walkdown	20			
3607	South edge of "Union" pond	No	Teasel (large patch)	1/15/2020	January 2020 quarterly field walkdown	21			
3615	Edge of road	Yes	Pear tree	3/5/2020	March 2020 quarterly field walkdown	1			
3616	Boardwalk - south end	Yes	Pear tree	3/5/2020	March 2020 quarterly field walkdown	2			
3619	In basin	Yes	Pear tree	3/5/2020	March 2020 quarterly field walkdown	5			
3623	Headwall	Yes	Erosion	3/5/2020	March 2020 quarterly field walkdown	9			
3624	North (west end) side of deer fence, outside of fence	Yes	Metal post inside shrub	3/5/2020	March 2020 quarterly field walkdown	10			
3625	West side of deer fence	Yes	Fence detached from poles and is sliding down	3/5/2020	March 2020 quarterly field walkdown	11			
3626	Southwest corner of deer fence	Yes	Hole in fence; metal posts in the ground not being used	3/5/2020	March 2020 quarterly field walkdown	12			

No.	Location	GPS?	Maintenance Item Identified	Date Identified	Origin of Finding	Inspection Finding No.	Resolution	Date of Resolution	Comments
3627	Southwest corner of deer fence	Yes	Pear tree; tree protection cage and metal post	3/5/2020	March 2020 quarterly field walkdown	13			
3628	Southeast corner of deer fence	Yes	Fencing sliding down poles	3/5/2020	March 2020 quarterly field walkdown	14			
3629	Across from "dance hall"	Yes	Tree protection cages need removed	3/5/2020	March 2020 quarterly field walkdown	15			
3630	Northeast face of deer fence	Yes	Split in fence	3/5/2020	March 2020 quarterly field walkdown	16			
3631	East face of deer fence	Yes	Fence sliding down poles	3/5/2020	March 2020 quarterly field walkdown	17			
3632	West face of deer fence	Yes	Fence sliding down poles; split in fence	3/5/2020	March 2020 quarterly field walkdown	18			
3633	West of basin	Yes	Pear tree	3/5/2020	March 2020 quarterly field walkdown	19			
3634	North of basin	Yes	Tree protection cage	3/5/2020	March 2020 quarterly field walkdown	20			Is this tree cage still being used?
3635	South of east/west drainage	Yes	Old tree fencing	3/5/2020	March 2020 quarterly field walkdown	21			Green flag with little holes
3636	Near split in trail	Yes	Pear tree	3/5/2020	March 2020 quarterly field walkdown	22			
3639	South of split, inside Sycamore Trail loop	No	Pear trees (several)	3/5/2020	March 2020 quarterly field walkdown	25			
3640	Southeast of Sycamore Trail loop	No	Pear trees (2)	3/5/2020	March 2020 quarterly field walkdown	26			

No.	Location	GPS?	Maintenance Item Identified	Date Identified	Origin of Finding	Inspection Finding No.	Resolution	Date of Resolution	Comments
3642	North of deer fence	No	Pear trees	3/5/2020	March 2020 quarterly field walkdown	28			
3643	Northwest of basin	No	Chicken wire	3/5/2020	March 2020 quarterly field walkdown	29			
3644	At trail intersection	No	Pear tree	3/5/2020	March 2020 quarterly field walkdown	30			
3645	Inside north end of trail loop	No	Pear tree	3/5/2020	March 2020 quarterly field walkdown	31			
3646	Along Sycamore Trail	No	Pear trees (2)	3/5/2020	March 2020 quarterly field walkdown	32			
3647	Along Sycamore Trail	No	Pear tree	3/5/2020	March 2020 quarterly field walkdown	33			
3649	South field by well house 32	No	Pear trees (several)	3/5/2020	March 2020 quarterly field walkdown	35			
3650	Field across from Lodge Pond overlook	No	Pear trees (several)	3/5/2020	March 2020 quarterly field walkdown	36			
3653	Basin inside Sycamore Trail loop	No	Pear tree	3/5/2020	March 2020 quarterly field walkdown	39			
3654	Southwest corner of deer fence	No	Open fence	3/5/2020	March 2020 quarterly field walkdown	40			
3656	North end of prairie	No	Pear tree	3/5/2020	March 2020 quarterly field walkdown	42			
3657	End of Paddys Run overlook	No	Pear tree	3/5/2020	March 2020 quarterly field walkdown	43			

No.	Location	GPS?	Maintenance Item Identified	Date Identified	Origin of Finding	Inspection Finding No.	Resolution	Date of Resolution	Comments
3658	West end of pond	No	Pear trees (several)	3/5/2020	March 2020 quarterly field walkdown	44			
3659	Trail intersection	No	Pear tree	3/5/2020	March 2020 quarterly field walkdown	45			
3660	South edge of pond	No	Pear trees (several)	3/5/2020	March 2020 quarterly field walkdown	46			
3661	Just inside north end of pine trees	No	Tree protection cages need removed	3/5/2020	March 2020 quarterly field walkdown	47			
3662	Top ridge of SWU	No	Pear trees (5+)	3/5/2020	March 2020 quarterly field walkdown	48			
3664	Basin inside Sycamore Trail loop	No	Pear trees (3+)	3/5/2020	March 2020 quarterly field walkdown	50			
3665	Basin inside Sycamore Trail loop	No	Pear trees (3+)	3/5/2020	March 2020 quarterly field walkdown	51			
3666	Southeast of Sycamore Trail loop	No	Pear trees (4+)	3/5/2020	March 2020 quarterly field walkdown	52			
3667	South of "dance hall"	No	Pear tree	3/5/2020	March 2020 quarterly field walkdown	53			
3668	Adjacent to road	No	Pear trees	3/5/2020	March 2020 quarterly field walkdown	54			
3670	South of deer fence	No	Pear trees (several)	3/5/2020	March 2020 quarterly field walkdown	56			
3671	Along west side of gravel road under power lines	No	Pear trees (several)	3/5/2020	March 2020 quarterly field walkdown	57			

No.	Location	GPS?	Maintenance Item Identified	Date Identified	Origin of Finding	Inspection Finding No.	Resolution	Date of Resolution	Comments
3672	Along main access road west of SWRB	No	Pear tree	3/5/2020	March 2020 quarterly field walkdown	58			
3673	Next to trail	No	Pear trees (several)	3/5/2020	March 2020 quarterly field walkdown	59			
3674	Northwest side of deer fence	No	Hole in fence	3/5/2020	March 2020 quarterly field walkdown	60			
3675	South side of deer fence	No	Hole in fence	3/5/2020	March 2020 quarterly field walkdown	61			
3676	Cell 6, west inner drainage	Yes	Cedar tree	3/5/2020	March 2020 OSDF Inspection	1			
3677	Cell 8, west outer drainage at road edge	Yes	Cedar tree	3/5/2020	March 2020 OSDF Inspection	2			
3678	Cell 8, west outer drainage at riprap edge	Yes	Cedar tree	3/5/2020	March 2020 OSDF Inspection	3			
3679	Cell 8, south toe along road edge	Yes	Brick	3/5/2020	March 2020 OSDF Inspection	4			
3680	Cell 7, east toe along road edge	Yes	Cedar tree	3/5/2020	March 2020 OSDF Inspection	5			
3681	Cell 3, east toe along road edge	Yes	Cedar tree	3/5/2020	March 2020 OSDF Inspection	6			
3682	Cell 3, east drainage at riprap edge	Yes	Cedar tree	3/5/2020	March 2020 OSDF Inspection	7			
3683	Cell 1, north drainage	No	Cedar trees (several)	3/5/2020	March 2020 OSDF Inspection	8			

No.	Location	GPS?	Maintenance Item Identified	Date Identified	Origin of Finding	Inspection Finding No.	Resolution	Date of Resolution	Comments
3686	West of slope bottom	No	Teasel monoculture	6/3/2020	June 2020 quarterly field walkdown	1			
3687	East of W5	No	Pear trees	6/3/2020	June 2020 quarterly field walkdown	2			
3688	East and southeast of W4	No	Pear trees	6/3/2020	June 2020 quarterly field walkdown	3			
3689	West of slope bottom	No	Teasel	6/3/2020	June 2020 quarterly field walkdown	4			
3690	East side of area, between wet areas	No	Teasel (patchy in low spots)	6/3/2020	June 2020 quarterly field walkdown	5			
3691	East edge of pines	No	Multiflora rose	6/3/2020	June 2020 quarterly field walkdown	6			
3692	South of Lodge Pond, bottom of west slope, west of W2	No	Multiflora rose (possibly)	6/3/2020	June 2020 quarterly field walkdown	7			
3693	Bottom of south slope, south of W9	No	Pear trees and thistle	6/3/2020	June 2020 quarterly field walkdown	8			
3694	West of slope bottom	No	Pear trees and thistle	6/3/2020	June 2020 quarterly field walkdown	9			
3695	West of north entrance gate, north of pines	No	Canada thistle	6/3/2020	June 2020 quarterly field walkdown	10	Herbicide applied	6/9/2020	
3696	North of north pines, along St. rt. 126	No	Area becoming inundated with honeysuckle	6/3/2020	June 2020 quarterly field walkdown	11			
3697	North end inside trail loop	No	Canada thistle	6/3/2020	June 2020 quarterly field walkdown	12	Herbicide applied	6/9/2020	

No.	Location	GPS?	Maintenance Item Identified	Date Identified	Origin of Finding	Inspection Finding No.	Resolution	Date of Resolution	Comments
3698	North of DO Building, south of pond	No	Honeysuckle and pear trees	6/3/2020	June 2020 quarterly field walkdown	13			
3699	East perimeter, south of well access road entrance	No	Bird box sild down post	6/3/2020	June 2020 quarterly field walkdown	14			
3700	South of WM1, east of road	No	Honeysuckle and pear trees	6/3/2020	June 2020 quarterly field walkdown	15			
3701	East edge of road	No	Teasel, honeysuckle, pear tree, autumn olive	6/3/2020	June 2020 quarterly field walkdown	16			
3702	East edge of road	No	Honeysuckle and pear trees	6/3/2020	June 2020 quarterly field walkdown	17			
3703	East of road in drainage	No	Teasel	6/3/2020	June 2020 quarterly field walkdown	18			
3704	W7	No	Phragmites	6/3/2020	June 2020 quarterly field walkdown	19			
3705	Berm of W1 and W6	No	Honeysuckle	6/3/2020	June 2020 quarterly field walkdown	20			
3706	East edge of W1	No	Honeysuckle, pear trees, autumn olive shrubs and teasel	6/3/2020	June 2020 quarterly field walkdown	21			
3707	West side of basins and berms between W2 and W3, and W3 and W4	No	Honeysuckle, pear trees, autumn olive shrubs and teasel	6/3/2020	June 2020 quarterly field walkdown	22			
3708	West side of W1	No	Phragmites	6/3/2020	June 2020 quarterly field walkdown	23			
3709	West side of W6	No	Phragmites, teasel, canada thistle	6/3/2020	June 2020 quarterly field walkdown	24			

No.	Location	GPS?	Maintenance Item Identified	Date Identified	Origin of Finding	Inspection Finding No.	Resolution	Date of Resolution	Comments
3710	Northwest corner of W7	No	Pear trees and honeysuckle	6/3/2020	June 2020 quarterly field walkdown	25			
3711	Cell 1, north drainage, northwest corner	No	Teasel, pear tree, honeysuckle, cedar tree	6/3/2020	June 2020 OSDF Inspection	1			
3712	Cell 1, north drainage bottom at former gate location	No	Honeysuckle	6/3/2020	June 2020 OSDF Inspection	2			
3713	Cell 1, northeast corner drainage	No	Cedar, honeysuckle, pear	6/3/2020	June 2020 OSDF Inspection	3			
3714	Cell 3, east drainage at fence	No	Honeysuckle	6/3/2020	June 2020 OSDF Inspection	4			
3715	Cell 3/4 boundary, east drainage at fence	No	Pear tree	6/3/2020	June 2020 OSDF Inspection	5			
3716	Cell 4, east drainage at fence	No	Thistle and woody vegetation	6/3/2020	June 2020 OSDF Inspection	6	Herbicide applied	6/12/2020	
3717	Cell 4, east drainage at fence	No	Canada thistle	6/3/2020	June 2020 OSDF Inspection	7	Herbicide applied	6/12/2020	
3718	Cell 5, east drainage at fence	No	Pear trees	6/3/2020	June 2020 OSDF Inspection	8			
3719	Cell 6, west edge of road	No	Pear trees and honeysuckle	6/3/2020	June 2020 OSDF Inspection	9			
3720	Cell 1, east and west slopes	No	Scattered woody vegetation	6/3/2020	June 2020 OSDF Inspection	10			
3721	Cell 2, east and west slopes	No	Scattered woody vegetation	6/3/2020	June 2020 OSDF Inspection	11			

No.	Location	GPS?	Maintenance Item Identified	Date Identified	Origin of Finding	Inspection Finding No.	Resolution	Date of Resolution	Comments
3722	Cell 3, east and west slopes	No	Scattered woody vegetation	6/3/2020	June 2020 OSDF Inspection	12			
3723	Cell 4, east and west slopes	No	Scattered woody vegetation	6/3/2020	June 2020 OSDF Inspection	13			
3724	Cell 5, west side of road	No	Woody vegetation	6/3/2020	June 2020 OSDF Inspection	14			
3725	Cell 5, west side of road	No	Woody vegetation	6/3/2020	June 2020 OSDF Inspection	15			
3726	Cell 6, toe of slope	No	Woody vegetation	6/3/2020	June 2020 OSDF Inspection	16			
3727	Cell 6, west drainage	No	Woody vegetation, thistle, teasel	6/3/2020	June 2020 OSDF Inspection	17			
3728	Cell 8, east toe and drainage	No	Teasel	6/3/2020	June 2020 OSDF Inspection	18			
3729	S51, north property perimeter	No	Vegetation blocking sign	6/3/2020	June 2020 point-specific institutional controls inspection	NA			
3730	S59, S60, S61, east property perimeter	No	Vegetation blocking signs	6/9/2020	June 2020 point-specific institutional controls inspection	NA			

This page intentionally left blank