



Department of Energy
Washington, DC 20585

PROD 7569

June 26, 2017

Mr. David Seely
U.S. Environmental Protection Agency
Region 5 (SR-6J)
77 W. Jackson Blvd.
Chicago, IL 60604-3590

Mr. Thomas A. Schneider
Ohio Environmental Protection Agency
401 East 5th Street
Dayton, Ohio 45402

Dear Mr. Seely and Mr. Schneider:

SUBJECT: Transmittal of the June 2017 Fernald Quarterly Inspection Report

This letter is the June 2017 quarterly inspection report for the Fernald Preserve at the Fernald, Ohio, Site. Inspections are conducted as directed by the *Comprehensive Legacy Management and Institutional Controls Plan* (LMICP) (LMS/FER/S03496). This letter also fulfills the reporting requirements specified in the Environmental Covenant, which is Appendix D of the *Consent Decree Resolving Ohio's Natural Resource Damage Claim Against DOE*. The inspections confirm that the activity and use limitations for the Fernald Preserve remain in place and are being complied with.

This June inspection report includes results from two On-Site Disposal Facility (OSDF) inspections. The first was conducted on March 29 and was a walk-down of cell caps 7 and 8, following a prescribed burn of those two caps. The second was the regularly scheduled quarterly OSDF inspection conducted on June 7. This report also includes results from the site inspection conducted from June 7 through June 12. As stated in the 2017 LMICP, site inspections consist of two components: point-specific institutional control inspections and field walk-downs. All field walk-downs are scheduled during the dormant-vegetation months of November through April; therefore, no field walk-downs were included as part of this inspection. The results included in this report are for the following inspections:

INSPECTION TYPE	DATE	PARTICIPANTS
OSDF Inspection	March 29, 2017	Navarro
OSDF Inspection	June 7, 2017	Ohio Environmental Protection Agency (Ohio EPA), Ohio Department of Health and Navarro
Point-specific Institutional Controls Inspection	June 7–12, 2017	Navarro

Findings from the point-specific institutional controls inspection are documented on the attached *Fernald Preserve Institutional Control Inspection* (LMS 3047FER) form. Findings from the OSDF inspections are recorded on the attached *Fernald Preserve OSDF Walk-down Inspection Summary* (LMS 3045FER) for each inspection and on the associated maps (Figures 1 and 2).



Photographs of the OSDF and the surrounding area were taken to accompany the June 2017 OSDF inspection and are also included in this report. Photographs of individual findings are sometimes taken with global positioning system (GPS) -enabled cameras. This allows for easier location of the findings for correction or maintenance. When GPS-enabled cameras are used, the photograph files are listed on the walk-down inspection summaries, and they are available upon request.

Findings from Site Inspections

Point-specific institutional controls were inspected from June 7 through June 12. The presence of vegetative debris at the 60-inch culvert in the main drainage corridor was observed. Debris was built up on the north side (upstream) of the north grate and on the north side (inside the culvert and upstream) of the south grate. This vegetation build up, both woody and herbaceous, appears to be from beaver activity in the area. Water flow through the culvert is greatly impeded. Navarro staff removed the vegetation at the grates. They will also evaluate the fencing that was installed in 2015 around the 60-inch culvert inlet to see if repairs are needed. The original grating remains in place and is functional.

Also identified during the point-specific institutional controls inspection were several perimeter signs that were blocked by tree branches, shrubs or other vegetation. Field personnel have cleared vegetation to ensure that signs are visible.

DOE is committed to providing quarterly summary numbers regarding debris findings. One hundred-fourteen pieces of debris were surveyed since the last inspection report (March 2017). One had fixed contamination. All debris items were properly disposed. Surveyed debris is a combination of debris from inspection follow-up, discoveries during construction activities, and casual observation while in the field.

Findings from OSDF Inspection

The OSDF prescribed burn follow-up inspection of cell caps 7 and 8 took place on March 29 (Figure 1). The inspection included a walk-over of both cell caps. Findings included debris, animal burrows and invasive vegetation. Inspecting the caps following a burn allows for a more thorough inspection of the cap, as all vegetation and thatch have been removed. Findings such as debris, animal burrows, erosion, and rocks, are more visible and easier to identify. Under normal circumstances, the vegetation on the cap obstructs the view of the cap surface.

The June 2017 OSDF inspection took place on June 7 and included a walk-down inspection of the OSDF toe, drainages, and fence line (Figure 2). There were numerous findings of unwanted vegetation, both herbaceous and woody, in the drainages and along the toe. Each individual vegetation finding is not identified on the map. Herbicide will be applied to all unwanted vegetation. There are also a couple of animal burrows that need repaired as well as some erosion on the access road and at an old animal burrow.

Findings from all of these inspections have been added to the site maintenance database and are included in the *Fernald Maintenance and Repair Action Items Summary*; a printout is enclosed. Resolution of the findings is then tracked through the database. Items on the list that have been resolved since the previous inspection report are included in the report with the date and

Mr. David Seely
Mr. Thomas Schneider
Page 3

description of the resolution. Previously reported items that have been resolved are removed from the list. The resolution of older findings can be found in previous quarterly inspection reports.

The remaining fiscal year 2017 inspection schedule is as follows:

DATE	INSPECTION TYPE	REPORT DATE
September 7, 2017	OSDF Toe, Point-specific Institutional Controls	September 29, 2017

If you have any questions or require additional information, please call me at (513) 648-3333. Please send any correspondence to my attention at:

U.S. Department of Energy
Office of Legacy Management
10995 Hamilton-Cleves Hwy.
Harrison, OH 45030

Sincerely,

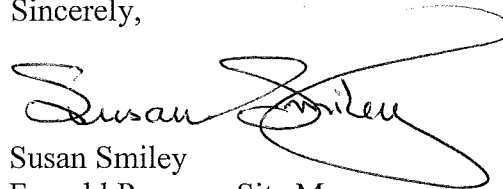

Susan Smiley
Fernald Preserve Site Manager
DOE-LM-20.2

Enclosure

cc w/enclosure:

M. Rubadue, ODH
T. Schneider, OEPA (three copies of enclosure)
Project Record File FER 115.02.05(A) (M. Korte)
Administrative Records (thru M. Korte)

cc w/o enclosure:

(electronic)
G. Hooten, DOE-LM
T. Smith Taylor, DOE-LM
B. Hertel, Navarro
J. Homer, Navarro
L. McHenry, Navarro

Fernald Preserve Institutional Control Inspection

Date June 2017 Inspector Navarro Area Institutional Controls

Institutional Control	Type of Finding (See Definitions Page)				Description	Photo? (File No.)	Follow Up		
	Signage	Barrier	Groundskeeping	Other			Corrected	Maintenance Req'd	Cont. Observation
Access Points									
South Access					NO FINDINGS				
North Access					NO FINDINGS				
Eco Park					NO FINDINGS				
Forest Demo					NO FINDINGS				
Perimeter Authorized Vehicle Access									
					NO FINDINGS				
Perimeter Signage									
S7, S9, S11, S14, S17, S19, S45, S48, S49, S61	X				Signs are obscured from view by vegetation		X		
Fencing									
CAWWT					NO FINDINGS				
OSDF	X				One radiological sign fell off of fence and needs replaced			X	
Utility					NO FINDINGS				
Trestle					NO FINDINGS				
Interior Authorized Vehicle Access									
					NO FINDINGS				
Buildings and Structures									
Communication Building					NO FINDINGS				
Dissolved Oxygen Building					NO FINDINGS				
Restoration Storage Shed					NO FINDINGS				
Other IC									
60-Inch Culvert				X	Build-up of woody and herbaceous vegetation on upstream side of both the north and south grates		X		
Uncertified Areas					NO FINDINGS				
Roads and Parking Areas					NO FINDINGS				
Trails and Overlooks					NO FINDINGS				

Additional Notes

Fernald Preserve Institutional Control Inspection (continued)

Date June 2017 Inspector Navarro Area Institutional Controls

NONE

U.S. Department of Energy Office of Legacy Management

Fernald Preserve OSDF Walkdown Inspection Summary

Beginning: 03/29/2017

Ending: 03/29/2017

Area(s): OSDF Cell Caps 7 and 8

Inspector(s): Navarro

Map No.	Location	GPS?	Type of Finding	Description	Photo (See Additional Notes)
1	Cell 7, top west 6:1 slope	Yes	Debris	Debris - glazed tile and concrete	03292017_40_01
2	Cell 8, south face	Yes	Rock	Several, 2 flagged	03292017_40_02
3	Cell 8, west toe	No	Other	Matting	
4	Cell 8, middle of west slope	No	Biointrusion	Appears animal was digging for rodents	
5	Cell 7, middle west slope	No	Vegetation	Teasel patch	
6	Cell 8, south toe	No	Debris	Brick	
7	Cell 8, east slope	No	Debris	Asphalt	
8	Cell 8, east slope	No	Vegetation	Teasel patch	
9	Cell 7, east slope	No	Vegetation	Teasel patch	
10	Cell 7, west side near top	Yes	Debris	2 bricks	03292017_42_01; 03292017_42_02
11	Cell 8, south east slope	Yes	Rock	2 rocks, flag between them	03292017_42_03; 03292017_42_04
12	Cell 8, top	No	Vegetation	Teasel	
13	Cell 8, top	No	Vegetation	Teasel	

Map No.	Location	GPS?	Type of Finding	Description	Photo (See Additional Notes)
14	Cell 7, west slope near top	Yes	Biointrusion	Animal burrow	03292017_43_01
15	Cell 8, west slope	Yes	Biointrusion	Animal burrow	03292017_41_01
16	Cell 7, top	No	Vegetation	Teasel	
17	Cell 7, east slope at south end	No	Vegetation	Teasel	

Additional Notes

1.) This inspection was a walk-down of Cell Caps 7 and 8, following a prescribed burn of the same area on March 9, 2017. 2.) The files listed in the "Photo" column are photographs of the individual findings and are used for field identification. The photographs are available upon request.

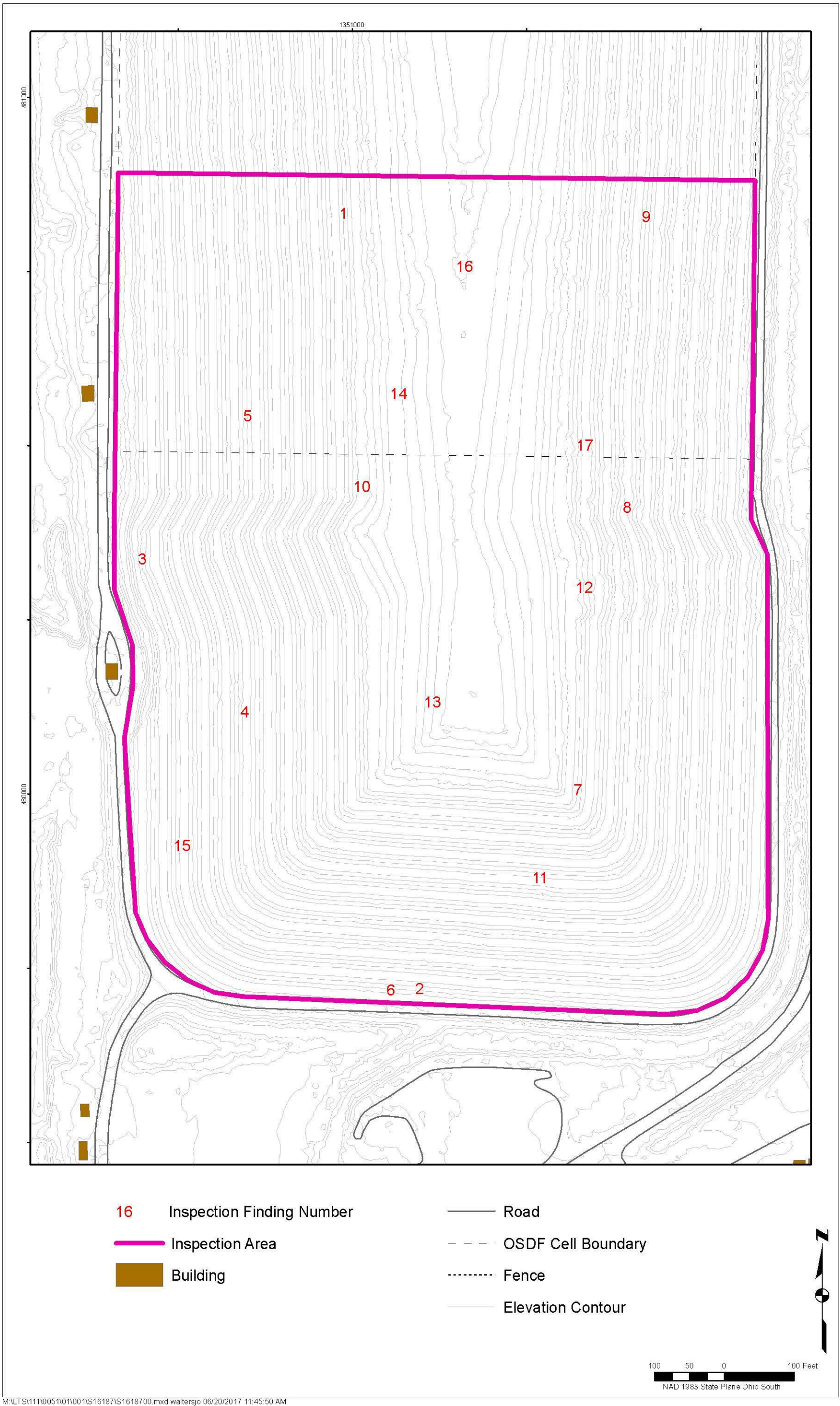

Figure 1
March 29, 2017 OSDF Cells 7 and 8 Post Burn Inspection Findings

U.S. Department of Energy Office of Legacy Management

Fernald Preserve OSDF Walkdown Inspection Summary

Beginning: 06/07/2017

Ending: 06/07/2017

Area(s): OSDF Toe, Drainage and Fence Line

Inspector(s): Navarro, Ohio EPA, ODH

Map No.	Location	GPS?	Type of Finding	Description	Photo (See Additional Notes)
1	Cell 1, west end of north fenceline	Yes	Signage	Radiological control sign fell off fence	06072017_41_02
2	Cell 8, gravel roadway along south face	No	Erosion	The gravel road is developing an erosion rill, washing gravel into south drainage	
3	Cell 7/8 boundary at west toe	No	Biointrusion	2 goundhog holes	
4	Cell 8, west toe at riprap	No	Erosion	Erosion at old groundhog hole	
5	Cell 8, west toe	No	Rock	Rocks	
6	Cell 8, west toe	Yes	Biointrusion	Groundhog hole	06072017_44_01
NA	Outer drainage	No	Vegetation	Invasive herbaceous and unwanted woody vegetation	
NA	West inner drainage	No	Vegetation	Invasive herbaceous and unwanted woody vegetation	
NA	Toe of OSDF	No	Vegetation	Invasive herbaceous and unwanted woody vegetation	

Additional Notes

The files listed in the "Photo" column are photographs of the individual findings and are used for field identification. The photographs are available upon request.

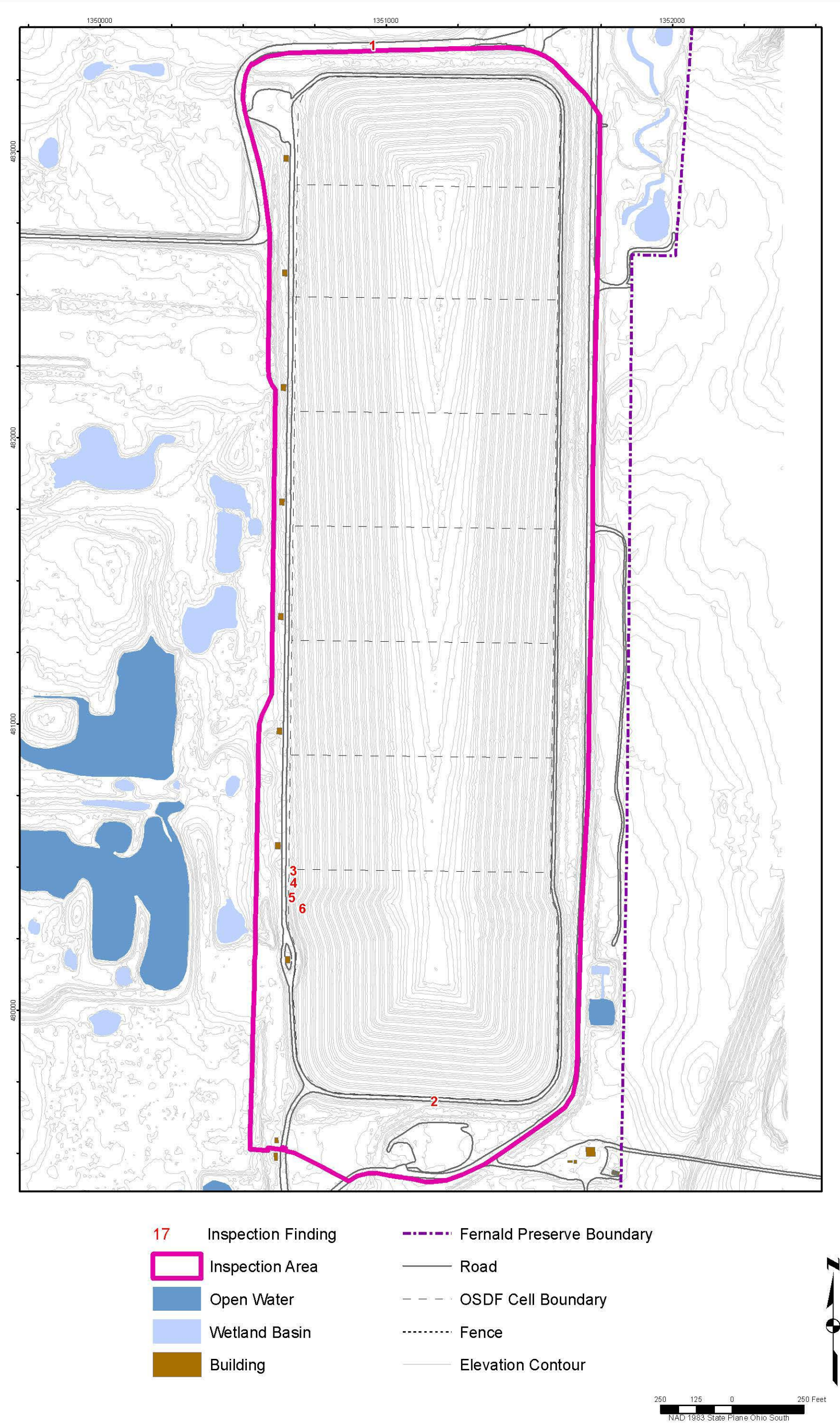

M:\LTS\111\005\1\0\1\00\1\S\16517\S\1651700.mxd waltersjo 06/20/2017 11:31:11 AM

Figure 2
June 7, 2017 OSDF Inspection Findings

FERNALD PRESERVE

On-Site Disposal Facility Inspection Photographs

June 2017



**U.S. DEPARTMENT OF
ENERGY**

Legacy
Management



IMGP6196

East Face Cell 1



IMGP6173

West Face Cell 1



IMGP6199

North Face Cell 1



IMGP6198

North Drainage (looking west)



IMGP6195

East Face Cell 2



IMGP6174

West Face Cell 2



IMGP6194

East Face Cell 3



IMGP6175

West Face Cell 3



IMGP6192

East Face Cell 4



IMGP6176

West Face Cell 4



IMGP6191

East Face Cell 5



IMGP6178

West Face Cell 5



IMGP6190

East Face Cell 6



IMGP6179

West Face Cell 6



IMGP6188

East Face Cell 7



IMGP6180

West Face Cell 7



IMGP6187

East Face Cell 8



IMGP6184

West Face Cell 8



IMGP6185

South Face Cell 8



IMGP6186

South Drainage (looking west)



IMGP6189

East Drainage Cell 7 (looking south)



IMGP6193

East Drainage Cell 4 (looking south)



IMGP6197

East Drainage Cell 1 (looking south)



IMGP6181

West Inner Drainage Cell 7 (looking south)



IMGP6177

West Inner Drainage Cell 4 (looking south)



IMGP6200

West Inner Drainage Cell 1 (looking south)



IMGP6201

West Outer Drainage Cell 1 (looking south)



IMGP6183

West Outer Drainage Cell 8 (looking south)



IMGP6182

West Outer Drainage Cell 8 (looking north)

FERNALD PRESERVE MAINTENANCE AND REPAIR ACTION ITEMS SUMMARY
JUNE 2017 UPDATE

No.	Location	GPS?	Maintenance Item Identified	Date Identified	Origin of Finding	Inspection Finding No.	Resolution	Date of Resolution	Comments
1013	South side of south pines deer fence	No	Honeysuckle	6/2/2010	June 2010 quarterly field walkdown	45			Large-scale woody invasives are addressed on a prioritized schedule
1291	North pines	No	Honeysuckle along woodline	9/7/2011	September 2011 quarterly field walkdown	10			Large-scale woody invasives are addressed on a prioritized schedule
1466	Shingle Oak Trail	No	Teasel	6/5/2012	June 2012 quarterly field walkdown	24			
1468	Drainage area	No	Garlic mustard	6/5/2012	June 2012 quarterly field walkdown	26			
1671	Behind Valve House (VH) 8	No	Culvert pipe	3/12/2013	March 2013 OSDF Inspection	HS13	No action required at this time; continue to monitor	4/13/2017	
1739	East bank Paddys Run	No	Multiflora rose	6/6/2013	June 2013 quarterly field walkdown	52			
1774	Hill along State Route 126	No	Teasel and honeysuckle	9/4/2013	September 2013 quarterly field walkdown	3			Large-scale woody invasives are addressed on a prioritized schedule
1781	Hill along State Route 126	No	Honeysuckle	9/4/2013	September 2013 quarterly field walkdown	10			Large-scale woody invasives are addressed on a prioritized schedule
1788	WM1 W4 between pond and swale	No	Honeysuckle	9/4/2013	September 2013 quarterly field walkdown	17			
2231	North of east end of WM2	No	Stand of teasel	12/4/2014	December 2014 quarterly field walkdown	1			
2232	East and north of service road, northwest of WM2	No	Pear tree	12/4/2014	December 2014 quarterly field walkdown	2			

No.	Location	GPS?	Maintenance Item Identified	Date Identified	Origin of Finding	Inspection Finding No.	Resolution	Date of Resolution	Comments
2235	West of north/south section of Hickory Trail	No	Autumn olive	12/4/2014	December 2014 quarterly field walkdown	5			
2272	Written description of location not provided	No	Erosion	1/14/2015	January 2015 quarterly field walkdown	27			September 2015 - Some stabilization starting; grass is growing
2276	Former waste pits area (FWP) W7	No	Erosion, hole	1/14/2015	January 2015 quarterly field walkdown	31			
2286	North of Southern Waste Units (SWU) near SSOD	No	Erosion	2/10/2015	February 2015 quarterly field walkdown	3			
2293	Between trail and deer fence west of trail	No	Phragmites	2/10/2015	February 2015 quarterly field walkdown	10			
2322	East perimeter at fence	No	Metal pipe in ground; hole under fence	3/11/2015	March 2015 OSDF Inspection	12	Cut off pipe; no further action required; continue to monitor	4/14/2017	Cut off pipe; hole to be addressed
2331	South perimeter field between fence and gravel road	No	Field of bull thistle	3/11/2015	March 2015 OSDF Inspection	20			
2346	W4 swale	No	Honeysuckle	3/12/2015	March 2015 quarterly field walkdown	2			Large-scale woody invasives are addressed on a prioritized schedule
2353	Northwest of power line tower along ditch	No	Fresh erosion on bank possibly from muskrats	3/12/2015	March 2015 quarterly field walkdown	9			
2358	Monitoring Wells 2431 and 3431	No	Water collecting around well pads; terrain needs altered to drain surface water away from wells	3/12/2015	March 2015 quarterly field walkdown	14			
2413	East perimeter road at Cell 1/2 boundary	No	Honeysuckle	6/4/2015	June 2015 OSDF Inspection	42	Herbicide applied	6/5/2017	
2461	Across from VH 5	No	Honeysuckle	6/3/2015	June 2015 OSDF Inspection	NA	Herbicide applied	6/20/2017	Finding not identified on map; all woody and invasive herbaceous vegetation on the cell cap and west inner drainage were treated with herbicide

No.	Location	GPS?	Maintenance Item Identified	Date Identified	Origin of Finding	Inspection Finding No.	Resolution	Date of Resolution	Comments
2478	East toe of Cell 3 near Cell 2/3 boundary	No	Canada thistle	9/2/2015	September 2015 OSDF Inspection	14	Herbicide applied	6/6/2017	
2479	East toe of Cell 3 near Cell 3/4 boundary	No	Canada thistle	9/2/2015	September 2015 OSDF Inspection	15	Herbicide applied	6/6/2017	
2496	East perimeter fence at Cell 8	No	Hole under fence	9/3/2015	September 2015 OSDF Inspection	32	No action required at this time; continue to monitor	4/13/2017	
2501	West fence at Cell 8	No	Honeysuckle growing into fence	9/3/2015	September 2015 OSDF Inspection	37			
2502	West drain at Cell 8	No	Teasel	9/3/2015	September 2015 OSDF Inspection	38			
2546	Cell 3, west slope, near toe	No	Teasel patches	12/2/2015	December 2015 OSDF Inspection	37			
2556	Cell 3, east slope, near toe	No	Thistle and black matting	12/2/2015	December 2015 OSDF Inspection	47	Herbicide applied	6/6/2017	
2615	Cell 3, east slope	No	Erosion/burrow	12/2/2015	December 2015 OSDF Inspection	106			
2617	Cell 3, west slope, near toe, near midpoint	No	Musk and bull thistle patches	12/2/2015	December 2015 OSDF Inspection	108			
2638	Cell 2, west drain, next to fence	No	Unknown grass (invasive) and teasel	12/2/2015	December 2015 OSDF Inspection	129			
2639	Cell 3, west drain, next to fence	No	Teasel and cedar	12/2/2015	December 2015 OSDF Inspection	130			The woody vegetation was cut and herbicide applied on 12/10/2015, but the herbaceous vegetation was not treated
2642	Cell 5, west drain, behind VH 5	No	Teasel	12/2/2015	December 2015 OSDF Inspection	133			

No.	Location	GPS?	Maintenance Item Identified	Date Identified	Origin of Finding	Inspection Finding No.	Resolution	Date of Resolution	Comments
2644	Cell 7, west drain, behind VH 7	No	Teasel	12/2/2015	December 2015 OSDF Inspection	135			
2648	Cell 2, west slope, near midpoint	No	Thistle	12/2/2015	December 2015 OSDF Inspection	139			
2649	Cell 3, west slope, near midpoint	No	Large patch of thistle	12/2/2015	December 2015 OSDF Inspection	140			
2659	At base of hill on west side	No	Old cages	12/8/2015	December 2015 quarterly field walkdown	6			
2673	South of east/west drainage	No	Widespread teasel	1/28/2016	January 2016 quarterly field walkdown	6			
2675	Northwest of "serpent" wetland	No	Disturbed soil with gravel	1/28/2016	January 2016 quarterly field walkdown	8			
2695	Pit 3	No	Posts and wire fence need removed (tree cages)	1/28/2016	January 2016 quarterly field walkdown	25			
2710	In the pines, just east of the east branch of the Shingle Oak Trail	No	Old cages need removed	2/23/2016	February 2016 quarterly field walkdown	10	Pulled and removed cages	4/13/2017	
2712	Slope east of drainage that flows north from off site	No	Old deer cages need removed	2/23/2016	February 2016 quarterly field walkdown	12			
2713	West edge of west branch of Shingle Oak Trail at prairie pocket	No	Teasel	2/23/2016	February 2016 quarterly field walkdown	13			
2714	East edge of prairie strip north of boardwalk	No	Teasel	2/23/2016	February 2016 quarterly field walkdown	14			
2725	West side of silos ponds	No	Teasel across area	2/23/2016	February 2016 quarterly field walkdown	25			

No.	Location	GPS?	Maintenance Item Identified	Date Identified	Origin of Finding	Inspection Finding No.	Resolution	Date of Resolution	Comments
2727	Above concrete slab wall	No	Teasel	2/23/2016	February 2016 quarterly field walkdown	27			
2728	SWU - south of wall, north of trail	No	Teasel	2/23/2016	February 2016 quarterly field walkdown	28			
2729	SWU - south edge of trail	No	Teasel	2/23/2016	February 2016 quarterly field walkdown	29			
2730	SWU - inside trail loop	No	Teasel	2/23/2016	February 2016 quarterly field walkdown	30			
2731	SWU - inside trail loop, south side of basin	No	Teasel	2/23/2016	February 2016 quarterly field walkdown	31			
2732	Northwest of substation	No	Teasel	2/23/2016	February 2016 quarterly field walkdown	32			
2735	North of the pines just east of north access road	No	Old cages	3/2/2016	March 2016 quarterly field walkdown	2			
2745	Cell 3/4 boundary along fence	No	Cedar	3/2/2016	March 2016 OSDF Inspection	2			
2747	East drain at Cell 3 along fence	No	Trash	3/2/2016	March 2016 OSDF Inspection	4	No action required at this time	4/4/2017	Unable to locate
2749	At fence between VH 3 and 4	No	Cedar	3/2/2016	March 2016 OSDF Inspection	6			
2775	Cell 8, on west edge of road at southwest corner	No	Teasel patch growing in riprap	6/1/2016	June 2016 OSDF Inspection	6			
2776	Cell 1, east fenceline	No	Animal burrow under the fence	6/1/2016	June 2016 OSDF Inspection	7	No action required at this time; continue to monitor	4/13/2017	

No.	Location	GPS?	Maintenance Item Identified	Date Identified	Origin of Finding	Inspection Finding No.	Resolution	Date of Resolution	Comments
2788	Cell 8, west toe	No	Cedar tree in riprap	6/1/2016	June 2016 OSDF Inspection	19	Herbicide applied	5/30/2017	
2789	Cell 8, in riprap near valve house	No	Various woody vegetation in riprap	6/1/2016	June 2016 OSDF Inspection	20	Herbicide applied	5/30/2017	
2790	Cell 7, west toe	No	Various woody vegetation in riprap	6/1/2016	June 2016 OSDF Inspection	21	Herbicide applied	5/31/2017	
2792	Cell 6, west toe in riprap	No	Woody vegetation	6/1/2016	June 2016 OSDF Inspection	23	Herbicide applied	6/19/2017	
2801	North perimeter of Fernald Preserve	No	Perimeter sign S46 needs branches and brush cut away	6/2/2016	June 2016 point-specific institutional controls inspection	NA	Vegetation cleared from sign	5/10/2017	
2806	Cell 6, west inner drainage	No	Woody vegetation	9/6/2016	September 2016 OSDF Inspection	5	Herbicide applied	6/19/2017	
2807	Cell 8, west inner drainage	No	Woody vegetation throughout drainage	9/6/2016	September 2016 OSDF Inspection	6	Herbicide applied	5/30/2017	
2812	Cell 1, north toe at reasearch well	No	Survey marker, used to indicate location of well, is down	9/6/2016	September 2016 OSDF Inspection	11	Survey marker replaced	4/18/2017	
2818	Cell 3, west toe	No	Sandy dirt pile	9/6/2016	September 2016 OSDF Inspection	17			
2824	Cell 4, west toe, north end	No	Cherry tree	9/6/2016	September 2016 OSDF Inspection	23	Herbicide applied	6/21/2017	
2825	Cell 4, west toe, near VH about 5 feet up slope	No	Callery pear	9/6/2016	September 2016 OSDF Inspection	24	Herbicide applied	6/21/2017	
2826	Cell 6, west toe, north end	No	Honeysuckle	9/6/2016	September 2016 OSDF Inspection	25	Herbicide applied	6/16/2017	

No.	Location	GPS?	Maintenance Item Identified	Date Identified	Origin of Finding	Inspection Finding No.	Resolution	Date of Resolution	Comments
2827	Cell 8, west toe	No	Groundhog hole	9/6/2016	September 2016 OSDF Inspection	26	Animal burrow filled	6/15/2017	
2850	Cell 8, west drainage, southwest corner	No	Hole under fencing	9/6/2016	September 2016 OSDF Inspection	49	No action required at this time; continue to monitor	4/13/2017	
2852	S4 along Willey Rd. near rainbow bridge	No	Weeds need trimmed away from sign/posts.	9/6/2016	September 2016 point-specific institutional controls inspection	NA	Vegetation cleared from sign	5/10/2017	
2853	S5 along Willey Rd. near rainbow bridge	No	Weeds need trimmed away from sign/post	9/6/2016	September 2016 point-specific institutional controls inspection	NA	Vegetation cleared from sign	5/10/2017	
2854	S6 along Willey Rd. at Paddys Run Rd. intersection	No	Weeds need trimmed away from sing/post	9/6/2016	September 2016 point-specific institutional controls inspection	NA	Vegetation cleared from sign	5/10/2017	
2855	By Pond	Yes	Old coverboards around pond need to be removed	12/7/2016	December 2016 quarterly field walkdown	1	No action required at this time; coverboards are used by Community Relations staff	6/21/2017	Camera L14643
2863	South side of deer fence, along Hickory Trail	Yes	Hole in deer fence	12/7/2016	December 2016 quarterly field walkdown	9	Deer fence repaired	4/3/2017	Camera L14641
2865	In ditch south of trail	No	Top of car battery and trash	12/7/2016	December 2016 quarterly field walkdown	11	Removed trash	4/3/2017	
2867	West side of fence	No	Hole in deer fence	12/7/2016	December 2016 quarterly field walkdown	13			
2868	Drainage south of Duke Energy station	Yes	Concrete	12/7/2016	December 2016 quarterly field walkdown	14	Free released; however, abandoned in place due to large size	4/19/2017	Camera L14641
2871	Cell 4, west face	Yes	Rock	12/1/2016	December 2016 OSDF Inspection	1			Camera L14641
2872	Cell 8, west toe	Yes	Groundhog burrow	12/1/2016	December 2016 OSDF Inspection	2	Animal burrow filled	6/15/2017	Camera L14644

No.	Location	GPS?	Maintenance Item Identified	Date Identified	Origin of Finding	Inspection Finding No.	Resolution	Date of Resolution	Comments
2873	West perimeter fence at Cell 8	Yes	Animal burrow under fence	12/1/2016	December 2016 OSDF Inspection	3	No action required at this time; continue to monitor	4/14/2017	Camera L14643
2874	West perimeter fence at north end of Cell 8	Yes	Animal burrow under fence	12/1/2016	December 2016 OSDF Inspection	4	No action required at this time; continue to monitor	4/14/2017	Camera L14643
2875	West perimeter fence at Cell 7	Yes	Burrow under fence	12/1/2016	December 2016 OSDF Inspection	5	No action required at this time; continue to monitor	4/14/2017	Camera L14643
2876	West perimeter fence at Cell 6	Yes	Tree in fence	12/1/2016	December 2016 OSDF Inspection	6			Camera L14643
2877	West perimeter at north end of Cell 6	Yes	Damaged fence post	12/1/2016	December 2016 OSDF Inspection	7	No action required at this time	4/14/2017	Camera L14643
2878	West perimeter fence behind VH 3	Yes	Animal burrow	12/1/2016	December 2016 OSDF Inspection	8	No action required at this time; continue to monitor	4/14/2017	Camera L14643
2879	West outer drainage at Cell 2	Yes	Standing water in drainage	12/1/2016	December 2016 OSDF Inspection	9	No action required at this time; continue to monitor	4/14/2017	
2880	North perimeter fence	Yes	Animal burrow under fence	12/1/2016	December 2016 OSDF Inspection	10	No action required at this time; continue to monitor	4/14/2017	Camera L14643
2881	North perimeter fence	Yes	Animal burrow under fence	12/1/2016	December 2016 OSDF Inspection	11	No action required at this time; continue to monitor	4/14/2017	Camera L14643
2882	East perimeter fence at Cell 1	Yes	Animal burrow under fence	12/1/2016	December 2016 OSDF Inspection	12	No action required at this time; continue to monitor	4/14/2017	Camera L14643
2883	East perimeter fence at Cell 3	Yes	Animal burrow under fence	12/1/2016	December 2016 OSDF Inspection	13	No action required at this time; continue to monitor	4/14/2017	Camera L14643
2884	East perimeter fence at Cell 5	Yes	Animal burrow under fence	12/1/2016	December 2016 OSDF Inspection	14	No action required at this time; continue to monitor	4/14/2017	Camera L14643

No.	Location	GPS?	Maintenance Item Identified	Date Identified	Origin of Finding	Inspection Finding No.	Resolution	Date of Resolution	Comments
2885	Across Cell 1 cap	No	Scattered invasive woody and herbaceous vegetation	12/1/2016	December 2016 OSDF Inspection	15	Herbicide applied	6/5/2017	Numerous findings were consolidated into one finding
2886	Across Cell 2 cap	No	Scattered invasive woody and herbaceous vegetation	12/1/2016	December 2016 OSDF Inspection	16			Numerous findings were consolidated into one finding
2887	Across Cell 3 cap	No	Scattered invasive woody and herbaceous vegetation	12/1/2016	December 2016 OSDF Inspection	17			Numerous findings were consolidated into one finding
2888	Across Cell 4 cap	No	A few invasive woody and herbaceous vegetation	12/1/2016	December 2016 OSDF Inspection	18	Herbicide applied	6/21/2017	A few findings were consolidated into one finding
2889	Across Cell 5 cap	No	Scattered invasive woody and herbaceous vegetation	12/1/2016	December 2016 OSDF Inspection	19	Herbicide applied	6/20/2017	A few findings were consolidated into one finding
2890	Across Cell 6 cap	No	Scattered invasive woody and herbaceous vegetation	12/1/2016	December 2016 OSDF Inspection	20	Herbicide applied	6/19/2017	A few findings were consolidated into one finding
2893	Rip rap repair	No	Side blow out	1/11/2017	January 2017 quarterly field walkdown	1			
2906	NW corner Pit 5	No	Old hay bales	1/11/2017	January 2017 quarterly field walkdown	14	No action required at this time; abandoned in place	6/21/2017	
2907	30 yards north of Swan Pond	No	Old cages need removed	1/11/2017	January 2017 quarterly field walkdown	15			
2909	Top of knoll on edge of pond (MDC south)	No	Teasel patch	1/11/2017	January 2017 quarterly field walkdown	17	Herbicide applied	6/7/2017	
2911	Mouth of drainage east bank	No	Teasel	1/11/2017	January 2017 quarterly field walkdown	19			
2912	East bank of drainage/side drainage off top of hill	No	Cut through core matting	1/11/2017	January 2017 quarterly field walkdown	20			

No.	Location	GPS?	Maintenance Item Identified	Date Identified	Origin of Finding	Inspection Finding No.	Resolution	Date of Resolution	Comments
2913	Top of bank	No	Teasel	1/11/2017	January 2017 quarterly field walkdown	21			
2914	South bank of Swan Pond	No	Cages and t-posts	1/11/2017	January 2017 quarterly field walkdown	22			
2915	Slope south of pond	No	Thistle	1/11/2017	January 2017 quarterly field walkdown	23			
2916	North of bird blind	No	Thistle	1/11/2017	January 2017 quarterly field walkdown	24			
2917	MDC near A3B	No	Teasel and thistle	1/11/2017	January 2017 quarterly field walkdown	25			
2918	MDC west of OSDF 6	No	Teasel	1/11/2017	January 2017 quarterly field walkdown	26			
2920	East edge of Swan Pond	No	Teasel	1/11/2017	January 2017 quarterly field walkdown	28			
2922	Area not identified on map	No	Large bare area	1/11/2017	January 2017 quarterly field walkdown	30			
2923	East of small basin to the east of Swan Pond	No	Erosion	1/11/2017	January 2017 quarterly field walkdown	31			
2933	Next to Paddys Run on hill	No	Deer cage	1/11/2017	January 2017 quarterly field walkdown	41			
2935	North of Angel Pond	No	Deer cage	1/11/2017	January 2017 quarterly field walkdown	43			
2936	Next to Paddy's Run, top of hill	No	Deer cages	1/11/2017	January 2017 quarterly field walkdown	44			

No.	Location	GPS?	Maintenance Item Identified	Date Identified	Origin of Finding	Inspection Finding No.	Resolution	Date of Resolution	Comments
2939	North of pond	No	T-post	1/11/2017	January 2017 quarterly field walkdown	47			
2940	West side of ridge to the north of Pit 3	No	Teasel and possible poison hemlock	1/11/2017	January 2017 quarterly field walkdown	48			
2941	North of bird blind and over to FPAA6B	No	Heavy teasel	1/11/2017	January 2017 quarterly field walkdown	49			
2942	Near east/west drain	No	Teasel	1/11/2017	January 2017 quarterly field walkdown	50			
2943	North of east/west drain	No	T-posts	1/11/2017	January 2017 quarterly field walkdown	51			
2944	North of wetland area	No	Teasel	1/11/2017	January 2017 quarterly field walkdown	52			
2945	North of former K-65 area, adjacent to Paddys Run	Yes	Asphalt (previous finding)	2/8/2017	February 2017 quarterly field walkdown	1	Free released and disposed	4/19/2017	
2946	North of former K-65 area, adjacent to Paddys Run	Yes	Asphalt	2/8/2017	February 2017 quarterly field walkdown	2	Free released and disposed	4/19/2017	
2948	Pines between road and trail	No	Cages and t-posts in pines	2/8/2017	February 2017 quarterly field walkdown	4	Deer cages and t-posts pulled and removed	4/13/2017	
2949	Edge of pines	No	Deer fence poles	2/8/2017	February 2017 quarterly field walkdown	5			
2953	East side of drain and up the hill	No	Old cages and t-posts	2/8/2017	February 2017 quarterly field walkdown	9			
2954	Between well house 25 and drain	No	Old railroad tie and concrete	2/8/2017	February 2017 quarterly field walkdown	10			

No.	Location	GPS?	Maintenance Item Identified	Date Identified	Origin of Finding	Inspection Finding No.	Resolution	Date of Resolution	Comments
2956	West of concrete wall	Yes	Exposed concrete and erosion	2/8/2017	February 2017 quarterly field walkdown	12			The concrete is from a beneficial reuse of concrete in this area; erosion repair is needed
2958	South of 'dance hall'	No	Broken survey marker	2/8/2017	February 2017 quarterly field walkdown	14			
2959	SSOD, south drain from Willey Rd. just before merge with SSOD	No	Sandbags	2/8/2017	February 2017 quarterly field walkdown	15	Sandbags removed	4/4/2017	
2960	Near salamander habitat	Yes	Rebar	2/8/2017	February 2017 quarterly field walkdown	16	Free released and disposed	4/19/2017	
2961	North side of deer fence	Yes	Deer fence is torn	2/8/2017	February 2017 quarterly field walkdown	17	Deer fence repaired	4/4/2017	
2962	Along trail, both sides	No	Deer cages	2/8/2017	February 2017 quarterly field walkdown	18			
2963	Among the trees at the south edge of the field	No	Deer cages	2/8/2017	February 2017 quarterly field walkdown	19			
2964	Pines west of CAWWT	No	Deer cages	2/8/2017	February 2017 quarterly field walkdown	20			
2965	South of trail	No	Cages	2/8/2017	February 2017 quarterly field walkdown	21			
2966	South of south end of trail	No	Deer cages	2/8/2017	February 2017 quarterly field walkdown	22			
2967	West of 'dance hall'	No	Deer cages	2/8/2017	February 2017 quarterly field walkdown	23			
2968	In drainage	No	Concrete	2/8/2017	February 2017 quarterly field walkdown	24	Free released and disposed	4/19/2017	

No.	Location	GPS?	Maintenance Item Identified	Date Identified	Origin of Finding	Inspection Finding No.	Resolution	Date of Resolution	Comments
2969	Basin edge	Yes	Concrete	3/2/2017	March 2017 quarterly field walkdown	1			
2970	Just inside pines on east side	No	Deer cages	3/2/2017	March 2017 quarterly field walkdown	2			
2971	Edge of pines along southeast corner of deer fence	No	Tree on fence	3/2/2017	March 2017 quarterly field walkdown	3			
2972	South edge of deer fence	No	Hole in fence	3/2/2017	March 2017 quarterly field walkdown	4			
2973	West end of deer fence	No	Hole in fence	3/2/2017	March 2017 quarterly field walkdown	5			
2974	Edge of pond	Yes	Deer cages need to be pulled	3/2/2017	March 2017 quarterly field walkdown	6			
2975	Edge of swale	Yes	OEPA installed rebar	3/2/2017	March 2017 quarterly field walkdown	7			
2976	Basin 6 head wall	Yes	Pears resprouting from stumps	3/2/2017	March 2017 quarterly field walkdown	8	Woody vegetation cut	6/16/2017	
2977	South berm of NPPW5	Yes	Water level 1 foot lower in basin	3/2/2017	March 2017 quarterly field walkdown	9			
2978	Cell 2, west inner drainage	Yes	Cedar	3/2/2017	March 2017 OSDF Inspection	1			
2979	Cell 5, west inner drainage	Yes	Cedar	3/2/2017	March 2017 OSDF Inspection	2	Herbicide applied	6/19/2017	
2980	Cell 6, west inner drainage	Yes	Cedar	3/2/2017	March 2017 OSDF Inspection	3	Herbicide applied	6/19/2017	

No.	Location	GPS?	Maintenance Item Identified	Date Identified	Origin of Finding	Inspection Finding No.	Resolution	Date of Resolution	Comments
2981	Cell 8, west inner drainage	Yes	Cedar	3/2/2017	March 2017 OSDF Inspection	4	Herbicide applied	5/30/2017	
2982	South of VH 7 on both sides of gravel road	No	Heavy teasel area	3/2/2017	March 2017 OSDF Inspection	5			East side of road in the inner drainage and on slope of cap was addressed on May 31, 2017; the west side of the road is scheduled for later in June
2983	Southeast corner of perimeter fence	No	Radiological sign fell off of fence	3/2/2017	March 2017 point-specific institutional controls inspection	NA	Sign replaced	5/31/2017	
2985	Cell 7, top west 6:1 slope	Yes	Debris - glazed tile and concrete	3/29/2017	March 2017 OSDF Inspection	1	Free released and disposed	4/11/2017	This inspection was a walk-down of Cell Caps 7 and 8 following a prescribed burn on March 9, 2017
2986	Cell 8, south face	Yes	Several, 2 flagged	3/29/2017	March 2017 OSDF Inspection	2			This inspection was a walk-down of Cell Caps 7 and 8 following a prescribed burn on March 9, 2017
2987	Cell 8, west toe	No	Matting	3/29/2017	March 2017 OSDF Inspection	3			This inspection was a walk-down of Cell Caps 7 and 8 following a prescribed burn on March 9, 2017
2988	Cell 8, middle of west slope	No	Appears animal was digging for rodents	3/29/2017	March 2017 OSDF Inspection	4			This inspection was a walk-down of Cell Caps 7 and 8 following a prescribed burn on March 9, 2017
2989	Cell 7, middle west slope	No	Teasel patch	3/29/2017	March 2017 OSDF Inspection	5	Herbicide applied	5/31/2017	This inspection was a walk-down of Cell Caps 7 and 8 following a prescribed burn on March 9, 2017
2990	Cell 8, south toe	No	Brick	3/29/2017	March 2017 OSDF Inspection	6	Free released and disposed	4/11/2017	This inspection was a walk-down of Cell Caps 7 and 8 following a prescribed burn on March 9, 2017
2991	Cell 8, east slope	No	Asphalt	3/29/2017	March 2017 OSDF Inspection	7	Free released and disposed	4/11/2017	This inspection was a walk-down of Cell Caps 7 and 8 following a prescribed burn on March 9, 2017
2992	Cell 8, east slope	No	Teasel patch	3/29/2017	March 2017 OSDF Inspection	8	Herbicide applied	5/30/2017	This inspection was a walk-down of Cell Caps 7 and 8 following a prescribed burn on March 9, 2017
2993	Cell 7, east slope	No	Teasel patch	3/29/2017	March 2017 OSDF Inspection	9	Herbicide applied	5/22/2017	This inspection was a walk-down of Cell Caps 7 and 8 following a prescribed burn on March 9, 2017

No.	Location	GPS?	Maintenance Item Identified	Date Identified	Origin of Finding	Inspection Finding No.	Resolution	Date of Resolution	Comments
2994	Cell 7, west side near top	Yes	2 bricks	3/29/2017	March 2017 OSDF Inspection	10	Free released and disposed	4/11/2017	This inspection was a walk-down of Cell Caps 7 and 8 following a prescribed burn on March 9, 2017
2995	Cell 8, south east slope	Yes	2 rocks, flag between them	3/29/2017	March 2017 OSDF Inspection	11			This inspection was a walk-down of Cell Caps 7 and 8 following a prescribed burn on March 9, 2017
2996	Cell 8, top	No	Teasel	3/29/2017	March 2017 OSDF Inspection	12	Herbicide applied	5/30/2017	This inspection was walk-down of Cell Caps 7 and 8 following a prescribed burn on March 9, 2017
2997	Cell 8, top	No	Teasel	3/29/2017	March 2017 OSDF Inspection	13	Herbicide applied	5/30/2017	This inspection was a walk-down of Cell Caps 7 and 8 following a prescribed burn on March 9, 2017
2998	Cell 7, west slope near top	Yes	Animal burrow	3/29/2017	March 2017 OSDF Inspection	14			This inspection was a walk-down of Cell Caps 7 and 8 following a prescribed burn on March 9, 2017
2999	Cell 1, west end of north fenceline	Yes	Radiological control sign fell off fence	6/7/2017	June 2017 OSDF Inspection	1			
3000	Cell 8, gravel roadway along south face	No	The gravel road is developing an erosion rill, washing gravel into south drainage	6/7/2017	June 2017 OSDF Inspection	2			
3001	Cell 7/8 boundary at west toe	No	2 goundhog holes	6/7/2017	June 2017 OSDF Inspection	3	2 animal burrows filled	6/15/2017	
3002	Cell 8, west toe at riprap	No	Erosion at old groundhog hole	6/7/2017	June 2017 OSDF Inspection	4			
3003	Cell 8, west toe	No	Rocks	6/7/2017	June 2017 OSDF Inspection	5			
3004	Cell 8, west toe	Yes	Groundhog hole	6/7/2017	June 2017 OSDF Inspection	6	Animal burrow filled	6/15/2017	
3005	Outer drainage	No	Invasive herbaceous and unwanted woody vegetation	6/7/2017	June 2017 OSDF Inspection	NA			This finding is a summary of numerous findings

No.	Location	GPS?	Maintenance Item Identified	Date Identified	Origin of Finding	Inspection Finding No.	Resolution	Date of Resolution	Comments
3006	West inner drainage	No	Invasive herbaceous and unwanted woody vegetation	6/7/2017	June 2017 OSDF Inspection	NA			This finding is a summary of numerous findings
3007	Toe of OSDF	No	Invasive herbaceous and unwanted woody vegetation	6/7/2017	June 2017 OSDF Inspection	NA			This finding in a summary of numerous findings
3008	Fernald Preserve perimeter signs	No	Several signs are obstructed by vegetation; signs include S7, S9, S11, S14, S17, S19, S45, S48,	6/8/2017	June 2017 point-specific institutional controls inspection	NA	Vegetation was cut back from signs	6/15/2017	The location and need for S49 will be re-evaluated; this sign is not visible from the perimeter even when the immediate area is clear
3009	60" main drainage corridor culvert	No	Grates at both the north and south end of the culvert are almost completely blocked with	6/8/2017	June 2017 point-specific institutional controls inspection	NA	Vegetative debris removed from grates	6/20/2017	
3010	West side of CAWWT fenceline	No	Tree is growing into barbed wire fencing at the top of the chainlink	6/8/2017	June 2017 point-specific institutional controls inspection	NA			
3011	Cell 8, west slope	Yes	Animal burrow	3/29/2017	March 2017 OSDF Inspection	15			
3012	Cell 7, top	No	Teasel	3/29/2017	March 2017 OSDF Inspection	16	Herbicide applied	5/31/2017	
3013	Cell 7, east slope at south end	No	Teasel	3/29/2017	March 2017 OSDF Inspection	17	Herbicide applied	5/22/2017	